

MODEL

DS 9DVF

HITACHI
POWER TOOLS

CORDLESS DRIVER DRILL
DS 9DVF

TECHNICAL DATA
AND
SERVICE MANUAL

F

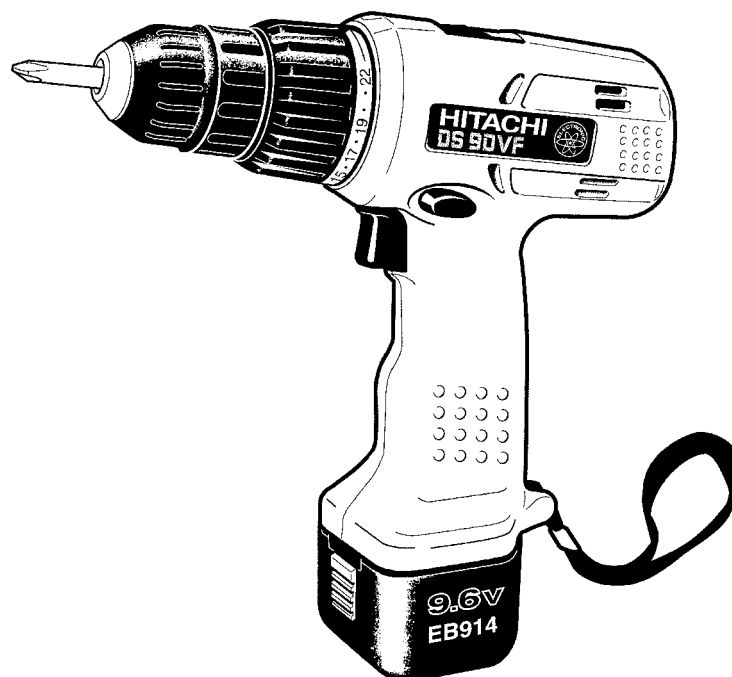

LIST No. F867

Feb. 2002

REMARK:

Throughout this TECHNICAL DATA AND SERVICE MANUAL, a symbol(s) is(are) used in the place of company name(s) and model name(s) of our competitor(s). The symbol(s) utilized here is(are) as follows:

Symbols Utilized	Competitors	
	Company Name	Model Name
C	MAKITA	6226DWE
P	DEWALT	DW926K



CONTENTS

	Page
1. PRODUCT NAME	1
2. MARKETING OBJECTIVE	1
3. APPLICATIONS	1
4. SELLING POINTS	1
4-1. Selling Point Descriptions	2
5. SPECIFICATIONS	3
6. COMPARISONS WITH SIMILAR PRODUCTS	4
7. WORKING PERFORMANCE PER SINGLE CHARGE	5
8. PRECAUTIONS IN SALES PROMOTION	6
8-1. Safety Instructions	6
8-2. Inherent Drawbacks of Cordless Driver Drills Requiring Particular Attention During Sales Promotion	8
9. REFERENCE MATERIALS	9
9-1. Speed Control Mechanism	9
10. REPAIR GUIDE	10
10-1. Precautions in Disassembly and Reassembly	10
10-2. Precautions in Disassembly and Reassembly of Battery Charger	16
11. STANDARD REPAIR TIME (UNIT) SCHEDULES	17
Assembly Diagram for DS 9DVF	18

1. PRODUCT NAME

Hitachi 9.6 V Cordless Driver Drill, Model DS 9DVF

2. MARKETING OBJECTIVE

The Model DS 9DVF is one of the excellent cost/performance driver drill series including the Models DS 12DVF and DS 14DVF released together at the same time. The Model DS 9DVF has been designed to satisfy the market demands for easy-to-operate, well-balanced cost/performance driver drills. The Model DS 9DVF operates on the DC 9.6 V battery and is the most compact and lightweight of all the models in this series. The portable Model DS 9DVF is suitable for light works. A bonus pack including the convenient accessories is also available.

3. APPLICATIONS

- Tightening and loosening wood screws, self-tapping screws and machine screws
- Drilling into wood materials, plastic, mild steel and aluminum

4. SELLING POINTS

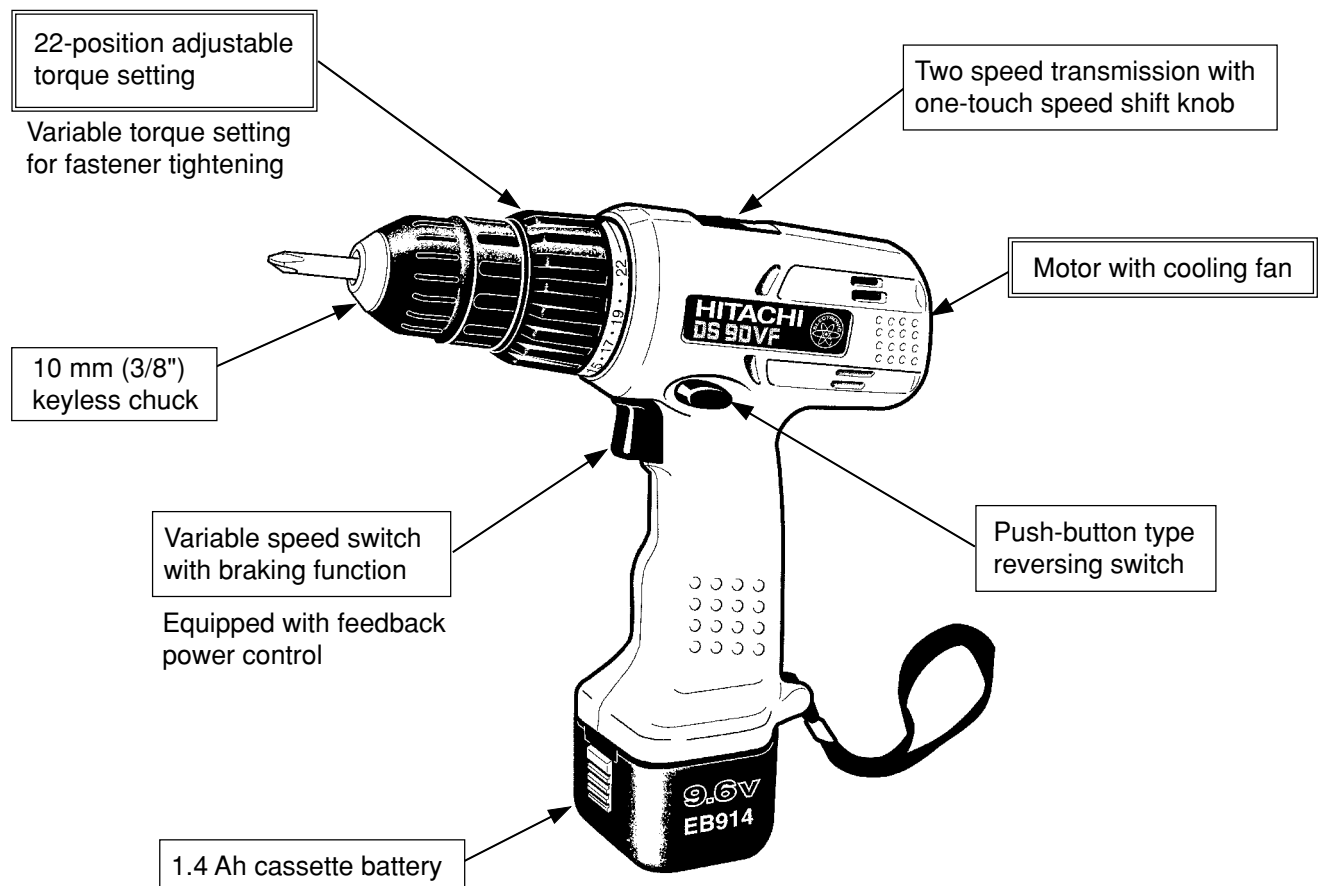

4-1. Selling Point Descriptions

4-1-1. 22-Position Adjustable Torque Setting

The torque can be set finely thanks to the adoption of the 22 clutch positions to improve the operability.

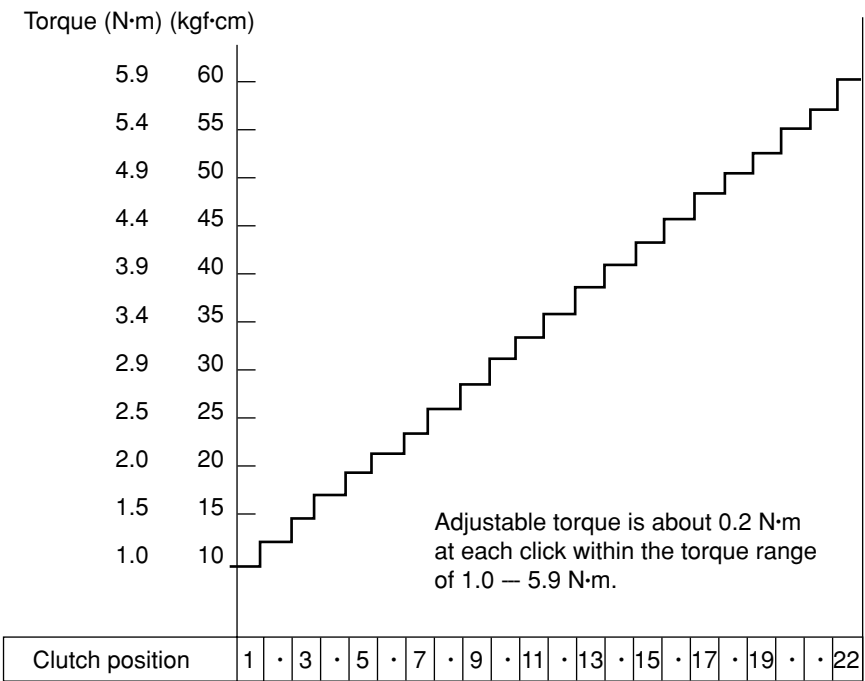

Fig. 1 Clutch torque

4-1-2. Motor with Cooling Fan

The cooling fan incorporated in the motor and the air vents provided in its outer frame greatly enhance the cooling effect, ensuring improved durability in continuous operation.

4-1-3. 10 mm (3/8") Keyless Chuck

The keyless chuck facilitates fast and easy replacement of driver bits. Replacement can be carried out simply by holding the ring with one hand, while turning the sleeve with the other hand.

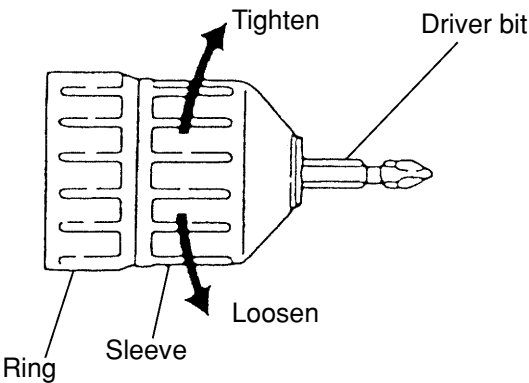

Fig. 2

4-1-4. Variable Speed Switch with Braking Function

The braking function allows the driver unit to stop rotation immediately when the trigger switch is released, which is a convenient feature during actual working. Also, the feedback system ensures a sufficiently large torque even in the variable speed range.

5. SPECIFICATIONS

Capacity		Screwdriver Machine screw 6 mm (1/4") Wood screw 5.5 x 45 mm (#12 x 1-25/32") Drill Metal Mild steel 10 mm (3/8") [thickness 1.6 mm (1/16")] Aluminum 12 mm (15/32") [thickness 1.6 mm (1/16")] Wood 18 mm (23/32") [thickness 18 mm (11/16")]
Keyless chuck (10TLRE-N)		Mount type Screw-on (UNF 3/8" – 24") Diameter 0.8 – 10 mm (1/32" – 3/8")
Rotation speed		0 – 280 /min, 0 – 840 /min
Type of motor		DC magnet motor
Torque		Slip torque 1.0 – 5.9 N·m, 10 – 60 kgf·cm (9 – 52 in-lbs.) [22 stages] Max. torque Low 19 N·m, 194 kgf·cm (168 in-lbs.) High 6.4 N·m, 65 kgf·cm (57 in-lbs.)
Type of switch		Trigger switch with push button for forward and reverse rotation changeover (w/o stopper)
Type of handle		T-type
Enclosure		Body Glassfiber reinforced polycarbonate resin (green) Battery ABS resin (black) Charger ABS resin (black)
Battery (Type EB 914)		Sealed cylindrical nickel cadmium storage battery Nominal voltage DC 9.6 V Nominal life Charging/discharging: approximately 500 times Nominal capacity 1.4 Ah Charging time 60 minutes (with standard accessory charger at ambient temperature of 20 °C) Charging temperature 10 °C – 40 °C (50 °F – 104 °F)
Charger (Model UC 9SD)		<ul style="list-style-type: none"> Overcharge prevention circuit: A thermostat monitors the surface temperature of the battery and, on detecting the temperature rise which occurs on completion of charging, automatically turns off the unit to prevent the battery from overcharge. Input capacity: 30 W Indication method: Pilot lamp indicator of battery charging Function: On During charging Off Charging completed
Weight	Net	Main body unit (including battery) 1.5 kg (3.2 lbs.) Charger unit (including cord) 1.2 kg (2.6 lbs.)
	Gross	DS 9DVF (SSK) 5.0 kg (11.0 lbs.) DS 9DVF (SSK) (3 batteries) 5.6 kg (12.3 lbs.) DS 9DVF (SSX) 5.4 kg (11.9 lbs.)
Standard accessories	DS 9DVF (SSK)	Extra battery 1
		Charger (UC 9SD) 1
		Cross-recessed head (plus) driver bit (No.2) 1
		Case 1
	DS 9DVF (SSK) (3 batteries)	Extra battery 2
		Charger (UC 9SD) 1
		Cross-recessed head (plus) driver bit (No.2) 1
		Bit set 1
		Case 1
	DS 9DVF (SSX)	Extra battery 1
		Charger (UC 9SD) 1
		Torchlight (Flashlight) (UB 12D) 1
		Cross-recessed head (plus) driver bit (No.2) 1
		Bit set 1
		Case 1

6. COMPARISONS WITH SIMILAR PRODUCTS

Catalog specifications

Maker			HITACHI	C	P
Model			DS 9DVF		
Max. capacity	Screw driving	Machine screw	6 mm (1/4")	6 mm (1/4")	Not indicated
		Wood screw	5.5 mm dia. x 45 mm length (#12 x 1-25/32")	5.1 mm dia. x 38 mm length (#11 x 1-1/2")	Not indicated
	Drilling	Mild steel	10 mm (3/8")	10 mm (3/8")	10 mm (3/8")
		Aluminum	12 mm (15/32")	Not indicated	Not indicated
		Wood	18 mm (23/32")	21 mm (13/16")	25 mm (1")
Rotation speed		Low	0 – 280 /min	0 – 350 /min	0 – 300 /min
		High	0 – 840 /min	0 – 1,100 /min	0 – 1,100 /min
Drill chuck		Type	Keyless	Keyless	Keyless
		Capacity	10 mm (3/8")	10 mm (3/8")	10 mm (3/8")
Motor			DC magnet motor	DC magnet motor	DC magnet motor
2-Speed transmission			Gear changeover type 2-speed transmission		
Electric brake			Equipped	Equipped	Equipped
Slip torque			1.0 – 5.9 N·m 10 – 60 kgf·cm (9 – 52 in-lbs.) [22 positions]	Not indicated [16 positions]	Not indicated [15 positions]
Max. torque		Low	19.0 N·m (194 kgf·cm) (168 in-lbs.)	19.0 N·m (194 kgf·cm) (168 in-lbs.)	22.6 N·m (230 kgf·cm) (200 in-lbs.)
		High	6.4 N·m (65 kgf·cm) (57 in-lbs.)	Not indicated	Not indicated
Battery	Nominal capacity		1.4 Ah	1.3 Ah	Not indicated
	Nominal voltage		9.6 V	9.6 V	9.6 V
	Charging time*		60 minutes	60 minutes	60 minutes
Battery mount			Cassette type	Cassette type	Cassette type
Overall length			220 mm (8-21/32")	220 mm (8-21/32")	224 mm (8-13/16")
Weight			1.5 kg (3.2 lbs.)	1.4 kg (3.1 lbs.)	1.54 kg (3.4 lbs.)

Remarks* Charging time varies depending on the type of charger to be used.

7. WORKING PERFORMANCE PER SINGLE CHARGE

Drilling and fastening performance comparison per charge

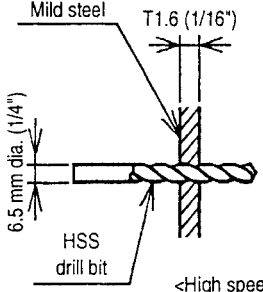
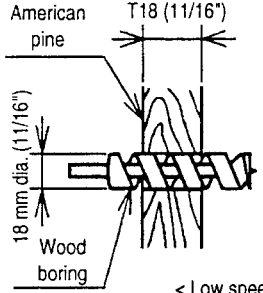
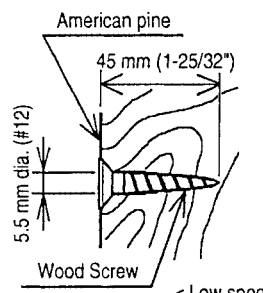
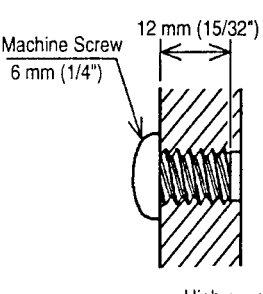
Type of work	Maker	Model name	Working capacity (*1)					Drilling speed (sec./pc.)
			*0 0	*300 50	*600 100	*900 150	*1200 200	
	HITACHI	DS9DVF	52					11.3
	C	—	41					9.1
	P	—	52					7.1
	HITACHI	DS9DVF	120					4.8
	C	—	101					4.7
	P	—	88					5.0
	HITACHI	DS9DVF	78					4.5
	C	—	70					4.1
	P	—	69					4.3
	HITACHI	DS9DVF	* 717					0.79
	C	—	* 650					0.61
	P	—	* 419					0.64

Remarks* Number of machine screws fastened per charge

Remarks*1 Number of holes or fasteners per charge

The above table shows an example of test data obtained using the battery which is standard for this tool.

As actually measured values listed in the above table may vary depending on the sharpness of the drill bit, workpiece hardness (particularly in wood materials), moisture content of wood, charging condition, operator skill, etc. This data should be used as a comparative guide only.

8. PRECAUTIONS IN SALES PROMOTION

8-1. Safety Instructions

In the interest of promoting the safest and most efficient use of the Model DS 9DVF Cordless Driver Drill by all of our customers, it is very important that at the time of sale, the salesperson carefully ensures that the buyer seriously recognizes the importance of the contents of the Handling Instructions, and fully understands the meaning of the precautions listed on the Caution Plate and Name Plate attached to each tool.

A. Handling Instructions

Salespersons must be thoroughly familiar with the contents of the Handling Instructions in order to give pertinent advice to the customer. In particular, they must have a thorough understanding of the precautions for use of the cordless tools which are different from those of ordinary electric power tools.

- (1) Before use, ensure that the unit is fully charged.

New units are not fully charged. Even if the units were fully charged at the factory, long periods of inactivity, such as during shipping, cause the storage battery to lose its charge. Customers must be instructed to fully charge the unit prior to use.

- (2) When charging storage batteries, use only the Model UC 9SD Charger provided with the tool.

Because of the designed rapid-charging feature (about one hour), use of other battery chargers is hazardous.

- (3) Connect the Charger to an AC power outlet only.

Use of any other power source (DC outlet, fuel powered generator, etc.) will cause the Charger to overheat and burn out.

- (4) Do not use any voltage increasing equipment (transformer, etc.) between the power source and the Charger.

If the charger is used with voltage higher than that indicated on the unit, it will not function properly.

- (5) Conduct battery charging at an ambient temperature range of 10 °C – 40 °C (50 °F – 104 °F).

Special temperature sensitive devices are employed in the Charger to permit rapid charging. Ensure that customers are instructed to use the Charger at the indicated ambient temperature range. At temperature under 10 °C (50 °F), the thermostat will not function properly, and the storage battery may be overcharged. At temperature over 40 °C (104 °F), the storage battery cannot be sufficiently charged. The optimum temperature range is 20 °C – 25 °C (68 °F – 77 °F).

- (6) The battery charger should not be used continuously.

At high ambient temperature, if over three storage batteries are charged in succession, the temperature of the coils on the transformer will rise and there is a chance that the temperature fuse inserted in the interior of the transformer will inadvertently melt. After charging one battery, please wait about 15 minutes before charging the next battery.

- (7) Do not insert foreign objects into the air vents on the charger.

The Charger case is equipped with air vents to protect the internal electronic components from overheating. Caution the customer not to allow foreign materials, such as metallic or flammable objects, to be dropped or inserted into the air vents. This could cause electrical shock, fire, or other serious hazards.

- (8) Do not attempt to disassemble the Storage Battery or the Charger.

Special devices, such as a thermostat, are built into the storage battery and charger to permit rapid charging. Incorrect parts replacement and/or wiring will cause malfunctions which could result in fire or other hazards. Instruct the customer to bring these units to an authorized service center in the event repair or replacement is necessary.

- (9) Disposal of the Type EB 914 Storage Battery

Ensure that all customers understand that Type EB 914 Storage Batteries should be turned in to any Hitachi Power Tools sales outlet or authorized service center when they are no longer capable of being recharged or repaired. If thrown into a fire, the batteries may explode, or, if discharged indiscriminately, leakage of the cadmium compound contained in the battery may cause environmental pollution.

B. Caution Plates

- (1) The following cautions are listed on the Name Plate attached to the main body of each tool. Be particularly careful to ensure that the customer understands the necessity of removing the storage batteries prior to bit replacement, cleaning, inspection or carrying of the tool when not in use.

For Asia and Oceania

CAUTION

- Read thoroughly **HANDLING INSTRUCTIONS** before use.

For the U.S.A. and Canada

Warning

- To reduce the risk of injury, user must read and understand Instruction Manual.

AVERTISSEMENT

- Afin de réduire le risque de blessures, l'utilisateur doit lire et bien comprendre le mode d'emploi.

- (2) The following cautions are listed on the Name Plate attached to each Type EB 914 Storage Battery.

For Asia, Europe and Oceania

CAUTION • Read thoroughly **HANDLING INSTRUCTIONS** before use.

- Do not disassemble nor throw into fire.

For the U.S.A. and Canada

CAUTION • For safe operation, see instruction manual. • Use **HITACHI** Charger recommended in instruction manual for recharging.

(3) The following caution is listed on the Name Plates attached to the Model UC 9SD Charger.

For the U.S.A. and Canada

CAUTION •For safe operation, see instruction manual.
•Charge HITACHI rechargeable battery types FEB9S and EB914.
Other types of batteries may burst causing personal injury and damage.
•Charge between 50°F and 104°F. Rest 15 minutes between the charging of batteries.
•Indoor use only. •Replace defective cord immediately.

AVERTISSEMENT •POUR UTILISATION
A L'INTERIEUR SEULEMENT.
ATTENTION •UTILISER POUR
CHARGER UNIQUEMENT LES
ACCUMULATEURS HITACHI DU TYPES
FEB 9S ET EB914. D'AUTRES TYPES
D'ACCUMULATEURS POURRAIENT ECLATER
ET CAUSER DES BLESSURES OU
DOMMAGES.

8-2. Inherent Drawbacks of Cordless Driver Drills Requiring Particular Attention During Sales Promotion

The cordless driver drill offers many advantages; it can be used in places where no power source is available, the absence of a cord allows easy use, etc. However, any cordless tool has certain inherent drawbacks.

Salespersons must be thoroughly familiar with these drawbacks in order to properly advise the customer in the most efficient use of the tool.

A. Suggestions and precautions for the efficient use of the tool

(1) Use the cordless driver drill for comparatively light work.

Because they are battery driven, the output of the motor in cordless driver drills is rather low in comparison with conventional electric power tools. Accordingly, they are not suitable for continuous drilling of many holes in succession, or for drilling into particularly hard materials which creates a heavy load. Salespersons should recommend conventional electric power tools for such heavy work.

(2) Drilling of large diameter holes should be conducted at low speed.

Instruct the customer that drilling of large diameter holes or other work which requires particularly strong torque should be done at low speed. Because there is less torque at high speed, attempting such work at high speed will not improve working efficiency.

(3) Do not insert a foreign object into body vent holes.

The body on this tool has vent holes for improving the cooling efficiency. As a fan is built into the motor, a foreign object inserted through a vent hole may cause a failure. Please instruct customers to never insert a foreign object into the vent hole.

(4) Avoid "Locking" of the motor.

Locking of the motor will cause an overload current that could result in burning of the motor and/or rapid deterioration of the battery. Salespersons should advise the customer to immediately release the switch and stop operation if the motor becomes locked. (A jammed drill bit can be disengaged from the workpiece material by setting the switch to reverse rotation, or by manually turning the main body of the tool.)

(5) Variation in amount of work possible per charge

Although the nominal chargeable capacity of the storage batteries used with the Model DS 9DVF is 1.4 Ah, the actual capacity may vary within 10% of that value depending on the ambient temperature during use and charging, and the number of times the batteries have been recharged. It should be noted that other factors which may have a bearing on the amount of work possible per charge are the working conditions (ambient temperature, type and moisture content of the workpiece, sharpness of the drill bit, etc.) and the operational skill of the user.

(6) Precautions in the use of HSS drill bits

Although the Model DS 9DVF is designed for drilling capacities of 18 mm (23/32") in wood, and 12 mm (15/32") in aluminum, and 10 mm (3/8") in mild steel, this capability is not as efficient as conventional electric power tools. In particular, when drilling through aluminum material with a 12 mm (15/32") drill bit, the drill tends to become locked when the drill bit penetrates through the material. For this reason, the customer should be cautioned to reduce thrust on the main body of the drill when drilling completely through the material to avoid locking the tool. Repeated locking of the drill causes excessive current flow from the batteries which not only decreases the amount of work possible per charge, but could also result in burning of the motor.

B. Suggestions and precautions for the efficient use of the charger and storage batteries

If the Type EB 914 storage batteries are exposed to direct sunlight for an extended period or if the tool has just been operated for a long time, charging may not be possible if the temperature of a battery (type EB 914) is above 40 °C (104 °F). In such a case, the customer should be advised to place the battery in a shaded area with a good airflow, and allow sufficient cooling before recharging. This phenomenon is common to all existing batteries and chargers which employ temperature sensitive overcharge protection devices. The cooling time required before recharging can be accomplished varies from a few minutes to about 30 minutes, depending on the load, duration of use, and ambient temperature.

9. REFERENCE MATERIALS

9-1. Speed Control Mechanism

Spindle rotation speed of the Model DS 9DVF can be controlled by simply varying the amount by which the trigger switch is depressed. The relationship between the amount the trigger switch is depressed (in millimeters) and the rotation speed is illustrated in Fig. 3.

Note: The gradient and values illustrated in Fig. 3 are intended for reference only, and will vary slightly due to differences in the discharge condition of the battery, the ambient temperature, and individual speed-control element accuracy.

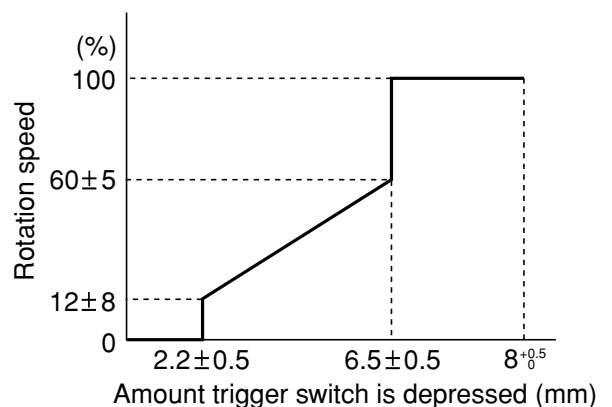

Fig. 3

10. REPAIR GUIDE

Be sure to remove the storage batteries from the main body before servicing. Inadvertent triggering of the switch with the storage battery connected will result in the danger of accidental turning of the motor.

10-1. Precautions in Disassembly and Reassembly

The **[Bold]** numbers in the description below correspond to the item numbers in the Parts List and exploded assembly diagram for the Model DS 9DVF.

10-1-1. Disassembly

(1) Removal of Housing (A). (B) Set **[32]**

Remove the seven Tapping Screws (W/Washers) D3 x 16 **[27]** secured to the main body. Gently open Housing (A) and (B) while holding their battery loading sections.

(2) After Housing (B) has been removed, all the internal parts, assembled or separate, can be taken out as they are. Lift the entire contents from Housing (A) while holding the Motor **[26]** and the Cap **[4]**.

(3) Removal of the Drill Chuck 10TLRD-N (W/O Chuck Wrench) **[2]** (See Fig. 4.)

(a) Turn the Motor **[26]** counterclockwise (when viewed from the rear) and remove it from the Rear Case **[15]**. Remove the Shift Knob **[37]** from the Shift Arm **[17]**. Take care not to remove the Shift Arm **[17]** from the Rear Case **[15]** in this operation.

(b) Attach the motor spacer (an accessory of the special repair tool J-292, Code No. 316379) to the assembly of the Drill Chuck 10TLRD-N (W/O Chuck Wrench) **[2]**, Cap **[4]**, Front Case **[9]** and Rear Case **[15]** and then mount it in special repair tool J-292 clamped in the vise as illustrated in Fig. 4. In this operation, check that the pinion press-fitted in the special repair tool J-292 and Planet Gear (A) Set **[22]** are engaged properly.

(c) Turn the Cap **[4]** clockwise (when viewed from the front) until it can turn no further. In this position, the drill mark " " on the Cap **[4]** is positioned on the Shift Arm **[17]** side. Secure the Slide Ring Gear **[18]** to the Front Case **[9]** side with the Shift Arm **[17]**.

(d) Turn the sleeve of the Drill Chuck 10TLRD-N (W/O Chuck Wrench) **[2]** counterclockwise (when viewed from the front) to fully open the jaws of the Drill Chuck 10TLRD-N (W/O Chuck Wrench) **[2]**. Turn the Special Screw (Left Hand) M5 x 35 **[1]** clockwise and remove it. (Note that the Special Screw is left-hand threaded.)

(e) Fit the hexagonal bar wrench M10 into the Drill Chuck 10TLRD-N (W/O Chuck Wrench) **[2]** as illustrated in Fig. 4 and remove the Drill Chuck 10TLRD-N (W/O Chuck Wrench) **[2]** by turning the hexagonal bar wrench counterclockwise.

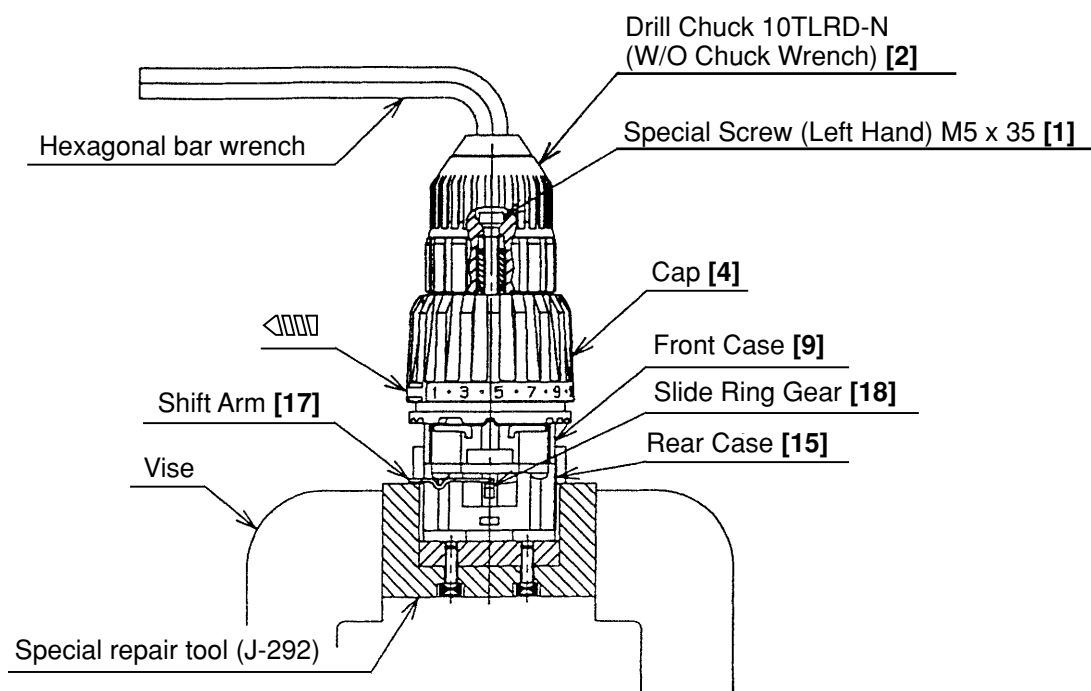

Fig. 4

(4) Disassembly of the gear unit

Remove the Shift Arm [17] from the Rear Case [15], then remove the four Screws Set D3 x 12 [16] connecting the Front Case [9] and the Rear Case [15]. Remove Washer (A) [14], Planet Gear (C) Set [13], Ring Gear [12], six Steel Balls D5 [11] and the six Rollers [10] from the Front Case [9] in order. Take care not to lose the six Steel Balls D5 [11] and the six Rollers [10] in this operation.

(5) Removal of the Spring [6] and Washer (D) [7]

Turn the Nut [5] counterclockwise and remove it from the Front Case [9], then remove the Spring [6] and Washer (D) [7] from the Front Case [9].

(Note) Do not remove the Front Case [9].

(6) Disassembly of the power supply unit

(Note) Do not remove the fin secured to the DC-Speed Control Switch [35] with a screw.

Remove the two Machine Screws M3 x 8 [30], and take the Motor [26] and the Motor Spacer [25] apart.

Disconnect the Internal Wires (B) [33] [34] from the Motor [26] with a soldering iron, then disconnect them from the DC-Speed Control Switch [35] with a soldering iron in the same manner.

10-1-2. Reassembly

Reassembly can generally be carried out as the reverse of the disassembly procedure, with some items to be noted as follows.

(1) Reassembly of the power supply unit

(a) Be sure to perform wiring connections as indicated in the wiring diagram. (See Fig. 5.)

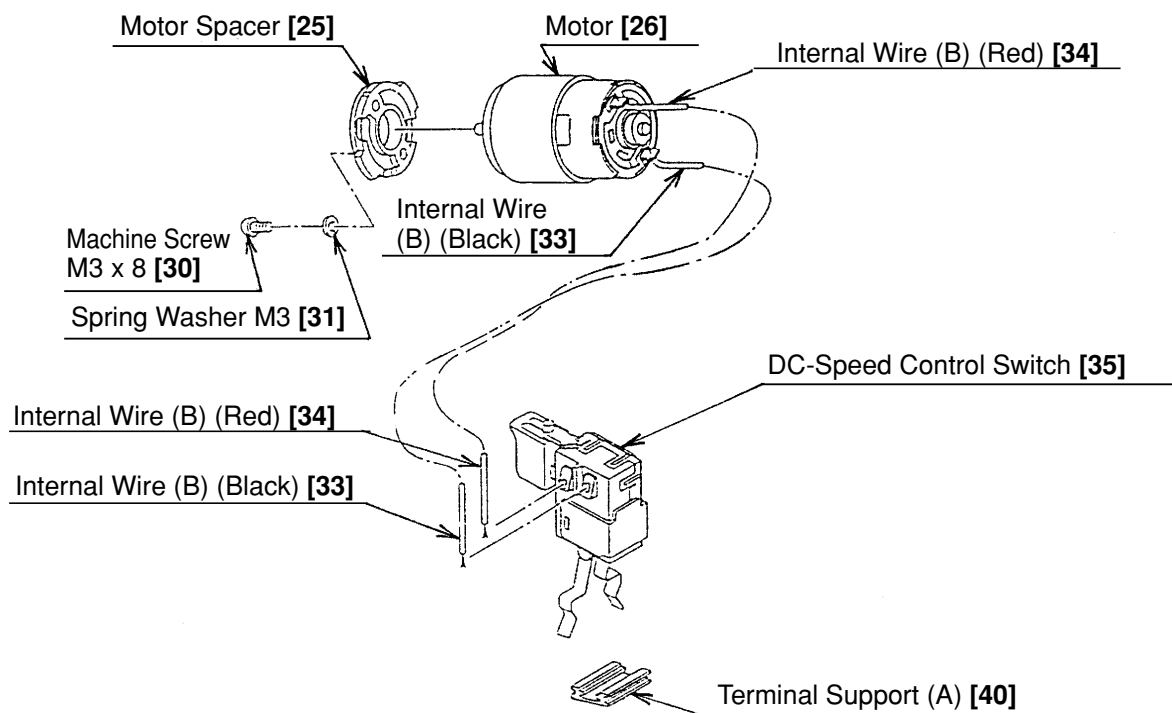

Fig. 5

- (b) Pay attention to the polarity of the Motor [26] when soldering Internal Wires (B) [33] and [34] to the Motor [26]. The red-marked side of the Motor [26] is positive. (See Fig. 6.)
- (c) Apply grease (Hitachi Motor Grease No. 29, Code No. 930035 is recommended) to the pinion press-fitted on the Motor [26] shaft.

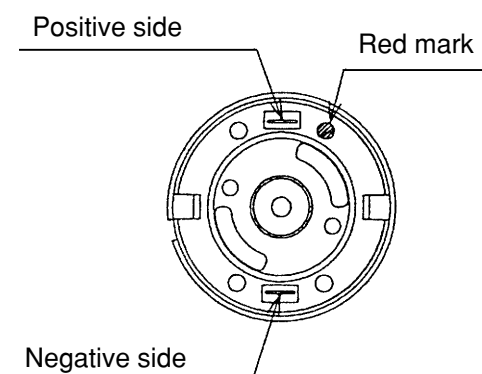

Fig. 6

(2) Reassembly of the clutch unit

- (a) Mount Washer (D) [7] and the Spring [6] to the Front Case [9]. (See Fig. 7.)

When mounting Washer (D) [7] into the Front Case [9], align the projection on the Front Case [9] with the notch of Washer (D) [7].

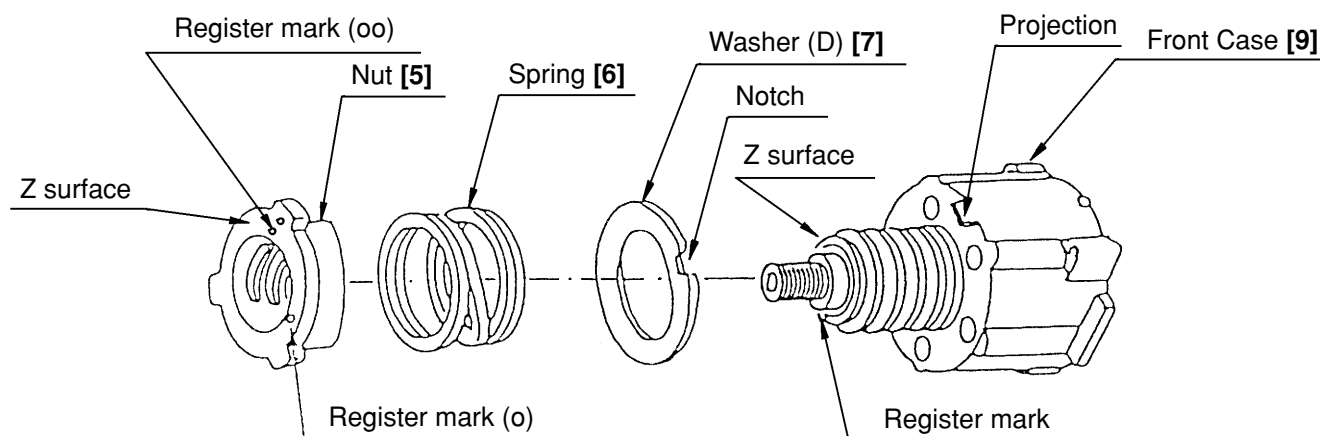

Fig. 7

(b) Mount the Nut [5] to the Front Case [9]. (See Fig. 8.)

Align the register mark (o) on the Nut [5] with the register mark on the Front Case [9]. Turn the Nut [5] about 1-1/4 turns clockwise so that the register mark (oo) on the Nut [5] is aligned with the register mark on the Front Case [9]. Check that the Z surface of the Nut [5] is aligned with the Z surface of the Front Case [9].

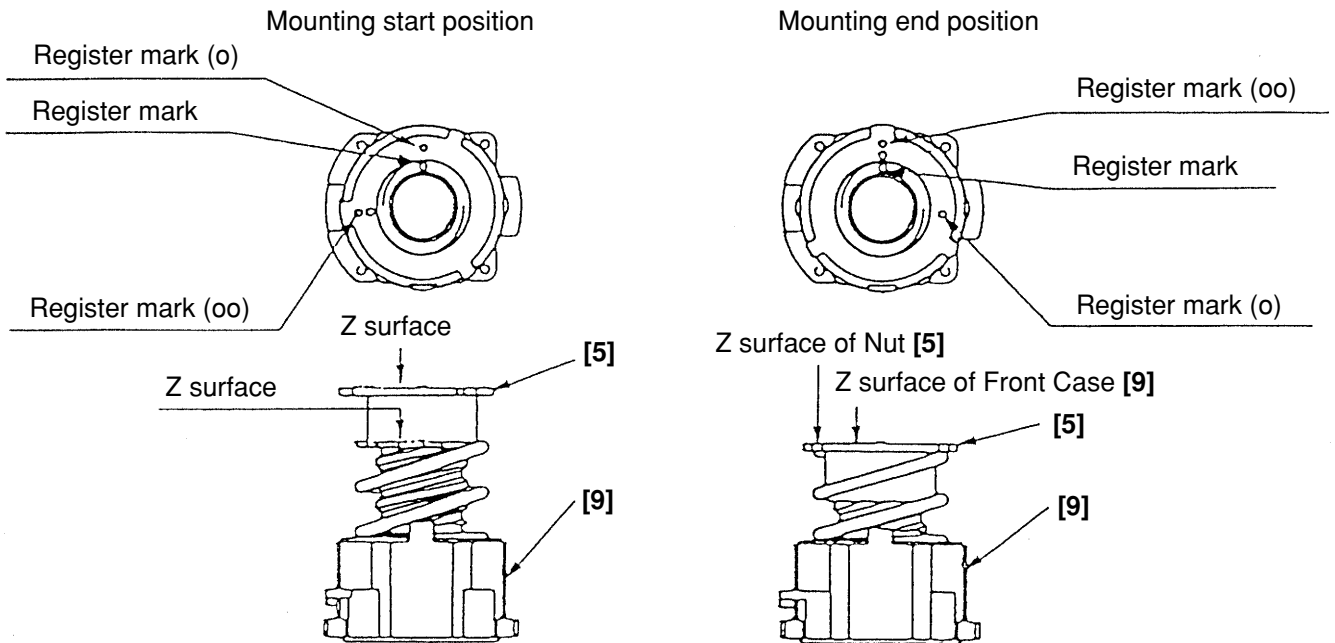

Fig. 8

(3) Reassembly of the gear unit

(a) Apply grease (Hitachi Motor Grease No. 29, Code No. 930035) to the meshing parts of the gear.

(b) Install the parts series from the six Rollers [10] to Washer (B) [24] into the assembly reassembled in step (2). (See Fig. 9.)

- (i) Note the direction of the groove when installing the Slide Ring Gear [18] so that the groove faces toward the Motor [26].
- (ii) Install the Front Case [9] and the Rear Case [15] together with the mark on the Front Case [9] aligned with the mark on the Rear Case [15]. (See Fig. 12.)

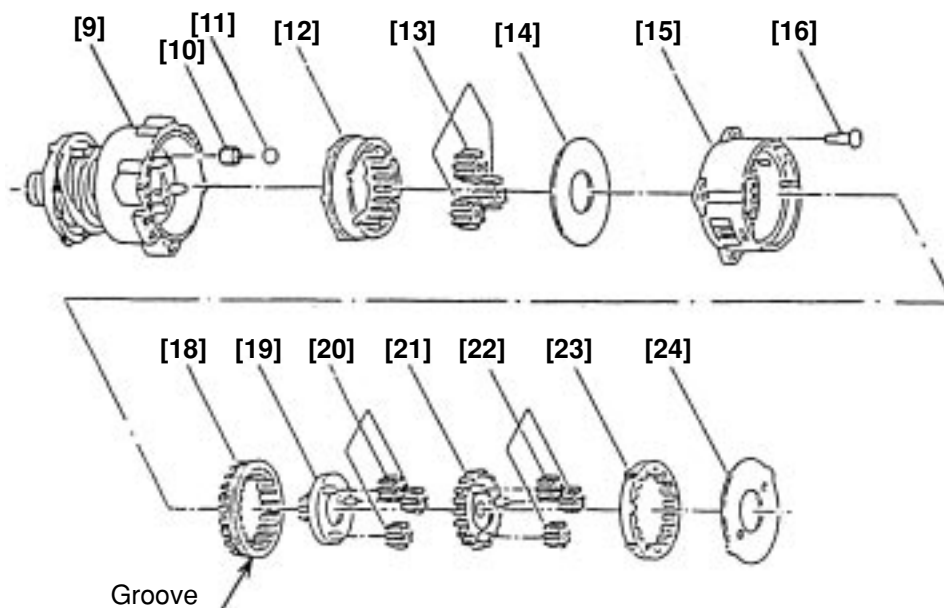

Fig. 9

- (iii) Install Washer (B) [24] in the Rear Case [15] with the projections of Washer (B) [24] engaged with the recesses in the Rear Case [15], and turn Washer (B) [24] clockwise until it can turn no further. (See Fig. 10.)

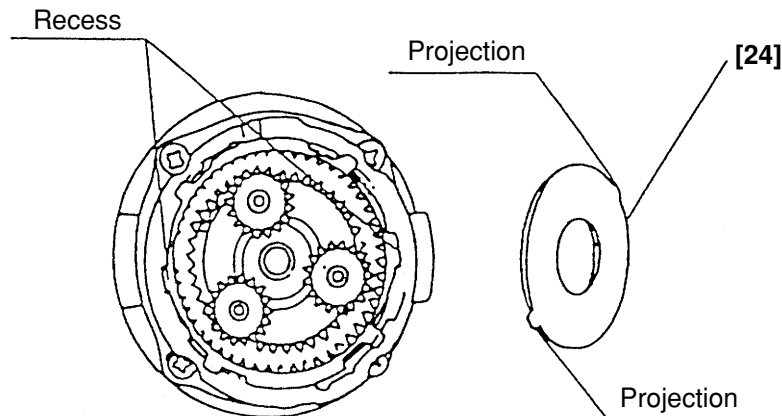

Fig. 10

- (c) Install the Click Spring [8] and the Cap [4] on the assembly reassembled in step (b). (See Fig. 11.)

- (i) Insert the projection of the Click Spring [8] into the hole of the Front Case [9].
- (ii) Mount the Cap [4].

Mount the Nut [5] into the Cap [4] engaging the wider projection of the Nut [5] with the wider recess of the Cap [4]. (The wider recess of the Cap [4] is positioned at "1" when viewed from the outside.)

- (iii) Apply grease (Hitachi Motor Grease No. 29, Code No. 930035) to the sliding surfaces of the Cap [4] and the Click Spring [8].

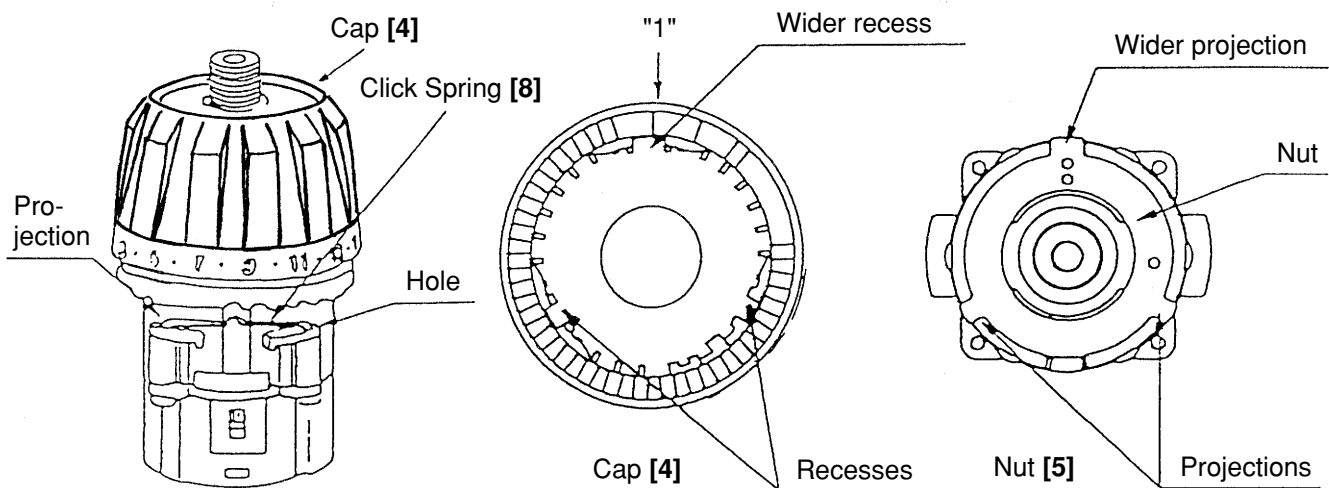

Fig. 11

- (d) Install the Shift Arm [17] into the assembly reassembled in step (c).

With the ridge at the Shift Arm [17] facing the Motor [26] side, first install them on the unmarked side of the assembly reassembled in step (c). Then insert the projections on the Shift Arm [17] into the holes in the Rear Case [15] and make sure that the projections are fitted into the grooves in the Slide Ring Gear [18] mounted within the Rear Case [15]. (See Fig. 12.)

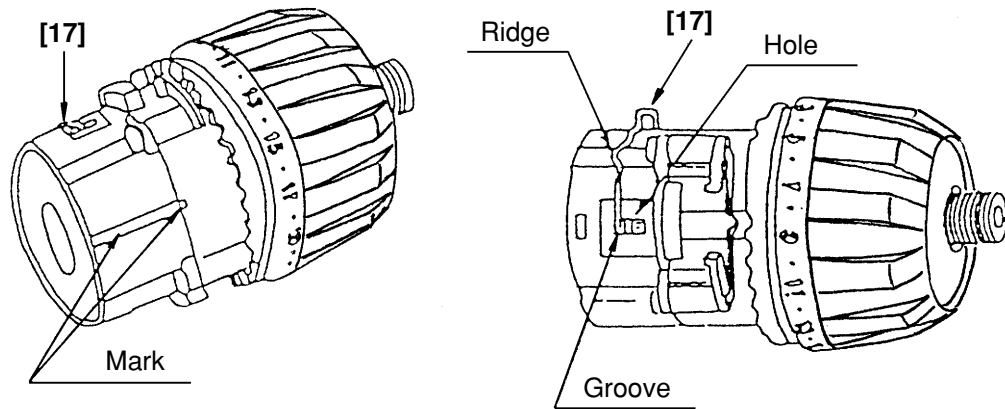

Fig. 12

- (e) Install the Drill Chuck 10TLRD-N (W/O Chuck Wrench) **[2]**.

Install the Drill Chuck 10TLRD-N (W/O Chuck Wrench) **[2]** using the special repair tool (J-292, Code No. 316379) and secure it with the Special Screw (Left Hand) M5 x 35 **[1]**.

- (f) Install the Shift Knob **[37]** into the assembly reassembled in step (e).

When installing the Shift Knob **[37]** into the Shift Arm **[17]**, note that the "LOW" mark on the Shift Knob **[37]** faces the Motor **[26]** with the Shift Arm **[17]** engaged with the recess in the Shift Knob **[37]**.

- (g) Install the assembly reassembled in step (1) and the assembly reassembled in step (f) together. (See Fig. 13.)

Fit the projection on the Motor Spacer **[25]** into the recess in the Rear Case **[15]** while ensuring that the Shift Knob **[37]** is aligned with the positive side of the Motor **[26]** and turn the Motor Spacer **[25]** clockwise when viewed from the rear of the Motor **[26]** until it can turn no further. During installation, make sure that the pinion press-fitted onto the shaft of the Motor **[26]** and Planet Gear (A) Set **[22]** mesh properly.

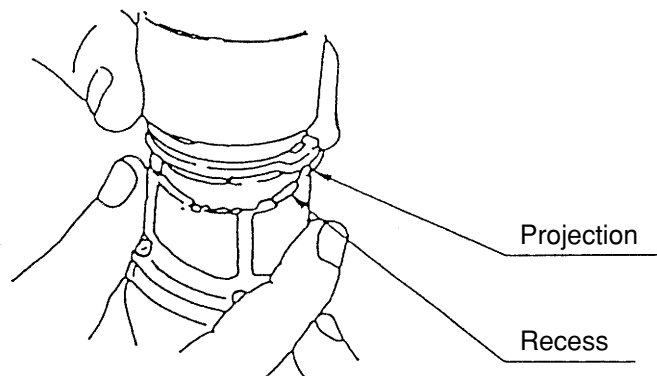

Fig. 13

- (4) Installation of the Bit Holder **[29]** into Housing (A). (B) Set **[32]**

Fit the upper and lower projections of the Bit Holder **[29]** in the grooves in Housing (A). (B) Set **[32]**.

- (5) Installation of the assembly reassembled in step (3) into Housing (A). (B) Set **[32]**

- (a) Install the Pushing Button **[36]** into Housing (A). (B) Set **[32]**. (See Fig. 14.)

- (b) Install the assembly reassembled in step (3) into Housing (A). (B) Set **[32]**. Note that the projections on the Front Case **[9]** and the Motor Spacer **[25]** are engaged in the recesses in Housing (A). (B) Set **[32]**, and the projection on Housing (A). (B) Set **[32]** is engaged in the groove of the Cap **[4]**. (See Fig. 15.)

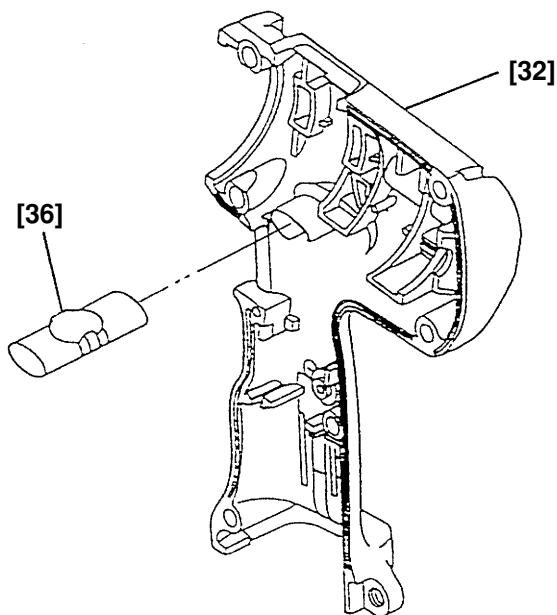

Fig. 14

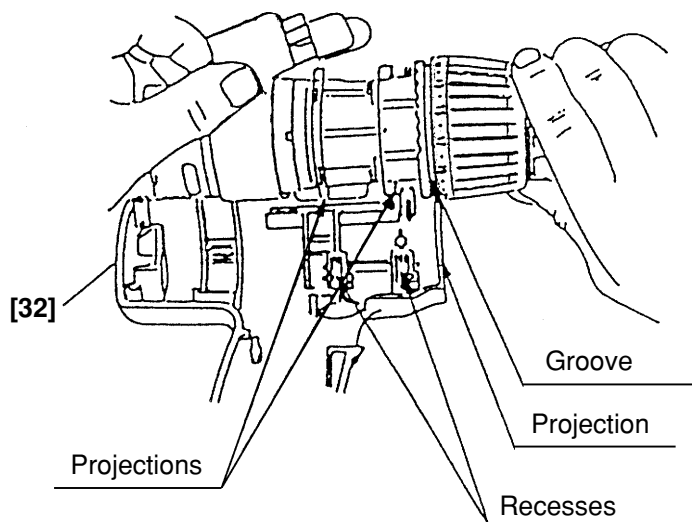

Fig. 15

(c) Set the assembly reassembled in step (b) to Housing (A). (B) Set [32] and secure it with the seven Tapping Screws (W/Washer) D3 x 16 [27].

(d) Verify proper operation of the Cap [4].

When the assembly procedure up to step (c) is completed, ensure that the number "1" on the Cap [4] and the drill mark "◁" are in alignment with the triangle mark on Housing (A). (B) Set [32]. If the Cap [4] turns loosely, correctly re-install the Click Spring [8] as it is improperly installed. If the number "1" on the Cap [4] or the drill mark "◁" cannot reach the triangle mark on Housing (A). (B) Set [32], correctly re-install the Cap [4] referring to step (3) (c), as it is improperly installed.

(6) Other precautions in reassembly

(a) When the assembly procedure is completed, make sure that the turning direction of the Drill Chuck 10TLRD-N (W/O Chuck Wrench) [2] corresponds to the position of the Pushing Button [36]. When the Pushing Button [36] is pressed from the (R)-marked side, the Drill Chuck 10TLRD-N (W/O Chuck Wrench) [2] should turn clockwise when viewed from the rear (opposite side of the Drill Chuck 10TLRD-N (W/O Chuck Wrench) [2]). Also make sure that the turning speed of the Drill Chuck 10TLRD-N (W/O Chuck Wrench) [2] switches between "HIGH" and "LOW" by switching over the Shift Knob [37]. Make sure that the run-out of the Drill Chuck 10TLRD-N (W/O Chuck Wrench) [2] holding a 9 mm dia. test bar is below 0.8 mm at a distance of 85 mm from the chuck end.

(b) The tightening torque of each screw is given below.

Special Screw (Left Hand) M5 x 35 [1]	: 2.9 — 3.9 N·m (30 — 40 kgf·cm, 26.1 — 34.8 in-lbs.)
Drill Chuck 10TLRD-N (W/O Chuck Wrench) [2]	: 12.7 — 16.7 N·m (130 — 170 kgf·cm, 113 — 148 in-lbs.)
Screw Set D3 x 12 [16]	: 0.6 — 1.0 N·m (6 — 10 kgf·cm, 5.2 — 8.7 in-lbs.)
Machine Screw M3 x 8 [30]	: 0.6 — 0.9 N·m (6.5 — 9.5 kgf·cm, 5.6 — 8.3 in-lbs.)
Tapping Screw (W/Washer) D3 x 16 [27]	: 1.1 — 1.9 N·m (11 — 19 kgf·cm, 9.5 — 16.5 in-lbs.)

10-2. Precautions in Disassembly and Reassembly of Battery Charger

Please refer to the Technical Data and Service Manual for precautions in disassembly and reassembly of the Battery Charger UC 9SD.

11. STANDARD REPAIR TIME (UNIT) SCHEDULES

MODEL	Variable		10	20	30	40	50	60
	Fixed							
DS 9DVF		Work Flow						
	General Assembly	Spring Drill Chuck 10TLRD-N (W/O Chuck Wrench)		Housing (A).(B) Set Motor Cap DC-Speed Control Switch Nut Shift Arm				
				(Gear Box Ass'y) Front Case Ring Gear First Ring Gear Planet Gear (A) Set Pinion (B) Planet Gear (B) Set Pinion (C) Slide Ring Gear Planet Gear (C) Set Rear Case				

ELECTRIC TOOL PARTS LIST

■ CORDLESS DRIVER DRILL
Model DS 9DVF

2002 · 2 · 20
(E1)

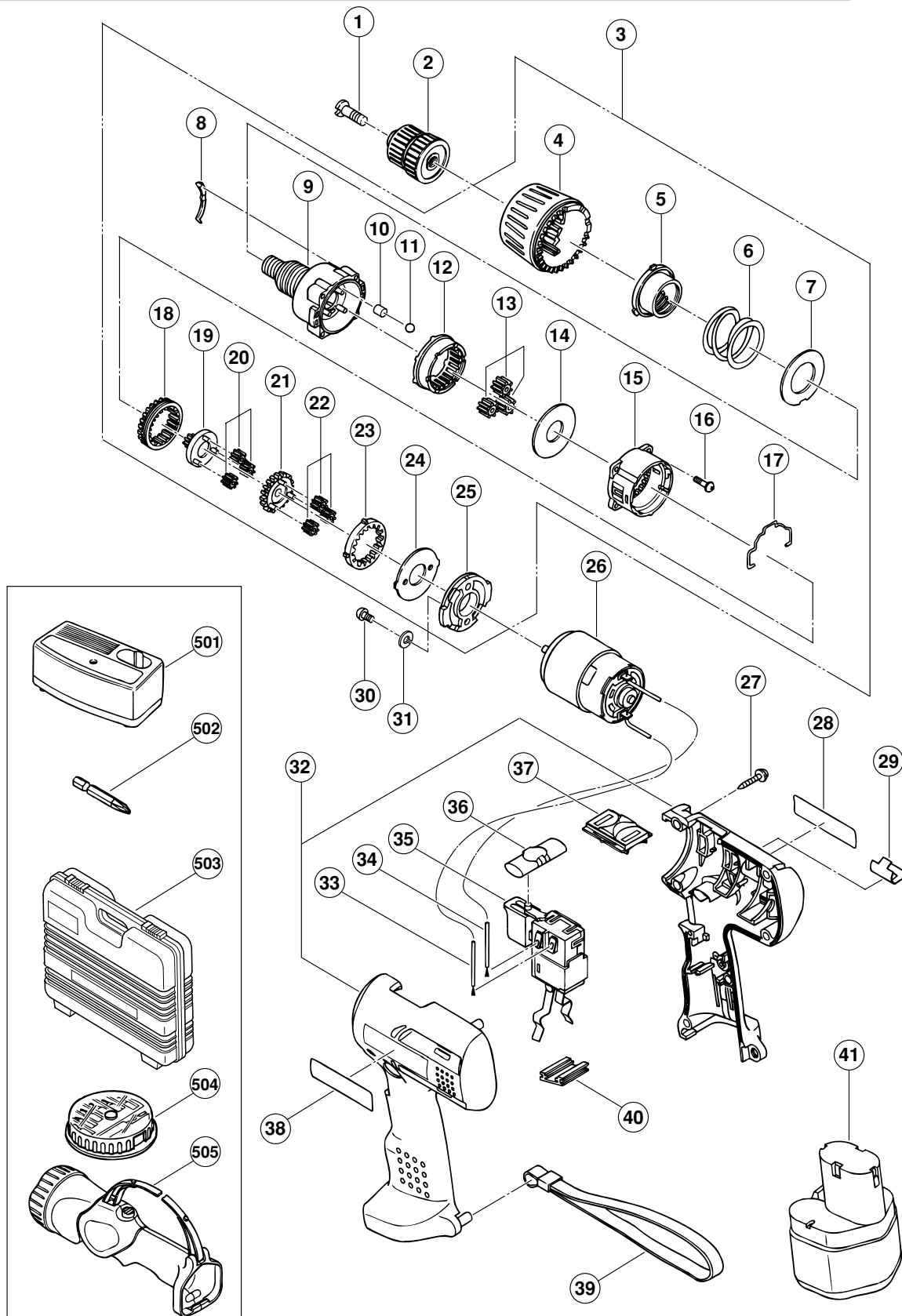

PARTS

DS 9DVF

ITEM NO.	CODE NO.	DESCRIPTION	NO. USED	REMARKS	
1	318-228	SPECIAL SCREW (LEFT HAND) M5X35	1		
2	312-516	DRILL CHUCK 10TLRD-N (W/O CHUCK WRENCH)	1		
3	320-660	GEAR BOX ASS'Y	1	INCLUD.4-25	
4	320-661	CAP	1		
5	318-232	NUT	1		
6	312-709	SPRING	1		
7	312-714	WASHER (D)	1		
8	312-713	CLICK SPRING	1		
9	318-230	FRONT CASE	1		
10	319-744	ROLLER	6		
11	306-936	STEEL BALL D5	6		
12	312-715	RING GEAR	1		
13	312-705	PLANET GEAR (C) SET (3 PCS.)	1		
14	312-704	WASHER (A)	1		
15	312-697	REAR CASE	1		
16	315-817	SCREW SET D3X12 (6 PCS.)	1		
17	311-962	SHIFT ARM	1		
18	315-137	SLIDE RING GEAR	1		
19	315-805	PINION (C)	1		
20	315-816	PLANET GEAR (B) SET (3 PCS.)	1		
21	315-804	PINION (B)	1		
22	315-815	PLANET GEAR (A) SET (3 PCS.)	1		
23	315-136	FIRST RING GEAR	1		
24	312-716	WASHER (B)	1		
25	318-231	MOTOR SPACER	1		
26	318-244	MOTOR	1		
27	991-672	TAPPING SCREW (W/WASHER) D3X16	7		
28		NAME PLATE	1		
29	318-237	BIT HOLDER	1		
30	949-203	MACHINE SCREW M3X8 (10 PCS.)	2		
31	949-451	SPRING WASHER M3 (10 PCS.)	2		
32	320-662	HOUSING (A).(B) SET	1		
33	306-041	INTERNAL WIRE (B) (BLACK)	1		
34	306-040	INTERNAL WIRE (B) (RED)	1		
35	318-245	DC-SPEED CONTROL SWITCH	1		
36	319-760	PUSHING BUTTON	1		
37	318-234	SHIFT KNOB	1		
38		HITACHI LABEL	1		
39	306-952	STRAP (BLACK)	1		
40	315-141	TERMINAL SUPPORT (A)	1		
*	41	320-605	BATTERY EB 914 (W/ENGLISH N.P.)	1	
*	41	320-603	BATTERY EB 914 (W/ENGLISH N.P.)	1	FOR NZL,KOR
*	41	320-604	BATTERY EB 914 (W/ENGLISH N.P.)	1	FOR USA,CAN

STANDARD ACCESSORIES

DS 9DVF

[illegible]

* ALTERNATIVE PARTS

2 - 02

