

MODELS

WH 12DAF2

WR 12DAF2

Hitachi **Power Tools**

**CORDLESS IMPACT DRIVER
WH 12DAF2
CORDLESS IMPACT WRENCH
WR 12DAF2**

**TECHNICAL DATA
AND
SERVICE MANUAL**

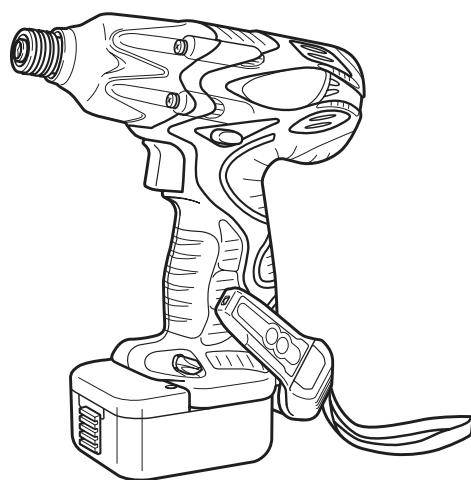

WH 12DAF2

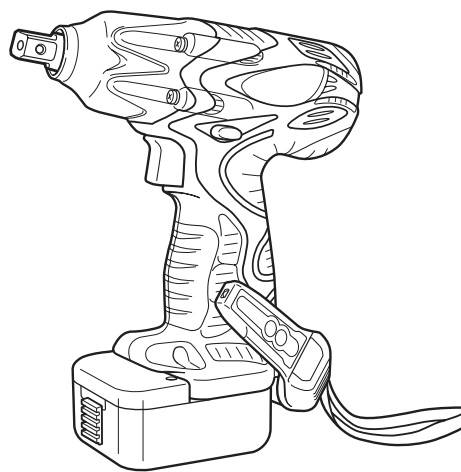

WR 12DAF2

LIST Nos. WH 12DAF2: G836
WR 12DAF2: G837

August 2005

REMARK:

Throughout this TECHNICAL DATA AND SERVICE MANUAL, a symbol(s) is(are) used in the place of company name(s) and model name(s) of our competitor(s). The symbol(s) utilized here is(are) as follows:

WH 12DAF2

Symbol Utilized	Competitor	
	Company Name	Model Name
P	DeWALT	DW052

WR 12DAF2

Symbol Utilized	Competitor	
	Company Name	Model Name
P1	DeWALT	DW053

CONTENTS



Page

1. PRODUCT NAME	1
2. MARKETING OBJECTIVE	1
3. APPLICATIONS	1
4. STANDARD EQUIPMENT	1
5. SELLING POINTS	2
5-1. Selling Point Descriptions	4
6. SPECIFICATIONS	6
6-1. Specifications	6
6-2. Optional Accessories	7
7. COMPARISONS WITH SIMILAR PRODUCTS	11
7-1. Specification Comparisons	11
7-2. Tightening Torque	13
7-3. Number of Screws or Bolts Driven	15
8. PRECAUTIONS IN SALES PROMOTION	16
8-1. Safety Instructions	16
8-2. Tightening Torque Inspection Prior to Operation	18
8-3. Tightening Torque Variation	18
8-4. Suggestions and Precautions for the Efficient Use of the Charger	20
9. OTHER PRECAUTIONS	20
10. REPAIR GUIDE	21
10-1. Precautions in Disassembly and Reassembly	21
10-2. Precautions in Disassembly and Reassembly of Battery Charger	27
11. STANDARD REPAIR TIME (UNIT) SCHEDULES	28
For Model WH 12DAF2	28
For Model WR 12DAF2	29
Assembly Diagram for WH 12DAF2	
Assembly Diagram for WR 12DAF2	

1. PRODUCT NAME

Hitachi Cordless Impact Driver, Model WH 12DAF2

Hitachi Cordless Impact Wrench, Model WR 12DAF2

2. MARKETING OBJECTIVE

The new Models WH 12DAF2 and WR 12DAF2 are the upgraded versions of the well-reputed Models WH 12DAF and WR 12DAF. They incorporate many features including the following with the comparable price.

- ① Increased maximum tightening torque
- ② Increased battery capacity (standard accessory)
- ③ Convenient belt hook with LED job light
- ④ Bit holder
- ⑤ Powerful new design

With the introduction of the new Models WH 12DAF2 and WR 12DAF2, we aim to increase our market share and sales.

3. APPLICATIONS

- Tightening/loosening of small screws, tapping screws, wood screws, bolts, nuts, etc.
- Drilling into wood and various other materials (with use of optional accessory drill chuck adapter).

[Applicable Markets]

- Wood-product assembly: Tightening/loosening of wood screws
- Construction industry: Assembly of scaffolding, roofing, aluminum sashes, fencing, etc.; removal of plastic cones from concrete forms, mounting/removal of form ties; drilling into the wood frames of concrete forms, etc.
- Manufacturing industry: Assembly work for automobiles, rolling stock, shipbuilding, agricultural machinery and tools, industrial machines, steel furniture, etc.
- Utility industry: Assembly and installation of electric equipment, plumbing facilities, air conditioning (duct assembly, etc.), sanitary fixtures and various other facilities
- Service industry: General repair work; installation of advertising aids, automobile repair, assembly of garages and carports storage sheds, etc.
- Various other assembly, construction or repair facilities

4. STANDARD EQUIPMENT

- (1) NN specification: Without battery, charger and case (only main body)
- (2) 2SGK specification: Two EB 1214S batteries (NiCd, capacity 1.4 Ah), UC 18YG charger and case
- (3) SGK specification: One EB 1214S battery (NiCd, capacity 1.4 Ah), UC 18YG charger and case
- (4) 2SGKX specification: Two EB 1214S batteries (NiCd, capacity 1.4 Ah), UC 18YG charger, case and UB 12D torchlight
- (5) 2BLGK specification: Two EB 1220BL batteries (NiCd, capacity 2.0 Ah), UC 18YG charger and case
- (6) 2HLFK specification: Two EB 1226HL batteries (NiMH, capacity 2.6 Ah), UC 14YFA charger and case

5. SELLING POINTS

(1) Cordless impact driver Model WH 12DAF2

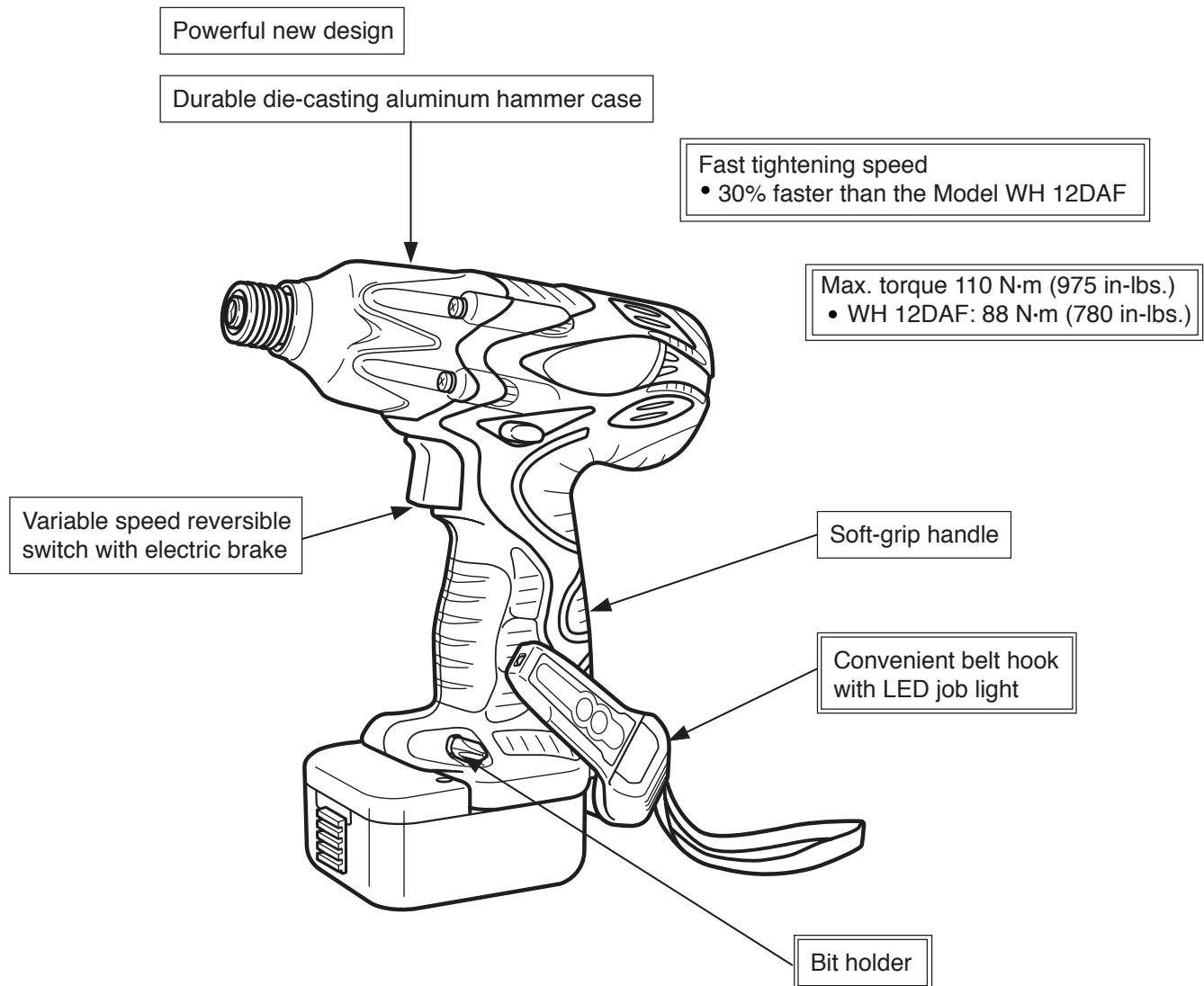

(2) Cordless impact wrench Model WR 12DAF2

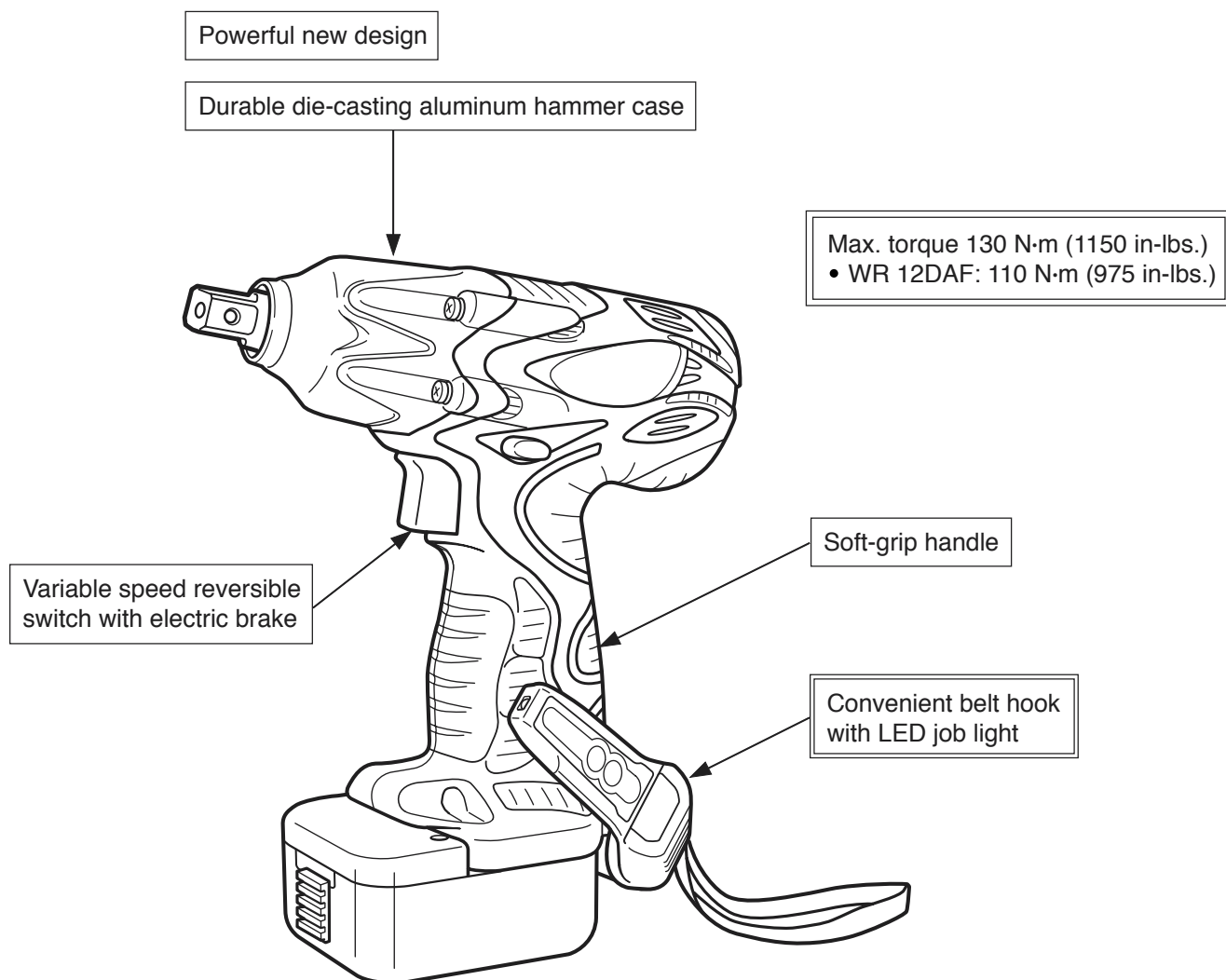

5-1. Selling Point Descriptions

Common selling points (Models WH 12DAF2 and WR 12DAF2)

(1) Soft-grip handle

The grip is soft, slip-resistant and comfortable thanks to the soft resin (elastomer) covered on the handle.

(2) Convenient belt hook with LED job light

It can be used as a hook for suspending from a waist belt or storing. Its yellow LED light is very convenient for such operations as tightening screws in a dark place. This hook features the following:

- ① It can be slid out when necessary and slid in when not necessary with one-touch simple operation. The angle can be adjusted in 5 steps.
- ② It can be installed on either right or left side. It is easily replaceable with a flat-blade screwdriver or a coin.
- ③ The yellow LED light can be lit by turning on its switch when necessary. The lighting direction is diagonal to minimize shadowing over the tool tip and the operator's hand holding a screw. The light will turn off automatically after 15 minutes if forgotten.

Selling points of the Model WH 12DAF2

(1) Fast tightening speed thanks to the powerful tightening torque (30% faster than the conventional model when tightening a universal machine screw of 5.3 mm diameter and 120 mm length)

The maximum tightening torque and the tightening speed of the Model WH 12DAF2 are greatly increased in comparison with the Model WH 12DAF thanks to the increased output of the motor and the large hammer.

① Tightening time comparison

Figure 1 shows the time required for tightening a wood screw (5.3 mm dia. x 120 mm length) into a lauan workpiece.

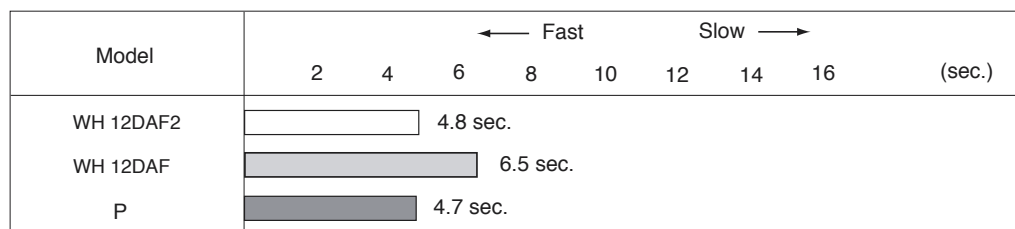

Fig. 1 Tightening time comparison

* Tightening time may vary depending on hardness of the workpiece, ambient temperature, characteristics of the battery, etc.

(2) Max. torque 110 N·m (975 in-lbs.)

The maximum torque is 110 N·m (975 in-lbs.) thanks to the optimum striking design while maintaining high mechanical strength with the durable die-casting aluminum hammer case, etc.

① Tightening torque comparison

Figure 2 shows the torque required for tightening an M12 high-strength tension bolt in 3 seconds with a hexagon socket (overall length 33 mm) (25% higher than the Model WH 12DAF).

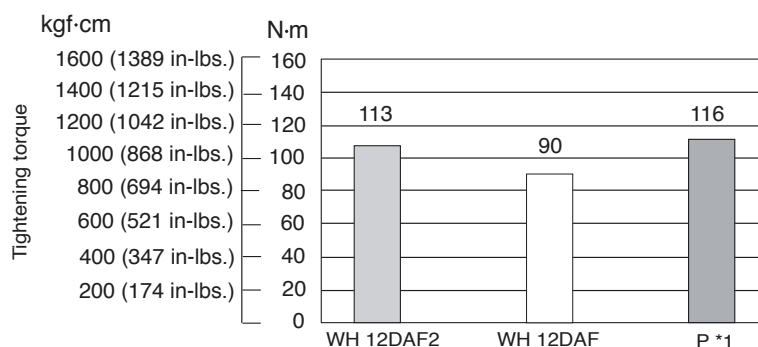

Fig. 2 Tightening torque comparison

*1: Max. tightening torque is based on tightening an M14 high-strength tension bolt in 3 seconds with a hexagon socket (40 mm long).

(3) Bit holder

A bit holder is provided at the handle portion. It is very convenient for holding a spare bit.

Selling points of the Model WR 12DAF2

(1) Max. torque 130 N·m (1150 in-lbs.)

The maximum torque is 130 N·m (1150 in-lbs.) thanks to the optimum striking design while maintaining high mechanical strength with the durable die-casting aluminum hammer case etc.

(2) Tightening torque comparison

Figure 3 shows the torque required for tightening an M12 high-strength bolt in 3 seconds with a hexagon socket (overall length 33 mm) (20 % higher than the Model WR 12DAF).

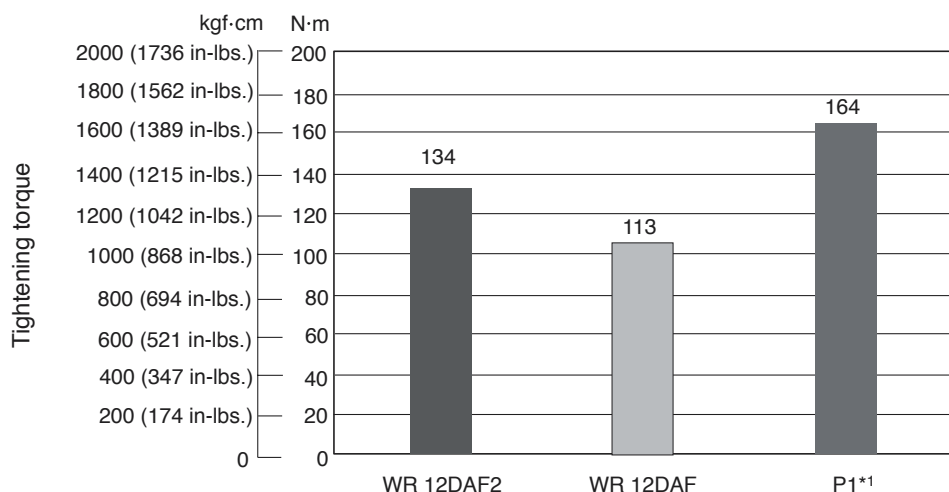

Fig. 3

*1: Max. tightening torque is based on tightening an M16 F10T bolt in 3 seconds with a hexagon socket (40 mm long).

* The data above are intended for reference purposes only because actual tightening torque will vary depending on tightening conditions.

6. SPECIFICATIONS

6-1. Specifications

Item \ Model		Cordless Impact Driver WH 12DAF2	Cordless Impact Wrench WR 12DAF2
Capacity		Small screw M4 – M8 (5/32" – 5/16")*1 Ordinary bolt M5 – M12 (3/16" – 15/32") High-strength bolt M5 – M10 (3/16" – 25/64")	Ordinary bolt M6 – M14 (1/4" – 9/16") High-strength bolt M6 – M10 (1/4" – 25/64")
Tightening torque*2		110 N·m (1120 kgf·cm, 975 in-lbs.)	130 N·m (1330 kgf·cm, 1150 in-lbs.)
Tip condition		6.35 mm (1/4") bit holder	12.7 mm (1/2") square drive
Type of motor		Fan cooled DC magnet motor	
Enclosure		Main body: Glassfiber reinforced polyamide resin (black) and thermoplastic elastomer (green) } Housing Aluminum alloy die casting Hammer case Storage battery: ABS resin (black) Charger: ABS resin (black)	
Type of switch		Trigger switch with forward/reverse changeover pushing button (with brake)	
Handle configuration		T-type	
No-load rotational speed		0 – 2,500/min	
Impact rate		0 – 2,900/min	
Weight	Main body	1.6 kg (3.5 lbs.) (with battery EB 1214S) 1.7 kg (3.7 lbs.) (with battery EB 1220BL/EB 1226HL)	
	Battery	0.5 kg (1.1 lbs.) (EB 1214S) 0.6 kg (1.3 lbs.) (EB 1220BL/EB 1226HL)	
Overall length x height		176 mm (6-15/16") x 217 mm (8-35/64") (with battery EB 1214S) 176 mm (6-15/16") x 226 mm (8-29/32") (with battery EB 1220BL/EB 1226HL)	181 mm (7-1/8") x 217 mm (8-35/64") (with battery EB 1214S) 182 mm (7-11/64") x 226 mm (8-29/32") (with battery EB 1220BL/EB 1226HL)
Center height		26.5 mm (1-3/64")	
Battery (Type EB 1214S/ EB 1220BL)		Sealed cylindrical nickel-cadmium battery Nominal voltage DC 12 V Nominal life Charging/discharging: approximately 300 cycles (in the case of the Model UC 14YFA or UC 18YG) Nominal capacity 1.4 Ah/2.0 Ah	
Battery (Type EB 1226HL)		Sealed cylindrical nickel-metal hydride batteries Nominal voltage DC 12 V Nominal life Charging/discharging: approximately 500 cycles (in the case of the Model UC 14YFA) Nominal capacity 2.6 Ah	
Charger (Model UC 14YFA)		Charger power source: Single-phase AC, 50/60 Hz Voltage: Depending on the order specification Power input: 56 W Charging system: Constant current charge with feedback control Overcharge protection system: (1) Battery voltage detection (Δ^2V system) Battery temperature detection (dT/dt system) for Ni-MH battery (2) Battery surface temperature detection (thermistor) (3) 120-minute timer Output voltage: 7.2 V – 14.4 V Output current: 2.6 A	

Charger (Model UC 14YFA)	Charging time: Approx. 30 minutes (for type EB 1214S battery at 20°C) Approx. 60 minutes (for type EB 1226HL battery at 20°C) Approx. 50 minutes (for type EB 1220BL battery at 20°C) Power weight: 0.6 kg Operable ambient temperature range: 0°C — 40°C The maximum allowable temperature of the EB 1214S or EB 1220BL type battery is 55°C and the EB 1226HL type battery is 45°C.
Charger (Model UC 18YG) NOTE: The Model UC 18YG charger is exclusive to NiCad batteries.	<ul style="list-style-type: none"> Overcharge prevention circuit: A thermostat monitors the surface temperature of the battery and, on detecting the temperature rise which occurs on completion of charging, automatically turns off the unit to prevent the battery from overcharge. Output capacity: 70 W Indication method: Pilot lamp indicator of battery charging Function: On During charging Off Charging completed

*1: In the case of tapping screws and wood screws, a minimum of M3 (1/8") is possible.

*2: This torque is based on tightening an M12 (15/32") bolt (strength grade: 12.9) for 3 seconds with a hexagonal socket.

Pilot lamp indications (Model UC 14YFA)

Red pilot lamp remains lit or flashes	Prior to charging	Blinks	0.5 sec ON, 0.5 sec OFF ■ ■ ■ ■ ■	
	During charging	Lit	Stays ON constantly ■■■■■■■■■■	
	Charging completed	Blinks	0.5 sec ON, 0.5 sec OFF ■ ■ ■ ■ ■	
	Charging not possible	Flickers	0.1 sec ON, 0.1 sec OFF ■ ■ ■ ■ ■ ■ ■	Storage battery or charger is faulty.
Green pilot lamp is lit	High battery temperature	Lit	Stays ON constantly ■■■■■■■■■■	Charging not possible because storage battery temperature is too high.

6-2. Optional Accessories

(1) Battery (EB 1214S, EB 1220BL, EB 1226HL)

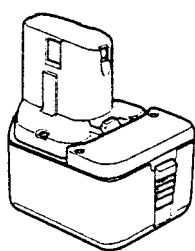

(2) For the Model WH 12DAF2

There are two types of attachment sizes for the driver bit and the socket. Please refer to the table below and select the attachment size for the driver bit or socket that is appropriate for your WH 12DAF2.

Attachment size		Purchase location
Type-L	17mm 13mm	Republic of Korea, Taiwan, Hong Kong, People's Republic of China, Republic of Singapore
Type-S	12mm 9mm	Other than above regions.

- Plus driver bit

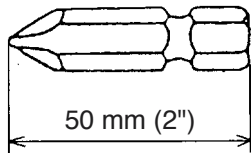

Bit No.	Code No.
No. 2	992671
No. 3	992672

- Hexagon socket

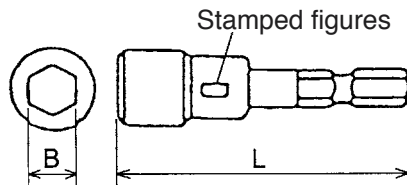

Part Name	Stamped figures	L (mm)	B (mm)	Code No.
4 mm Hexagon socket	7	65 (2-9/16")	7 (1/4")	992689
5 mm Hexagon socket	8	65 (2-9/16")	8 (5/16")	996177
6 mm Hexagon socket	10	65 (2-9/16")	10 (3/8")	985329
5/16" Hexagon socket	12	65 (2-9/16")	12 (15/32")	996178
8 mm Hexagon socket	13	65 (2-9/16")	13 (1/2")	996179
10 mm Hexagon socket (small type)	14	65 (2-9/16")	14 (9/16")	996180
10 mm Hexagon socket	16	65 (2-9/16")	16 (5/8")	996181
10 mm Hexagon socket	17	65 (2-9/16")	17 (21/32")	996182
1/2" Hexagon long socket	21	166 (6-17/32")	21 (53/64")	996197

- Woodworking drill bit (Code No. 959183)

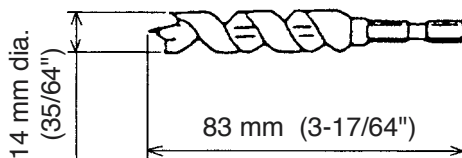

- Drill chuck adaptor set (Code No. 321823)

The drill chuck adaptor set permits mounting of various types of locally-available drill bits for a variety of drilling operations.

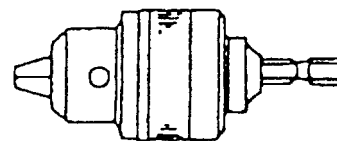

(3) For the Model WR 12DAF2

The Model WR 12DAF2 is a 12.7 square driver specification. Please select the socket with the appropriate attachment size.

- Each dimension and applicable bolt for each hexagon socket

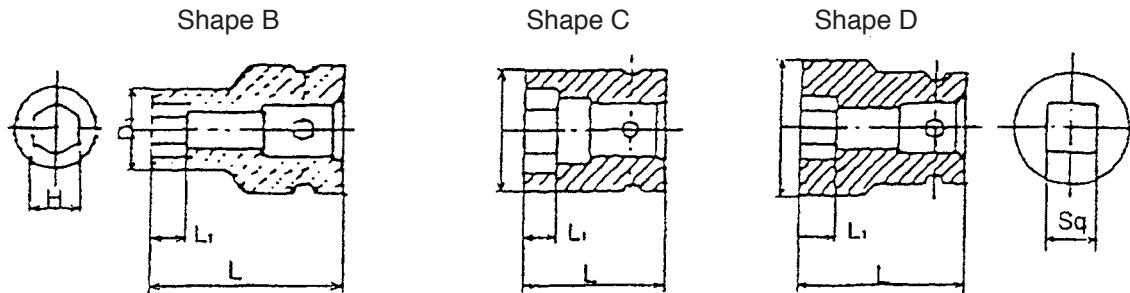

Square drive dimension Sq	Part name	Code No.	Nominal diameter of applicable bolts				Dihedral width H (mm)	Shape	Socket primary dimensions (mm)		
			ISO (High-strength)	ISO (Ordinary)	ISO (Small type)	Inch screw			L	L ₁	D ₁
12.7 mm (1/2")	Hexagon socket	10 mm 944291	—	M 6 (1/4")	—	—	10 (3/8")	B	40 (1-9/16")	8 (5/16")	18 (23/32")
		12 mm 873632	—	—	M 8 (5/16")	W 5/16"	12 (15/32")	B	40 (1-9/16")	8 (5/16")	20 (25/32")
		13 mm 873539	—	M 8 (5/16")	—	—	13 (1/2")	B	40 (1-9/16")	9 (11/32")	25 (1")
		14 mm 873540	—	—	M 10 (3/8")	—	14 (9/16")	B	40 (1-9/16")	9 (11/32")	25 (1")
		17 mm 873536	—	M 10 (3/8")	M 12 (15/32")	W 3/8"	17 (21/32")	C	32 (1-1/4")	8 (5/16")	28 (1-3/32")
		19 mm 873624	—	M 12 (15/32")	M 14 (9/16")	W 7/16"	19 (23/32")	C	34 (1-11/32")	9 (11/32")	28 (1-3/32")
		21 mm 873626	—	—	—	W 1/2"	21 (53/64")	D	36 (1-13/32")	10 (3/8")	32 (1-1/4")
		22 mm 873627	M 12 (15/32")	M 14 (9/16")	M 16 (5/8")	—	22 (7/8")	D	40 (1-9/16")	14 (9/16")	35 (1-3/8")

- Each dimension and applicable bolt for each long socket

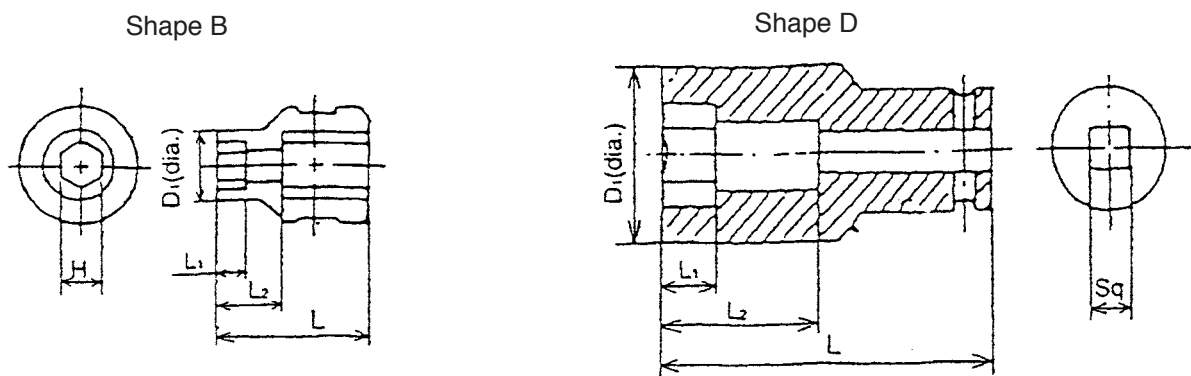

Square drive dimension Sq	Part name	Code No.	Nominal diameter of applicable bolts				Dihedral width H (mm)	Shape	Socket primary dimensions (mm)			
			ISO (High-strength)	ISO (Ordinary)	ISO (Small type)	Inch screw			L	L ₁	L ₂	D ₁
12.7 mm (1/2")	Long socket	12 mm 955138	—	—	M 8 (5/16")	W 5/16"	12 (15/32")	B	52 (2-3/64")	20 (25/32")	34 (1-11/32")	20 (25/32")
		13 mm 955139	—	M 8 (5/16")	—	—	13 (1/2")	B	52 (2-3/64")	20 (25/32")	34 (1-11/32")	21.5 (53/64")
		14 mm 955140	—	—	M 10 (3/8")	—	14 (9/16")	B	52 (2-3/64")	20 (25/32")	34 (1-11/32")	22 (7/8")
		17 mm 955141	—	M 10 (3/8")	M 12 (15/32")	W 3/8"	17 (21/32")	B	52 (2-3/64")	24 (15/16")	34 (1-11/32")	25 (1")
		17 mm 955149	—	M 10 (3/8")	M 12 (15/32")	W 3/8"	17 (21/32")	B	75 (2-15/16")	24 (15/16")	57 (2-1/4")	25 (1")
		19 mm 955142	—	M 12 (15/32")	M 14 (9/16")	W 7/16"	19 (23/32")	B	52 (2-3/64")	24 (15/16")	34 (1-11/32")	28 (1-3/32")
		19 mm 955150	—	M 12 (15/32")	M 14 (9/16")	W 7/16"	19 (23/32")	B	75 (2-15/16")	24 (15/16")	57 (2-1/4")	28 (1-3/32")
		21 mm 955143	—	—	—	W 1/2"	21 (53/64")	D	52 (2-3/64")	24 (15/16")	34 (1-11/32")	31 (1-7/32")
		21 mm 955151	—	—	—	W 1/2"	21 (53/64")	D	75 (2-15/16")	24 (15/16")	57 (2-1/4")	31 (1-7/32")
		21 mm 991480	—	—	—	W 1/2"	21 (53/64")	D	125 (4-47/51")	24 (15/16")	107 (4-7/32")	31 (1-7/32")
		22 mm 955144	M 12 (15/32")	M 14 (9/16")	M 16 (5/8")	—	22 (7/8")	D	52 (2-3/64")	24 (15/16")	34 (1-11/32")	32.5 (1-9/32")

• Bit adaptor (Code No. 991476)

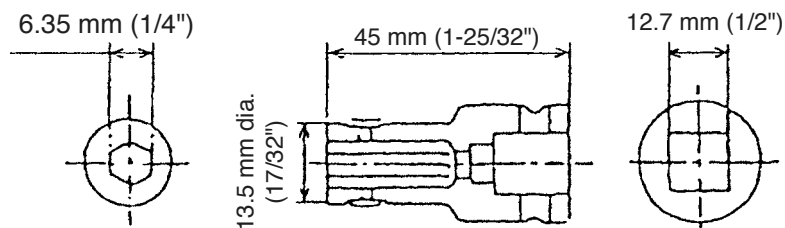

Part name	Overall length (mm)	Code No.
Plus hd. driver bit No. 2	45 (1-25/32")	955229
	70 (2-3/4")	955654
Plus hd. driver bit No. 3	45 (1-25/32")	955230
	70 (2-3/4")	955655

• Extension bar [Overall length 100 mm (3-15/16")] (Code No. 873633)

• Universal joint (Code No. 992610)

• Socket ass'y for duct

Dihedral width of applicable bolts	Code No.
12 (15/32")	993658
13 (1/2")	992613
14 (9/16")	992615

• EW-14R corner attachment (Code No. 9329-9001)

7. COMPARISONS WITH SIMILAR PRODUCTS

7-1. Specification Comparisons

7-1-1. Cordless impact driver

Item		Maker	HITACHI		P
		Model	WH 12DAF2	WH 12DAF	
Capacity	Small screw		M4 – M8 (5/32" – 5/16")*1	M4 – M8 (5/32" – 5/16")*1	—
	Ordinary bolt		M5 – M12 (3/16" – 15/32")	M4 – M12 (5/32" – 15/32")	—
	High-strength bolt		M5 – M10 (3/16" – 3/8")	M4 – M10 (5/32" – 3/8")	—
Max. tightening torque*2		N·m	110 (975 in-lbs., 1120 kgf·cm)	88 (780 in-lbs., 900 kgf·cm)	113 (1000 in-lbs., 1173 kgf·cm)
No-load rotation speed		/min	0 – 2,500	0 – 2,200	0 – 2,400
Impact rate		/min	0 – 2,900	0 – 2,900	0 – 3,000
Main body weight*3		kg	1.7 (3.7 lbs.) : With EB 1220BL/ EB 1226HL	1.6 (3.5 lbs.) : With EB 1214L/ EB 1220BL/ EB 1222HL	1.7 (3.7 lbs.)
			1.6 (3.5 lbs.) : With EB 1214S	1.5 (3.3 lbs.) : With EB 1212S	
Overall length		mm	176 (6-15/16")	176 (6-15/16")	165 (6-1/2")
Overall height		mm	226 (8-7/8") : With EB 1220BL/ EB 1226HL	226 (8-7/8") : With EB 1214L/ EB 1220BL/ EB 1222HL	233 (9-11/64")
			217 (8-1/2") : With EB 1214S	217 (8-1/2") : With EB 1212S	
Center height		mm	26.5 (1-3/64")	26 (1-1/64")	29 (1-9/64")
Tool tip mounting system			Driver chuck	Driver chuck	Driver chuck
Switch	Variable speed		Equipped	Equipped	Equipped
	Electric brake		Equipped	Equipped	Equipped
Type of motor			DC magnet	DC magnet	DC magnet
Voltage		V	12	12	12
Battery	Type		EB 1214S/EB1220BL/ EB 1226HL	EB 1212S/EB 1214L/ EB 1220BL/EB 1222HL	DW9071
	Nominal capacity	Ah	1.4/2.0/2.6	1.2/1.4/2.0/2.2	1.7
	Nominal voltage	V	12	12	12
Charger	Model		UC 14YFA/UC 18YG	UC 12SD/UC 24YFA	DW9107
	Recharging voltage	V	7.2 – 14.4/7.2 – 18	12/7.2 – 24	7.2 – 14.4
	Charging time	min.	EB 1214S Approx. 30 min.	EB 1212S, EB 1214L Approx. 60/40 min.	45 min.
			EB 1226HL *4 Approx. 60/- min.	EB 1220BL *5 Approx. -/50 min.	
			EB 1220BL Approx. 50 min.	EB 1222HL *5 Approx. -/55 min.	
Standard accessories			• Plastic case • Charger (UC 14YFA/ UC 18YG)	• Plastic case • Charger (UC 12SD/ UC 24YFA)	• Plastic case • Charger

^{*1}: In the case of tapping screws and wood screws, a minimum of M3 is possible.

^{*2}: Max. tightening torque is based on tightening an M12 (15/32") bolt (strength grade: 12.9) for 3 sec. with a hexagon socket.

^{*3}: Main body weight does not include accessory tools (hexagon bit etc.).

^{*4}: This type of battery could not be charged by the Model UC 18YG.

^{*5}: This type of battery could not be charged by the Model UC 12SD.

7-1-2. Cordless impact wrench

Item		Maker	HITACHI		P
		Model	WR 12DAF2	WR 12DAF	
Capacity	Ordinary bolt		M6 – M14 (1/4" – 9/16")	M6 – M14 (1/4" – 9/16")	—
	High-strength bolt		M6 – M12 (1/4" – 15/32")	M6 – M10 (1/4" – 3/8")	—
Max. tightening torque* ¹		N·m	130 (1150 in-lbs., 1330 kgf·cm)	110 (975 in-lbs., 1020 kgf·cm)	160 (1400 in-lbs., 1633 kgf·cm)
No-load rotation speed		/min	0 – 2,500	0 – 2,200	0 – 2,400
Impact rate		/min	0 – 2,900	0 – 2,900	0 – 3,000
Main body weight* ²		kg	1.7 (3.7 lbs.) : With EB 1220BL/ EB 1226HL	1.6 (3.5 lbs.) : With EB 1214L/ EB 1220BL/ EB 1226HL	1.75 (3.9 lbs.)
			1.6 (3.5 lbs.) : With EB 1214S	1.5 (3.3 lbs.) : With EB 1212S	
Overall length		mm	181 (7-1/8")	181 (7-1/8")	168 (6-39/64")
Overall height		mm	226 (8-7/8") : With EB 1220BL/ EB 1226HL	226 (8-7/8") : With EB 1214L/ EB 1220BL/ EB 1226HL	233 (9-11/64")
			217 (8-1/2") : With EB 1214S	217 (8-1/2") : With EB 1212S	
Center height		mm	26.5 (1-3/64")	26 (1-1/64")	29 (1-9/64")
Tip condition			12.7 mm (1/2") square drive	12.7 mm (1/2") square drive	12.7 mm (1/2") square drive
Tool tip mounting system			Plunger	Plunger	Plunger
Switch	Variable speed		Equipped	Equipped	Equipped
	Electric brake		Equipped	Equipped	Equipped
Type of motor			DC magnet	DC magnet	DC magnet
Voltage		V	12	12	12
Battery	Type		EB 1214S/EB 1220BL/ EB 1226HL	EB 1212S/EB 1214L/ EB 1220BL/EB 1226HL	DW9071
	Nominal capacity	Ah	1.4/2.0/2.6	1.2/1.4/2.0/2.6	1.7
	Nominal voltage	V	12	12	12
Charger	Model		UC 14YFA/UC 18YG	UC 12SD/UC 14YFA	DW9107
	Recharging voltage	V	7.2 – 14.4/7.2 – 18	12/7.2 – 14.4	7.2 – 14.4
	Charging time	min.	EB 1214S ... Approx. 30 min.	EB 1212S, EB 1214L Approx. 60/40 min.	45 min.
			EB 1226HL * ³ Approx. 60/- min.	EB 1220BL * ⁴ Approx. -/50 min.	
			EB 1220BL Approx. 50 min.	EB 1226HL * ⁴ Approx. -/60 min.	
Standard accessories			• Plastic case • Charger (UC 14YFA/UC 18YG)	• Plastic case • Charger (UC 12SD/UC 14YFA)	• Plastic case • Charger

^{*1}: Max. tightening torque is based on tightening an M12 (15/32") bolt (strength grade: 12.9) for 3 sec. with a hexagon socket.

^{*2}: Main body weight does not include accessory tools (hexagon socket etc.).

^{*3}: This type of battery could not be charged by the Model UC 18YG.

^{*4}: This type of battery could not be charged by the Model UC 12SD.

7-2. Tightening Torque

7-2-1. Screw diameter and appropriate tightening torque

Generally speaking, the appropriate tightening torque for a screw can be determined by the strength grade of the screw and the material tightened. Tables 1 and 2, and Fig. 4 below list data relative to the strength grade of various screws and the appropriate tightening torque. For further reference, appropriate tightening torque is calculated with the following formula. Study and use this formula for accurate selection of tightening torque.

$$T = k \cdot d \cdot p$$

T: Appropriate tightening torque (kgf·cm)

d: Nominal diameter for the screw (mm)

p: Recommended axial tightening force to be applied to the screw (kgf)

$p = \text{rated axial stress (kgf/cm}^2\text{)} \times 0.8 \times \text{effective sectional area of the thread (mm}^2\text{)}$

K: Torque coefficient (0.17)

- Strength grade and rated axial stress of threads

Table 1

Strength grade	4.8	6.8	8.8	12.9
Rated axial stress (kgf/mm ²)	29.1	43.7	58.2	95
Material	Mild steel		Alloy steel including Ni, Mn, Cr, etc.	
Heat treatment	None		Processed-hard material	

- Diameter and effective sectional areas of threads

Table 2

Kind of thread (x pitch)	M5 x 0.8 mm (3/16")	M6 x 1 mm (1/4")	M8 x 1.25 mm (5/16")	M10 x 1.5 mm (3/8")	M12 x 1.75 mm (15/32")	M14 x 2 mm (9/16")
Effective sectional area of thread (mm ²)	14.2	20.1	36.6	58.0	84.3	115

- Thread diameter and appropriate tightening torque

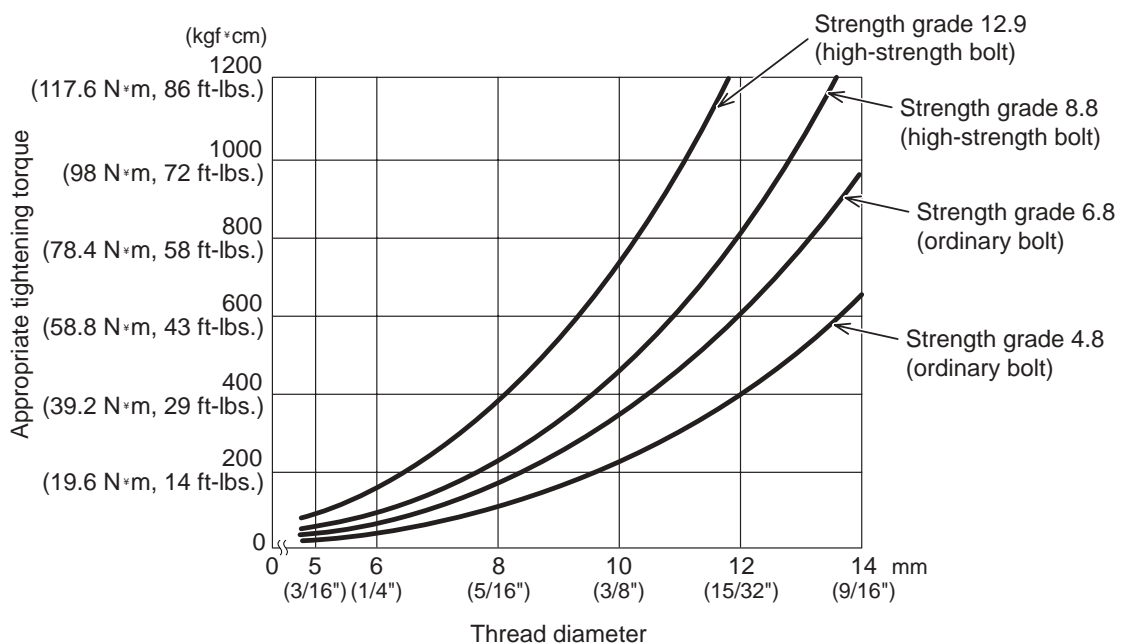

Fig. 4

7-2-2. Bolt tightening torque characteristics

Figure 2 shows relationships between time and tightening torque for individual bolt types and sizes. While the data are useful for handy reference, actual tightening torque will vary depending on tightening conditions and other variables. For details, please refer to Para. 8-3, Tightening Torque Variation.

NOTE: • The term "tightening time" indicates the impact time after the lower surface of the bolt has come in contact with the material into which it is being tightened.

- In the tightening conditions shown in Figs. 5-1 and 5-2, the screws are being tightened directly into a steel plate; accordingly, the torque goes up very abruptly in comparison with ordinary bolt tightening conditions.

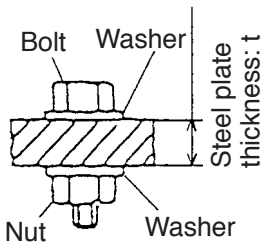

* The following bolts were utilized:
Ordinary bolt; strength grade 4.8
High-strength bolt; strength grade 12.9

Strength grade is read as follows:

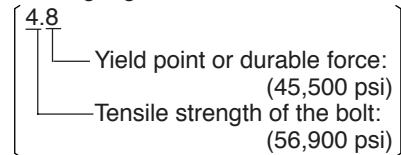

• Model WH 12DAF2

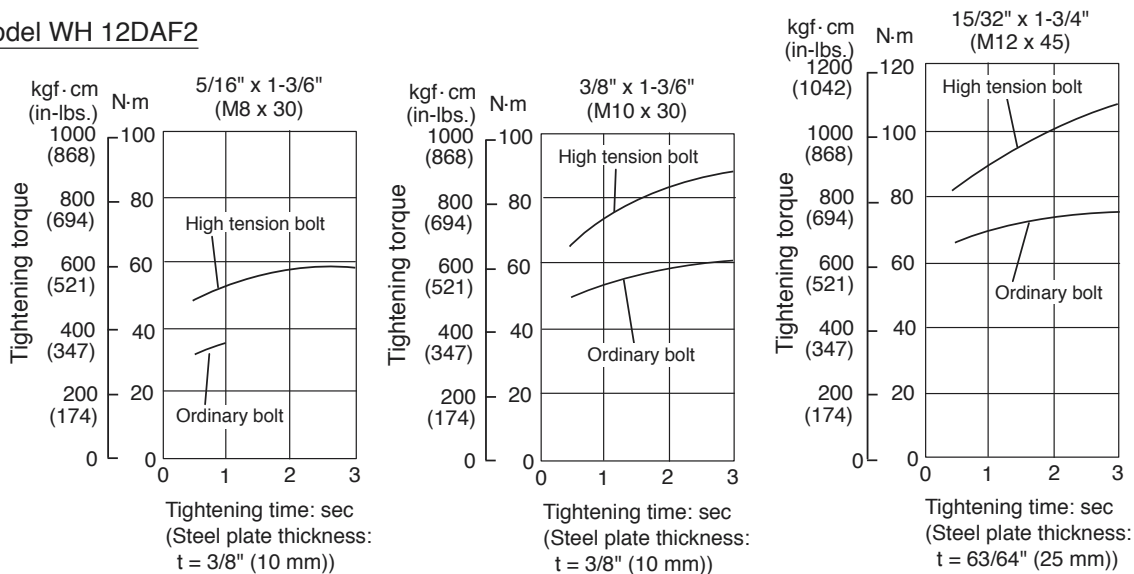

Fig. 5-1

• Model WR 12DAF2

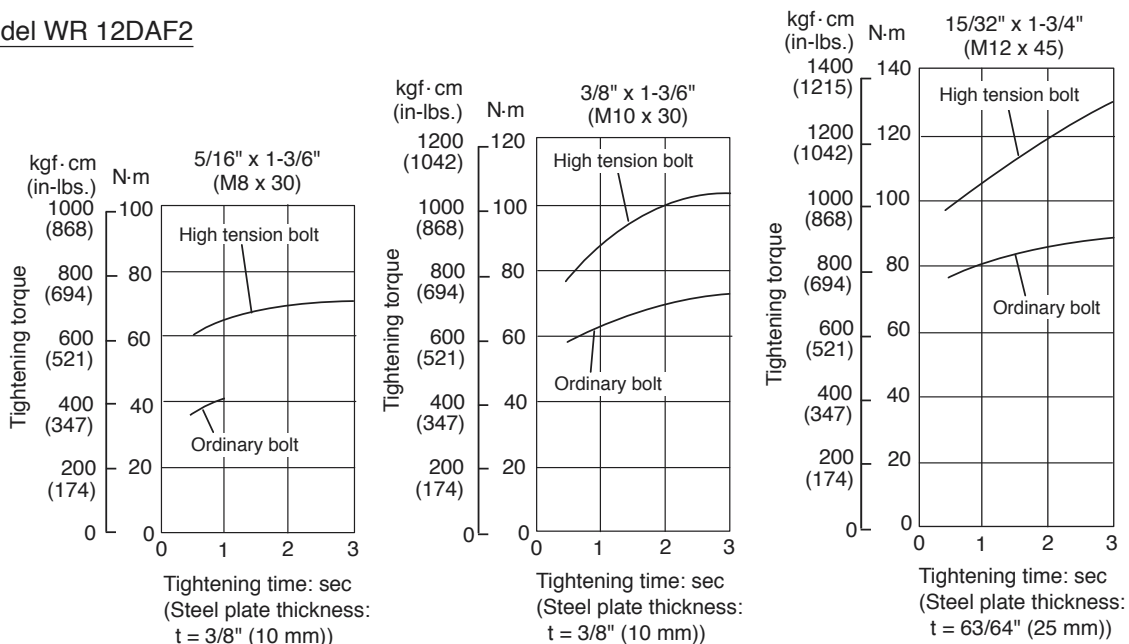

Fig. 5-2

7-3. Number of Screws or Bolts Driven

7-3-1. Per-charge working capacity comparisons

Test data on the number of screws which can be driven per battery charge by the new model vs. the previous models are shown in the table below. Please note that the data below are intended for general reference only as the number of screws which can be tightened per charge will vary slightly depending on screw tightening conditions, screw sizes, ambient temperatures and the charging capacity of the battery.

(1) Number of screws or bolts driven

Tightening condition \ Model	HITACHI WH 12DAF	HITACHI WH 12DAF2	P
Battery (Nominal capacity)	EB 1214L (1.4 Ah)	EB 1214S (1.4 Ah)	DW9071 (1.7 Ah)
Wood screw 4.0 mm dia. x 50 mm (soft wood)	230	190	265
Wood screw 4.2 mm dia. x 75 mm (hard wood)	135	110	155
Wood screw 4.5 mm dia. x 90 mm (hard wood)	85	70	100
Machine screw (M8 x 16 mm)	730	500	810

8. PRECAUTIONS IN SALES PROMOTION

8-1. Safety Instructions

In the interest of promoting the safest and most efficient use of these tools by all our customers, it is very important that at the time of sale the salesperson carefully ensures that the buyer seriously recognizes the importance of the contents of the Handling Instructions, and fully understands the meaning of the precautions listed on the Caution Plate and Name Plate attached to each tool.

A. Handling Instructions

Salespersons must be thoroughly familiar with the contents of the Handling Instructions in order to give pertinent advice to the customer. In particular, they must have a thorough understanding of the precautions in the use of the cordless (battery charger type) electric power tools which are different from those of ordinary electric power tools.

- (1) Before use, ensure that the unit is fully charged.

New units are not fully charged. Even if the units were fully charged at the factory, long periods without use, such as during shipping, cause the storage battery to lose its charge. Customers must be instructed to fully charge the unit prior to use.

- (2) When charging storage batteries, use only the exclusive Model UC 14YFA or UC 18YG charger provided with the tool. Because of the designed rapid-charging feature, use of other battery chargers is hazardous.

- (3) Follow prescribed steps in using the charger.

First connect the storage battery to the charger, then plug the charger into an AC outlet (ensuring that the voltage matches that indicated on the unit). If this order is reversed, the charger may not function properly.

- (4) Ensure the power source voltage is the same as that indicated on the Name Plate of the charger. Use of any other power source (DC outlet, fuel powered generator, etc.) will cause the charger to overheat and burn out.

- (5) Do not use any voltage increasing equipment (transformer etc.) between the power source and the charger. If the charger is used with voltage over and above that indicated on the unit, it will not function properly.

- (6) Conduct battery charging at an ambient temperature range of 0 °C — 40° C (32 °F — 104 °F).

Special temperature sensitive devices are employed in the charger to permit rapid charging. Ensure that customers are instructed to use the charger at the indicated ambient temperature range. At temperatures under 0 °C (32 °F), the thermostat will not function properly, and the storage battery may be over-charged. At temperatures over 40 °C (104 °F), the storage battery cannot be sufficiently charged. The optimum temperature range is 20 °C — 25 °C (68 °F — 77 °F).

- (7) The battery charger should not be used continuously.

At high ambient temperatures, if over three storage batteries are charged in succession, the temperature of the coils on the transformer will rise and there is a chance that the temperature fuse inserted in the interior of the transformer will inadvertently melt. After charging one battery, please charge the next battery after about a fifteen-minute interval.

- (8) The charger case is equipped with air vents to protect the internal electronic components from overheating. Caution the customer not to allow foreign materials, such as metallic or flammable objects, to be dropped or inserted into the air vents. This could cause electrical shock, fire or other serious hazards.

(9) Do not attempt to disassemble the storage battery or the charger.

Special devices, such as a thermostat, are built into the storage battery and charger to permit rapid charging. Incorrect parts replacement and/or wiring will cause malfunctions which could result in fire or other hazards. Instruct the customer to bring these units to an authorized service center in the event repair or replacement is necessary.

(10) Disposal of the Type EB 1214S, EB 1220BL or EB 1226HL storage battery

Ensure that all customers understand that Type EB 1214S, EB 1220BL or EB 1226HL storage batteries should be turned in to any Hitachi power tool sales outlet or authorized service center when they are no longer capable of being recharged or repaired. If thrown into a fire, the batteries may explode, or if discarded indiscriminately, leakage of the cadmium compound contained in the battery may cause environmental pollution.

B. Caution Plates

(1) The following precautions are listed on the Name Plate or Caution Plate attached to the main body of each tool.

For Asia and Oceania

CAUTION

- Read thoroughly **HANDLING INSTRUCTIONS** before use.

For the U.S.A. (excludes French) and Canada

Warning

- To reduce the risk of injury, user must read and understand Instruction Manual.

AVERTISSEMENT

- Afin de réduire le risque de blessures, l'utilisateur doit lire et bien comprendre le mode d'emploi.

(2) The following cautions are listed on the Name Plate attached to each Type EB 1214S, EB 1220BL or EB 1226HL storage battery:

For Europe

- CAUTION**
- Read thoroughly **HANDLING INSTRUCTIONS** before use.
 - Do not disassemble nor throw into fire.

For the U.S.A. and Canada

- CAUTION**
- For safe operation, see Instruction Manual.
 - Use **HITACHI** charger recommended in instruction manual for recharging.

(3) The following caution is listed on the Name Plate attached to the Model UC 14YFA or UC 18YG charger.

< UC 18YG >

For the U.S.A. and Canada

- CAUTION** • For safe operation, see instruction manual.
- Charge HITACHI rechargeable battery types EB 7, EB 9, EB 12, EB 14 and EB 18 series. Other types of batteries may burst causing personal injury and damage.
 - Charge between 32°F and 104°F. Rest 15 minutes between the charging of batteries.
 - Indoor use only. • Replace defective cord immediately.

< UC 14YFA >

For the U.S.A. and Canada

- CAUTION**
- For safe operation, see Instruction Manual.
 - Charge HITACHI rechargeable batteries Type EB 7, EB 9, EB 12 and EB 14 series. Other types of batteries may burst causing personal injury and damage.
 - Charge between 32 and 104°F. Rest 15 minutes between the charging of batteries.
 - Indoor use only.
 - Replace defective cord immediately.

8-2. Tightening Torque Inspection Prior to Operation

As described and shown in Para. 7-2-2, the output tightening torque of which the Models WH 12DAF2 and WR 12DAF2 are capable in excess of the rated tightening torque of certain bolts and screws. Accordingly, if the tightening time is prolonged for such bolts and screws, it could cause damage to their threads or, in the worst case, cause them to be sheared off. (This phenomenon is common to all existing impact drivers.) Particularly when tightening M6 (1/4") or smaller screws, tightening time must be kept extremely short: 0.5 seconds or less. The customer should be advised to carry out several screw tightening operations and adjust the tightening time as necessary by measuring the tightening torque with an appropriate torque wrench or driver before commencing continuous operation.

8-3. Tightening Torque Variation

The tightening torque of the cordless impact driver or wrench may vary slightly in accordance with the factors described below. Salespersons are requested to advise the customer to confirm that appropriate tightening torque is obtained by measuring the torque with an appropriate torque wrench or torque driver at the beginning of the tightening operations, and as necessary during the tightening operations. In addition, the torque values shown in Para. 7-2-1 above are useful as a handy reference, and may be utilized as tentative standards.

(1) Voltage of battery

Tightening torque is affected by the voltage output of the battery. For example, the relationship between tightening torque and the number of M12 x 45 mm (15/32" x 1-3/4") high-strength bolts tightened is shown in figure below. As can be seen in the graph, the tightening torque decreases as the number of bolts tightened increases. This phenomenon is caused by the decline in voltage output of the battery due to the increasing number of bolts tightened. In particular, the tightening torque decreases rapidly just before the battery is fully discharged (range "a" in the graph). As this phenomenon is an inherent drawback in any cordless impact driver, salespersons are requested to ensure that the customer is fully aware of and understands this characteristic.

(WR 12DAF2)

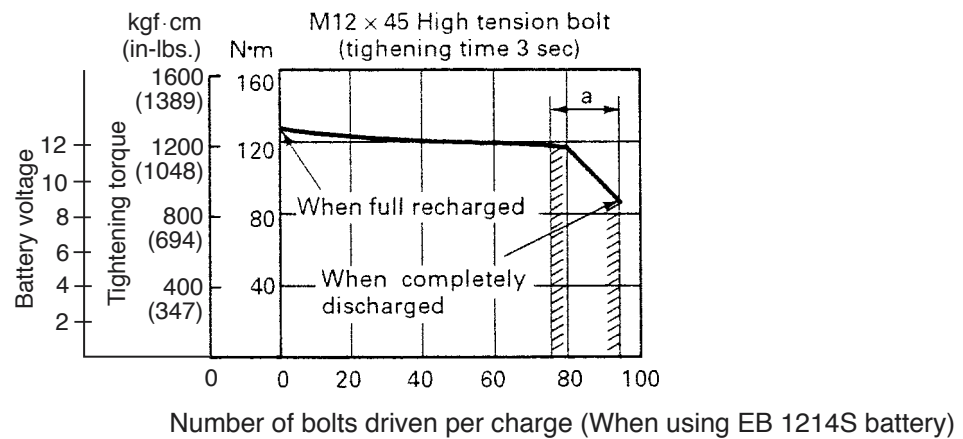

Fig. 6

(2) Effects of low ambient temperatures

The tightening torque required may be reduced at low ambient temperatures or under the influence of grease and different torque coefficients (dependent on manufacturing and finishing processes, and specified by bolt manufacturers).

(3) Different bolt diameter

Differences in bolt diameter will cause variation of the required levels of tightening torque. Generally speaking, tightening torque is higher for large bolts.

(4) Different materials being tightened

When a bolt is tightened into a soft material such as aluminum, plastic, wood, etc., the tightening torque is considerably less than when the bolt is tightened into a hard material such as steel.

(5) Different tightening conditions

The tightening torque may vary in accordance with bolt torque coefficient (dependent on manufacturing process specified by bolt manufactures), bolt grade and bolt length, even though the dimensions of the bolts are the same. Tightening torque may also vary depending on the surface finishing state of tightening materials (steel, aluminum, etc.), and materials to be tightened. In addition, if there is seal packing, clearance, etc., between tightening materials, the tightening torque is decreased.

(6) Wear and looseness of the socket

With extended use, the hexagonal portion of the socket which is fitted to the head of the bolt or drill bit, and/or hexagonal portion of the driver chuck which is fitted onto the anvil in the main body will become worn and loose. Wear and looseness will cause a proportionate loss of tightening torque.

In addition, use of an incorrect size socket (slightly larger than the bolt being tightened) will also result in decreased torque.

(7) Bolt and nut rotate together

Tightening torque that can be achieved will be considerably decreased if the bolt and nut rotate together during the tightening operation. The customer should be advised to carefully observe the operation and ensure this does not occur.

8-4. Suggestions and Precautions for the Efficient Use of the Charger

(1) Batteries may not be rechargeable immediately after use

If the storage batteries are exposed to direct sunshine for an extended period, or if the temperature of the battery is 40 °C (104 °F) or higher immediately after they have been used in the tool, the pilot lamp may not light up when the batteries are connected to the Model UC 14YFA or UC 18YG charger. This is because the built-in thermostat functions to stop the charging when the temperature of the storage batteries reach 40°C (104 °F) or more. In such a case, the customer should be advised to place the batteries in a shaded area with a good airflow, and allow sufficient cooling before recharging. This phenomenon is common to all existing batteries which employ temperature sensitive overcharge devices. The cooling time required before charging can be accomplished varies from a few minutes to about 30 minutes, depending on the load, duration of use, and ambient temperature.

9. OTHER PRECAUTIONS

(1) Check for cracks or other damage on the socket

Cracks or any other faults on the socket are very hazardous. In addition, cracks or other damage to accessories will cause loss of tightening torque efficiency. Advise the customer to inspect accessories often, and ensure there are no abnormalities.

(2) Socket dimensions

Without fail, utilize an appropriate socket which matches the bolt and/or nut dimensions. If the socket dimensions are larger than the bolts or nuts, it will not only cause insufficient tightening torque, but could also easily cause damage to the socket. Please refer to the tables in Para. 6-2 for appropriate socket dimensions.

(3) Hammering section lubrication

Frequent or continuous use of the tool will cause excessive temperature rise of the hammering section, resulting in depletion of the grease and subsequent increased wear of components which will, in turn, cause loss of tightening efficiency. Accordingly, it is necessary to periodically replenish the grease in the hammering section to ensure proper lubrication of moving and sliding components.

10. REPAIR GUIDE

WARNING: Without fail, remove the battery from the main body before starting repair or maintenance work. Because the tool is cordless, if the battery is left in and the switch is activated inadvertently, the motor will start rotating unexpectedly, which could cause serious injury.

10-1. Precautions in Disassembly and Reassembly

The **[Bold]** and **<Bold>** numbers correspond to the item numbers in the Parts List and the exploded assembly diagram. ([]: WH 12DAF2. < >: WR 12DAF2)

10-1-1. Disassembly

(1) Removal of the Gear Box Ass'y [1] <1>

Remove the four Tapping Screws (W/Sp. Washer) D4 x 40 [6] <2> that connect the Hammer Case [7] <3> with Housing (A).(B) Set [31] <28> . Remove the Hammer Case [7] <3>, the Inner Cover [23] <20> and the Damper [24] <21> together from Housing (A).(B) Set [31] <28>. Remove the Retaining Ring [25] <22>. Then the Gear Box Ass'y [1] <1> can be removed.

(2) Removal of the Hook Ass'y (W/Light) [36] <32>

Remove the Special Screw M5 [44] <40> with a flatblade screwdriver or a coin then remove the Hook Ass'y (W/Light) [36] <32> and the Hook Spring [43] <39>.

(3) Removal of housing (B)

Remove the seven Tapping Screws (W/Flange) D4 x 20 (Black) [29] <26> from the main body to remove housing (B).

(4) Remove the DC-Speed Control Switch [32] <30>, the Fin [42] <38> and the Motor [26] <23> together.

Remove the Pushing Button [33] <31> and the Strap (Black) [39] <35>.

(5) Disassembly of the switch ass'y

Disconnect the Internal Wire (Red) 115L [27] <24>, the Internal Wire (Black) 60L [28] <25> from the DC-Speed Control Switch [32] <30> with a soldering iron. Remove the Machine Screw (W/Sp. Washer) M3 x 4 [41] <37> to remove the Fin [42] <38> from the FET of the DC-Speed Control Switch [32] <30>.

NOTE: Do not disconnect the three FET internal wires soldered to the DC-Speed Control Switch [32] <30>.

(6) Removal of the Guide Sleeve [5] (Model WH 12DAF2 only)

By following the procedure shown in Figs. 7-1 to 7-4, you can remove the Retaining Ring [2], Washer (D) [3], Guide Spring [4] and the Guide Sleeve [5] in this order. Be sure not to lose the Steel Ball D3.5 [8] in Anvil [9].

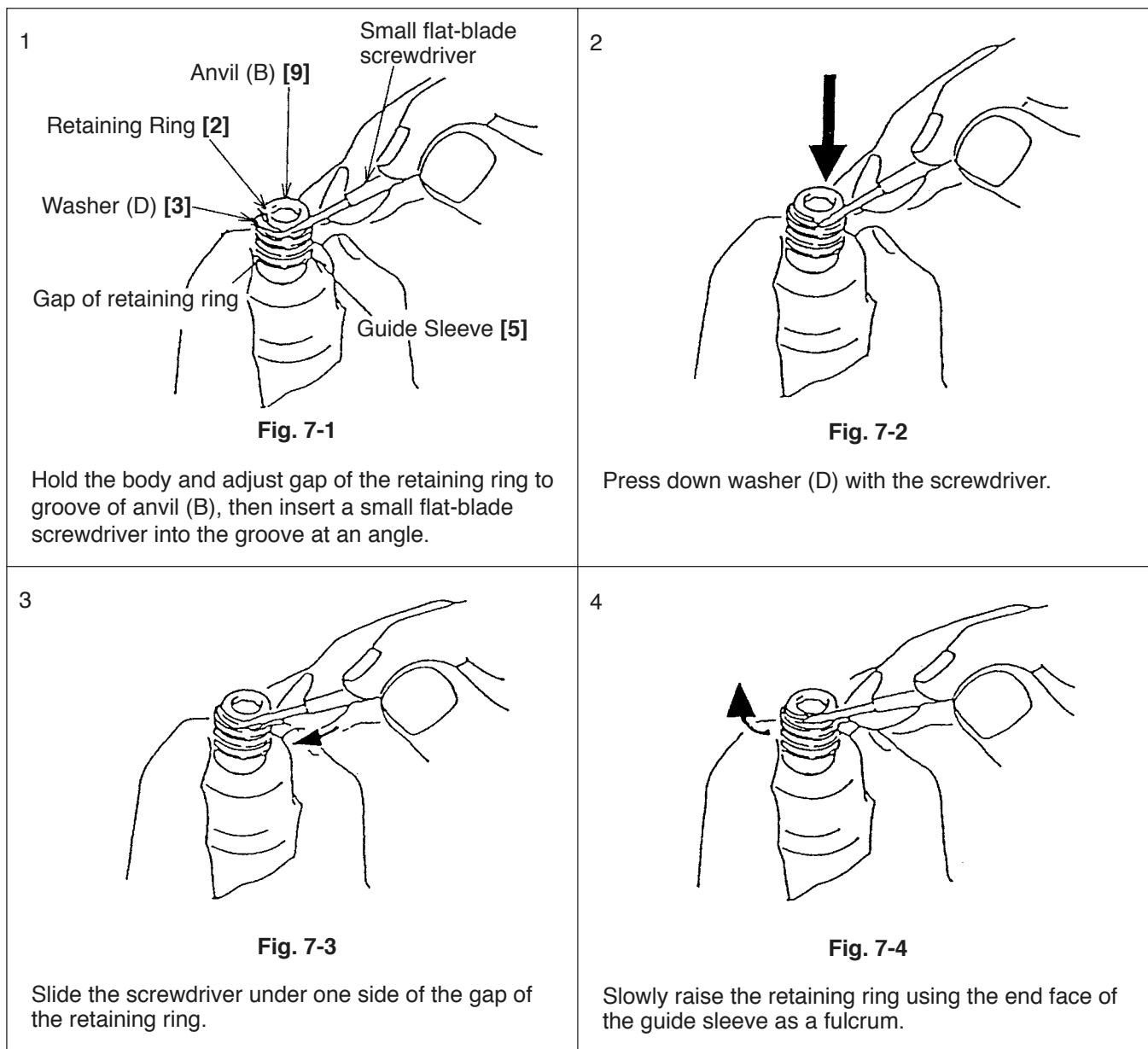

Then slowly raise the other side of the retaining ring with a screwdriver until it is free. The Guide Sleeve [5] can now be removed. Avoid quickly raising the retaining ring or it may fly out forcefully.

The retaining ring can also be easily removed by widening the gap of the retaining ring with the jig for retaining ring and slowly raising the retaining ring with a small flat-blade screwdriver.

(7) Disassembly of the hammer assembly

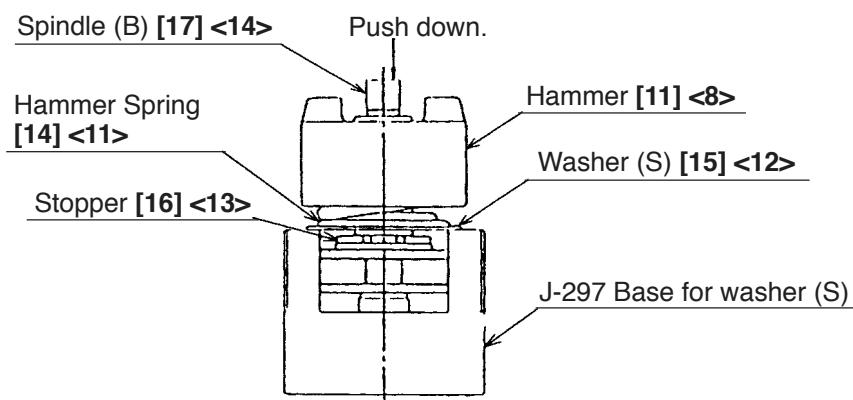

Fig. 8

Mount the hammer assembly onto the J-297 base for washer (S). With a hand press, push down the top of Spindle (B) [17] <14> to compress the Hammer Spring [14] <11>. In this position, remove the Stopper [16] <13> with a flat-blade screwdriver, then release the hand press. (See Fig. 8.)

Remove the hammer assembly from the J-297 base for washer (S) and support the end surface of Spindle (B) [17] <14>. With a hand press, push down either of the raised faces of the Hammer [11] <8> to compress the Hammer Spring [14] <11>. In this position, extract the two Steel Balls D5.556 [10] <7> from the cam grooves of Spindle (B) [17] <14> and the Hammer [11] <8> with a small flat-blade screwdriver or a similar tool. Then, slowly release the hand press and lift the Hammer [11] <8> and Washer (S) [15] <12> together to extract them from Spindle (B) [17] <14>. The Hammer Spring [14] <11> can then be removed.

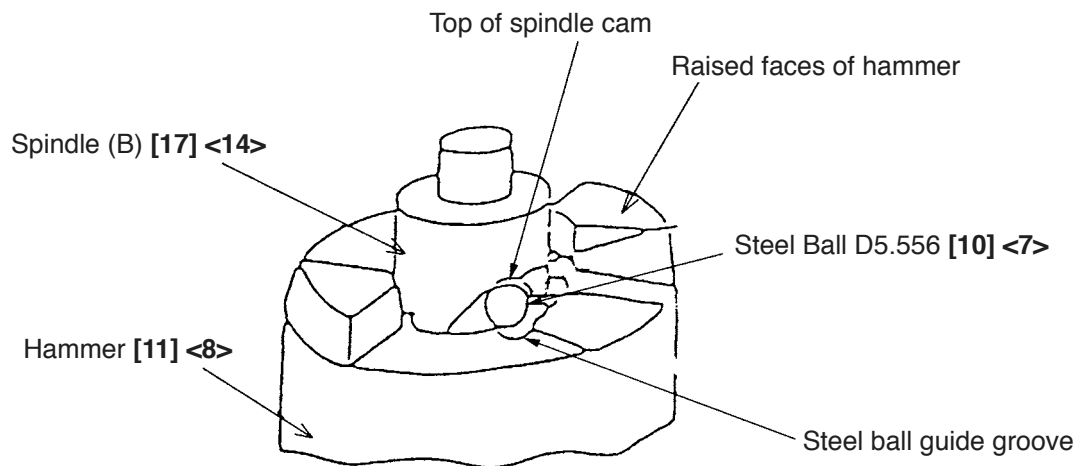

Fig. 9

10-1-2. Reassembly

Reassembly can be accomplished by following the disassembly procedures in reverse. However, special attention should be given to the following items.

(1) Reassembly of housing (A) assembly

- (a) Be sure to follow the wiring diagram (Fig. 10) for proper wiring.
- (b) Pay attention to the polarity of the Motor [26] <23> when soldering the Internal Wire (Red) 115L [27] <24> and Internal Wire (Black) 60L [28] <25> to the Motor [26] <23>. The red-marked side of the Motor [26] <23> is positive.
- (c) When mounting the Motor [26] <23> into housing (A), pay attention to the position of the Internal Wire (Red) 115L [27] <24> and the depression for preventing motor body from rotating in housing (A).

NOTE: Make sure that the Internal Wire (Red) 115L [27] <24> is passed under the motor so that it is not caught between the motor and housing (A).

- (d) Mount the DC-Speed Control Switch [32] <30> to housing (A) so that the projection of the forwarding/reversing lever at the top of the switch is inserted into the U-shaped groove of the Pushing Button [33] <31>. Secure the Fin [42] <38> to the FET of the DC-Speed Control Switch [32] <30> with the Machine Screw (W/Sp. Washer) M3 x 4 [41] <37>.

NOTE: Make sure that the three internal wires from the FET are passed above the DC-Speed Control Switch [32] <30>. To avoid pinching, be careful not to place the internal wire of the battery terminal on the terminal plate of the DC-Speed Control Switch [32] <30>.

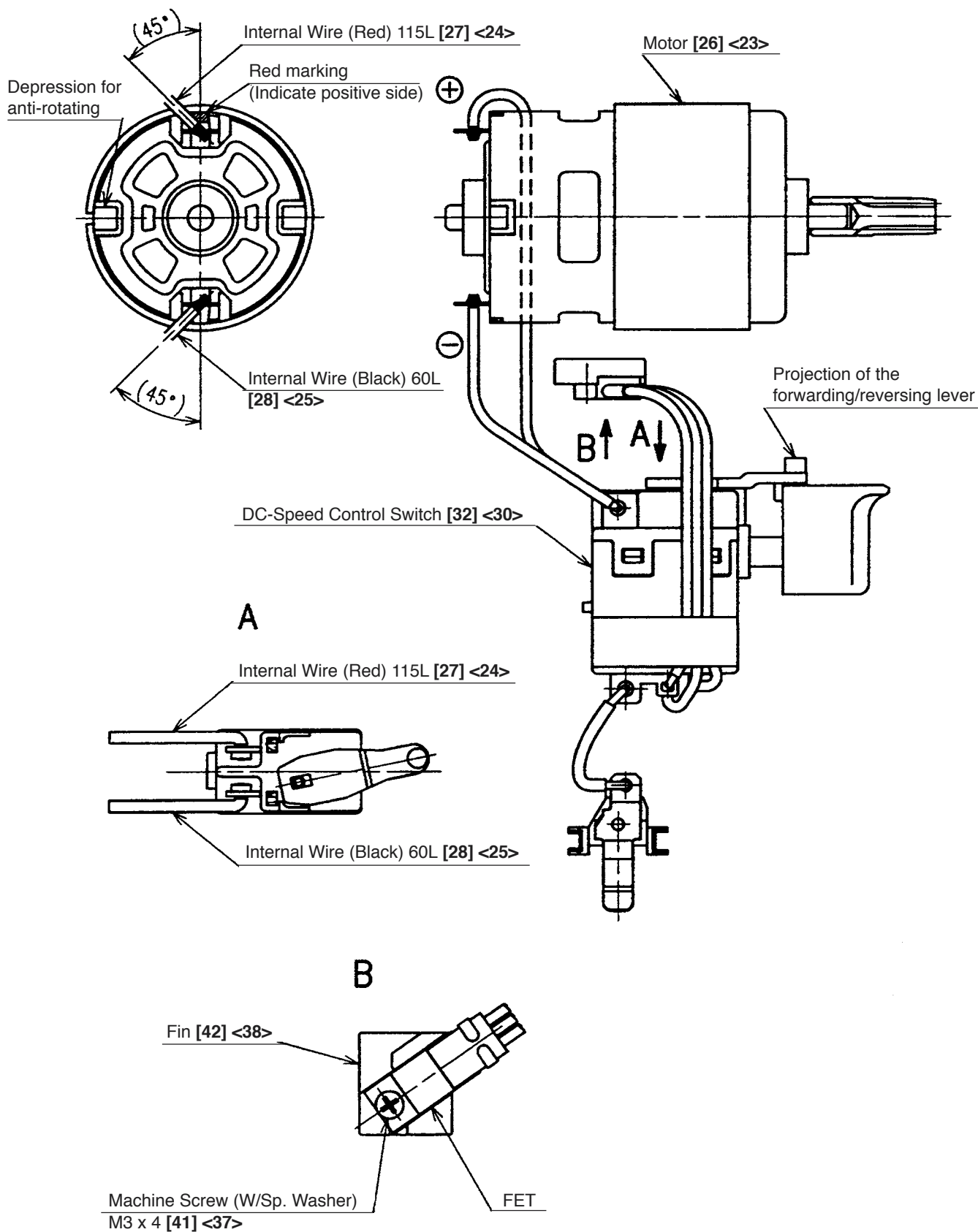

Fig. 10

(2) Reassembly of Housing (A).(B) Set [31] <28>

Mount the Strap (Black) [39] <35> and housing (B) to housing (A), and secure them with the seven Tapping Screws (W/Flange) D4 x 20 (Black) [29] <26>.

(3) Reassembly of the mechanical parts

- (a) Put Washer (S) [15] <12> onto the shaft of Spindle (B) [17] <14> and mount the Hammer [11] <8> containing the twenty-eight Steel Balls D3 [12] <9>, Washer (J) [13] <10> and the Hammer Spring [14] <11> to Spindle (B) [17] <14>.
- (b) Align the top of the cam groove on Spindle (B) [17] <14> with the steel ball guide groove on the Hammer [11] <8> as illustrated in Fig. 9. Press down either of the raised faces of the Hammer [11] <8> with a hand press to compress the Hammer Spring [14] <11> until the end surface of the hammer contacts the flange of Spindle (B) [17] <14> .
- (c) Insert the two Steel Balls D5.556 [10] <7> into the steel ball guide groove. Check that the steel balls are properly inserted in the cam groove. Then release the hand press.
- (d) Mount the hammer assembly onto the J-297 base for washer (S). With a hand press, push down the top of Spindle (B) [17] <14> to compress the Hammer Spring [14] <11>. On this condition, mount the Stopper [16] <13> onto the spindle shaft and then release the hand press.
- (e) Mount the Ring Gear [20] <17>, Washer (E) [21] <18>, Ball Bearing 6901VVCMP2L [22] <19>, Inner Cover [23] <20>, Damper [24] <21> and the Retaining Ring [25] <22> to the above reassembly. Furthermore, mount the other mechanical parts and the Anvil [9] <6>, then the Hammer Case [7] <3>.

(4) Mounting the Gear Box Ass'y [1] <1> to the housing

Coat Housing (A).(B) Set [31] <28> with Silicon Rubber (THREEBOND 1211) as shown in Fig. 11. Mount the Gear Box Ass'y [1] <1> so that the pinion press-fitted in the Motor [26] <23> properly meshes with the Idler Gear Set [18] <15>. Check that the Anvil [9] <6> turns smoothly. If not, the gear meshes improperly. Check the meshing condition. Tighten the four Tapping Screws (W/Sp. Washer) D4 x 40 [6] <2>. Wipe the silicon rubber protruded from the housing with a cloth.

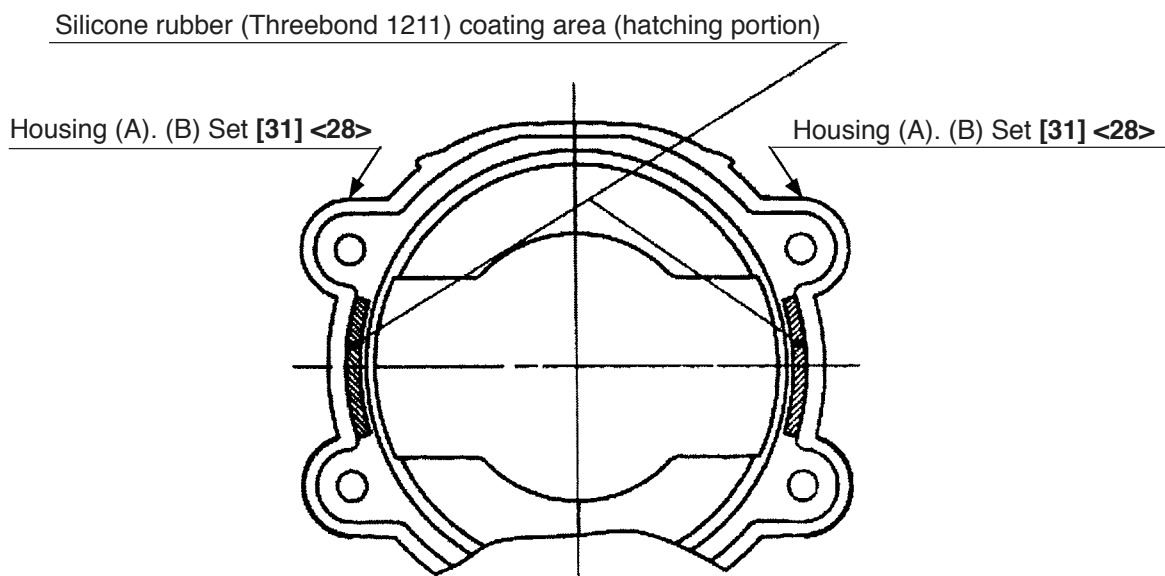

Fig. 11

(5) Reassembly of the Guide Sleeve [5] (Model WH 12DAF2 only)

Insert the Steel Ball D3.5 [8] into the hole of the Anvil [9]. Mount the Guide Sleeve [5], the Guide Spring [4] and Washer (D) [3] in sequence. Mount the Retaining Ring [2] into the groove of the anvil using J-295 jigs (A) and (B) for retaining ring as illustrated in Fig. 9.

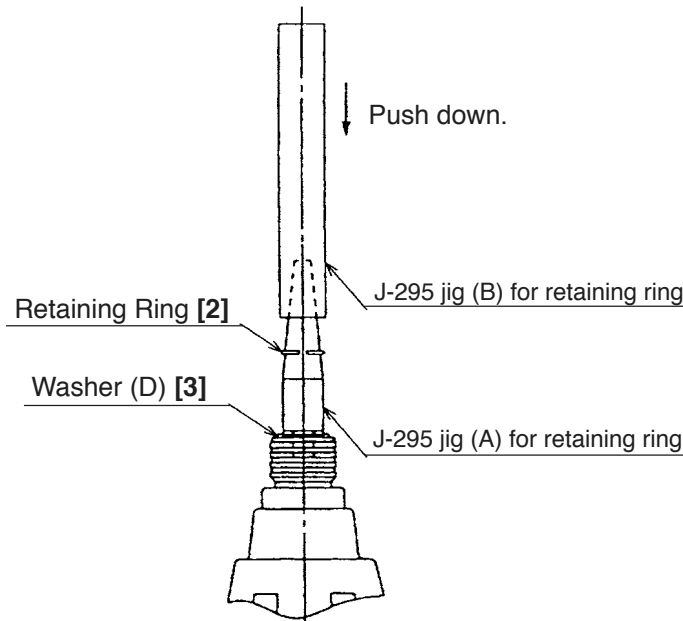

Fig. 12

(6) Reassembly of the Hook Ass'y (W/Light) [36] <32>

Check that the V-Lock Nut M5 [38] <34> is mounted to the Hook Ass'y (W/Light) [36] <32>. Then mount the Hook Spring [43] <39> and secure it with the Special Screw M5 [44] <40>. (Mount the Hook Spring [43] <39> with its larger-diameter side pointing toward the inside of the housing.)

(7) Check whether the direction of rotation of the Anvil [9] <6> coincides with the directional markings on the push-on side of the Pushing Button [33] <31>. When the Pushing Button [33] <31> is turned to the (R) side, the direction of rotation of the Anvil [9] <6> should be clockwise, as viewed from behind.

(8) Lubrication

(a) ATTOLUB MS No. 2

- Cam groove and sliding section of Spindle (B) [17] <14>
- Cam groove and projection of the Hammer [11] <8>
- 8 mm diameter hole and oil groove and upper surface of the claw of the Anvil [9] <6>
- Sliding section between the Anvil [9] <6> and the metal
- Two Steel Balls D5.556 [10] <7>
- Pinion tooth flanks and front metal of the Motor [26] <23>
- Tooth flanks of the Ring Gear [20] <17>
- Twenty-eight Steel Balls D3 [12] <9>
- Needle Roller [19] <16>
- Tooth flanks and 5 mm diameter hole of the Idle Gear Set [18] <15>

(b) HITACHI MOTOR GREASE No. 29 (Model WH 12DAF2 only)

- Steel Ball D3.5 [8]
- Sliding section of the Anvil [9] and the Guide Sleeve [5]

(9) Screw tightening torque

- Tapping Screw (W/Sp. Washer) D4 x 40 **[6] <2>** $1.96 \pm 0.49 \text{ N}\cdot\text{m}$ ($20 \pm 5 \text{ kgf}\cdot\text{cm}$, $17.4 \pm 4.3 \text{ in}\cdot\text{lbs.}$)
- Tapping Screw (W/Flange) D4 x 20 (Black) **[29] <26>**·· $1.96 \pm 0.49 \text{ N}\cdot\text{m}$ ($20 \pm 5 \text{ kgf}\cdot\text{cm}$, $17.4 \pm 4.3 \text{ in}\cdot\text{lbs.}$)
- Machine Screw (W/Sp. Washer) M3 x 4 **[41] <37>** $0.29 - 0.39 \text{ N}\cdot\text{m}$ ($3 - 4 \text{ kgf}\cdot\text{cm}$, $2.6 - 3.5 \text{ in}\cdot\text{lbs.}$)
- Special Screw M5 **[44] <40>** $1.96 \pm 0.49 \text{ N}\cdot\text{m}$ ($20 \pm 5 \text{ kgf}\cdot\text{cm}$, $17.4 \pm 4.3 \text{ in}\cdot\text{lbs.}$)

10-2. Precautions in Disassembly and Reassembly of Battery Charger

Refer to the Technical Data and Service Manual for precautions in disassembly and reassembly of the Model UC 14YFA or UC 18YG Battery Charger.

11. STANDARD REPAIR TIME (UNIT) SCHEDULES

For Model WH 12DAF2

MODEL	Variable		10	20	30	40	50	60 min.
	Fixed							
WH 12DAF2		Work Flow						
		Hook Ass'y		DC-Speed Control Switch				
					Housing (A).(B) Set			
				Inner Cover Damper Motor				
		General Assembly						
		Guide Sleeve		Hammer Case Anvil Ring Gear	Hammer Steel Ball Hammer Spring Spindle Idle Gear Set Needle Roller Ball Bearing (6901VV)			
		Gear Box Ass'y						

For Model WR 12DAF2

MODEL	Variable		10	20	30	40	50	60 min.
	Fixed							
WR 12DAF2		Work Flow						
		Hook Ass'y		DC-Speed Control Switch				
					Housing (A).(B) Set			
		Inner Cover Damper Motor						
	General Assembly							
				Hammer Case Pin Retainer Plunger Anvil Ring Gear	Hammer Steel Ball Hammer Spring Spindle Idle Gear Set Needle Roller Ball Bearing (6901VV)			
		Gear Box Ass'y						

ELECTRIC TOOL PARTS LIST

CORDLESS IMPACT DRIVER
Model WH 12DAF2

2005 • 8 • 10
(E1)

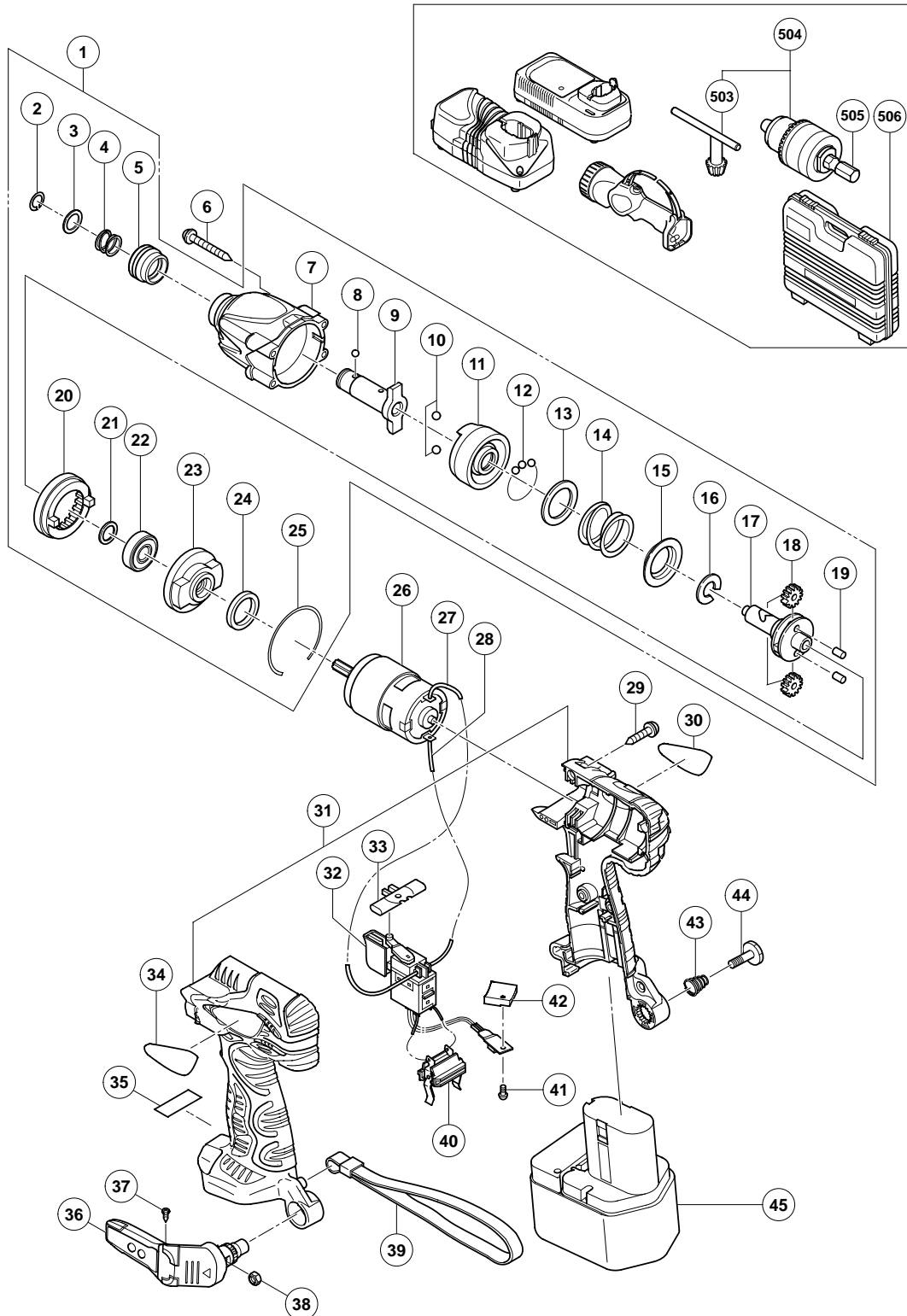

PARTS

WH 12DAF2

ITEM NO.	CODE NO.	DESCRIPTION	NO. USED	REMARKS	
* 1	324-854	GEAR BOX (B) ASS'Y	1	INCLUD. 2-5, 7-25	
* 1	323-939	GEAR BOX (B) ASS'Y	1	INCLUD. 2-5, 7-25 FOR TPE, CHN, SIN, KOR, HKG	
2	315-984	RETAINING RING	1		
3	315-983	WASHER (D)	1		
4	320-409	GUIDE SPRING	1		
5	323-954	GUIDE SLEEVE	1		
6	992-630	TAPPING SCREW (W/SP. WASHER) D4X40	4		
7	323-940	HAMMER CASE	1		
8	319-535	STEEL BALL D3.5 (10 PCS.)	1		
* 9	321-915	ANVIL (B)	1		
* 9	321-884	ANVIL	1	FOR TPE, CHN, SIN, KOR, HKG	
10	959-154	STEEL BALL D5.556 (10 PCS.)	2		
11	323-949	HAMMER	1		
12	321-934	STEEL BALL D3 (10 PCS.)	28		
13	315-978	WASHER (J)	1		
14	323-944	HAMMER SPRING	1		
15	316-172	WASHER (S)	1		
16	316-171	STOPPER	1		
17	323-945	SPINDLE (B)	1		
18	323-941	IDLE GEAR SET (2 PCS.)	2		
19	323-942	NEEDLE ROLLER	2		
20	323-946	RING GEAR	1		
21	319-911	WASHER (E)	1		
22	690-1VV	BALL BEARING 6901VVCMP2L	1		
23	323-947	INNER COVER	1		
24	321-894	DAMPER	1		
25	321-893	RETAINING RING	1		
26	323-948	MOTOR	1		
27	321-876	INTERNAL WIRE (RED) 115L	1		
28	321-877	INTERNAL WIRE (BLACK) 60L	1		
29	302-086	TAPPING SCREW (W/FLANGE) D4X20 (BLACK)	7		
30		NAME PLATE	1		
31	324-855	HOUSING (A).(B) SET	1		
32	321-917	DC-SPEED CONTROL SWITCH	1		
33	321-871	PUSHING BUTTON	1		
34		HITACHI LABEL	1		
* 35		CAUTION PLATE (B)	1	FOR USA, CAN	
36	321-918	HOOK ASS'Y (W/LIGHT)	1	INCLUD. 37, 38	
37	321-672	TAPPING SCREW D2X6	2		
38	320-288	V-LOCK NUT M5	1		
39	306-952	STRAP (BLACK)	1		
40	323-710	TERMINAL SUPPORT	1		
41	320-777	MACHINE SCREW (W/SP. WASHER) M3X4	1		
42	320-776	FIN	1		
43	319-926	HOOK SPRING	1		
44	319-927	SPECIAL SCREW M5	1		
* 45	322-629	BATTERY EB 1214S (W/ENGLISH N.P.)	2		
* 45	324-360	BATTERY EB 1214S (W/ENGLISH N.P.)	2	FOR USA, CAN	
* 45	324-361	BATTERY EB 1214S (W/ENGLISH N.P.)	2	FOR TPE	
* 45	320-387	BATTERY EB 1220BL (W/ENGLISH N.P.)	2		
* 45	323-226	BATTERY EB 1226HL (W/ENGLISH N.P.)	2		

WH 12DAF2

*
*
*
*
*
*
*
*

ELECTRIC TOOL PARTS LIST

■ **CORDLESS IMPACT WRENCH** 2005 • 8 • 30
Model WR 12DAF2 (E1)

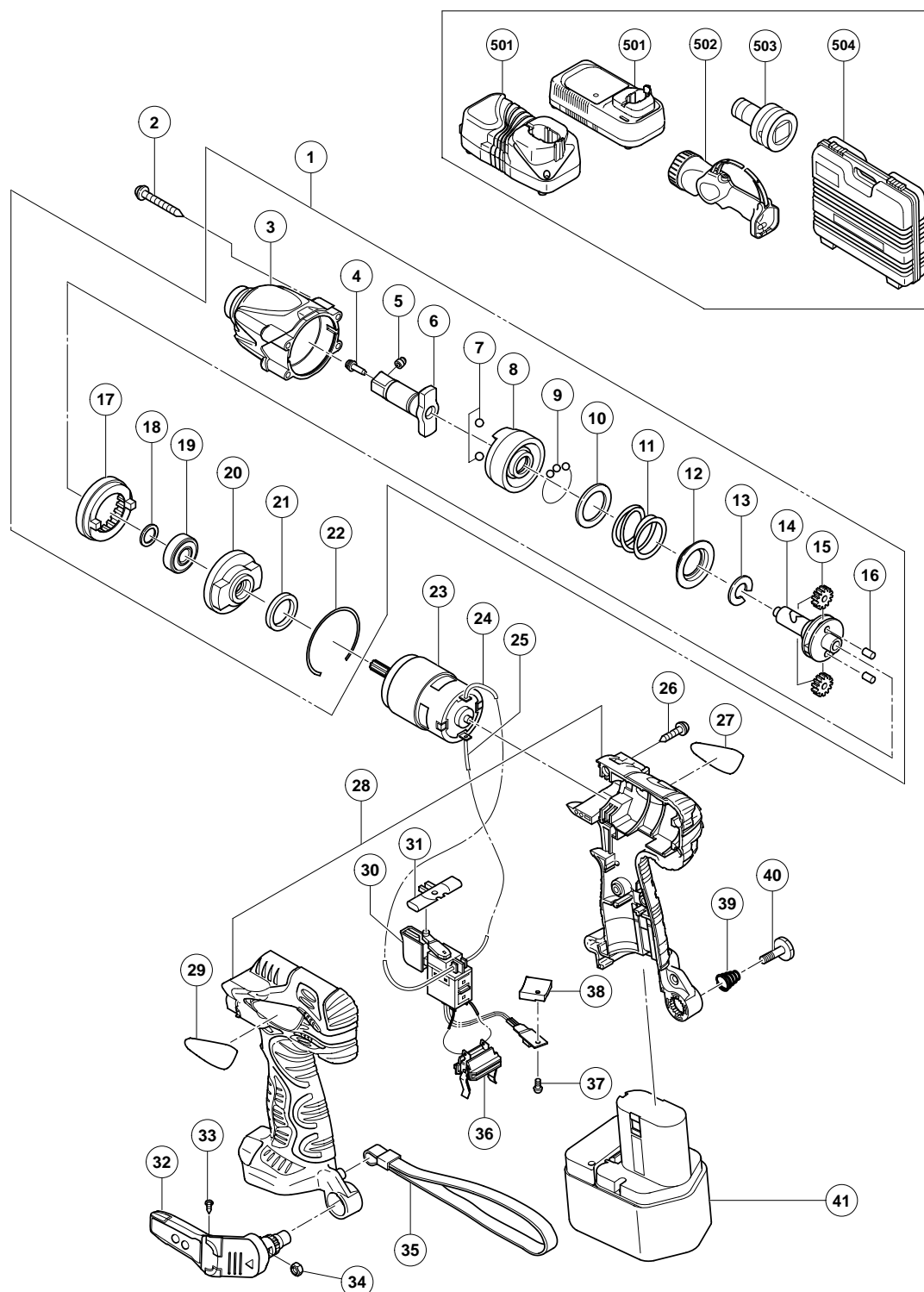

PARTS

WR 12DAF2

ITEM NO.	CODE NO.	DESCRIPTION	NO. USED	REMARKS	
1	324-856	GEAR BOX (C) ASS'Y	1	INCLUD. 3, 6-22	
2	992-630	TAPPING SCREW (W/SP. WASHER) D4X40	4		
3	324-857	HAMMER CASE	1		
4	323-194	PIN RETAINER	1		
5	323-193	PLUNGER	1		
6	323-192	ANVIL (C) ASS'Y	1	INCLUD. 4, 5	
7	959-154	STEEL BALL D5.556 (10 PCS.)	2		
8	323-949	HAMMER	1		
9	321-934	STEEL BALL D3 (10 PCS.)	28		
10	315-978	WASHER (J)	1		
11	323-944	HAMMER SPRING	1		
12	316-172	WASHER (S)	1		
13	316-171	STOPPER	1		
14	323-945	SPINDLE (B)	1		
15	323-941	IDLE GEAR SET (2 PCS.)	2		
16	323-942	NEEDLE ROLLER	2		
17	323-946	RING GEAR	1		
18	319-911	WASHER (E)	1		
19	690-1VV	BALL BEARING 6901VVCMP52L	1		
20	323-947	INNER COVER	1		
21	321-894	DAMPER	1		
22	321-893	RETAINING RING	1		
23	323-948	MOTOR	1		
24	321-876	INTERNAL WIRE (RED) 115L	1		
25	321-877	INTERNAL WIRE (BLACK) 60L	1		
26	302-086	TAPPING SCREW (W/FLANGE) D4X20 (BLACK)	7		
27		NAME PLATE	1		
28	324-855	HOUSING (A).(B) SET	1		
29		HITACHI LABEL	1		
30	321-917	DC-SPEED CONTROL SWITCH	1		
31	321-871	PUSHING BUTTON	1		
32	321-918	HOOK ASS'Y (W/LIGHT)	1	INCLUD. 33, 34	
33	321-672	TAPPING SCREW D2X6	2		
34	320-288	V-LOCK NUT M5	1		
35	306-952	STRAP (BLACK)	1		
36	323-710	TERMINAL SUPPORT	1		
37	320-777	MACHINE SCREW (W/SP. WASHER) M3X4	1		
38	320-776	FIN	1		
39	319-926	HOOK SPRING	1		
40	319-927	SPECIAL SCREW M5	1		
* 41	322-629	BATTERY EB 1214S (W/ENGLISH N.P.)	2		
* 41	324-361	BATTERY EB 1214S (W/ENGLISH N.P.)	2	FOR TPE	
* 41	320-387	BATTERY EB 1220BL (W/ENGLISH N.P.)	2		
* 41	323-226	BATTERY EB 1226HL (W/ENGLISH N.P.)	2		

WR 12DAF2

[illegible]

OPTIONAL ACCESSORIES

ITEM NO.	CODE NO.	DESCRIPTION	NO. USED	REMARKS	
601		CORNER ATTACHMENT ASS'Y	1	INCLUD. 602-618	
602	955-300	HOUSING	1		
603	955-301	METAL	3		
604	955-302	SPINDLE	1		
605		HITACHI LABEL	1		
606	955-303	BEARING RACE	2		
607	955-304	NEEDLE THRUST BEARING (NTA-1413)	2		
608	955-305	COVER	1		
609	955-306	NEEDLE BEARING (NTN BK1012)	1		
610	948-227	RETAINING RING FOR D47 HOLE	1		
611	955-307	PINION	1		
612	955-308	SLEEVE	1		
613	955-309	WASHER	1		
614	955-310	SOCKET COVER	1		
615	955-311	SOCKET	1		
616	303-247	SEAL LOCK HEX. SOCKET HD. BOLT M5X25	6		
617	873-537	SOCKET PIN	1		
618	873-187	O-RING (J1SW1516)	1		
619	991-481	FORM TIE SOCKET ASS'Y 11.3MMX95L	1	INCLUD. 617, 618	
620	992-610	UNIVERSAL JOINT ASS'Y	1	INCLUD. 617, 618	
621	955-153	UNIVERSAL JOINT PIN	1		
622	991-476	BIT ADAPTER ASS'Y	1	INCLUD. 617, 618	
623	944-291	HEX. SOCKET ASS'Y 10MMX40L	1	INCLUD. 617, 618	
624	873-632	HEX. SOCKET ASS'Y 12MMX40L	1	INCLUD. 617, 618	
625	873-539	HEX. SOCKET ASS'Y 13MMX40L	1	INCLUD. 617, 618	
626	873-540	HEX. SOCKET ASS'Y 14MMX40L	1	INCLUD. 617, 618	
627	873-536	HEX. SOCKET ASS'Y 17MMX32L	1	INCLUD. 617, 618	
628	873-624	HEX. SOCKET ASS'Y 19MMX34L	1	INCLUD. 617, 618	
629	873-626	HEX. SOCKET ASS'Y 21MMX36L	1	INCLUD. 617, 618	
630	873-627	HEX. SOCKET ASS'Y 22MMX40L	1	INCLUD. 617, 618	
631	955-138	HEX. SOCKET ASS'Y (LONG) 12MMX52L	1	INCLUD. 617, 618	

OPTIONAL ACCESSORIES

WR 12DAF2

[illegible]

