

# TECHNICAL INFORMATION

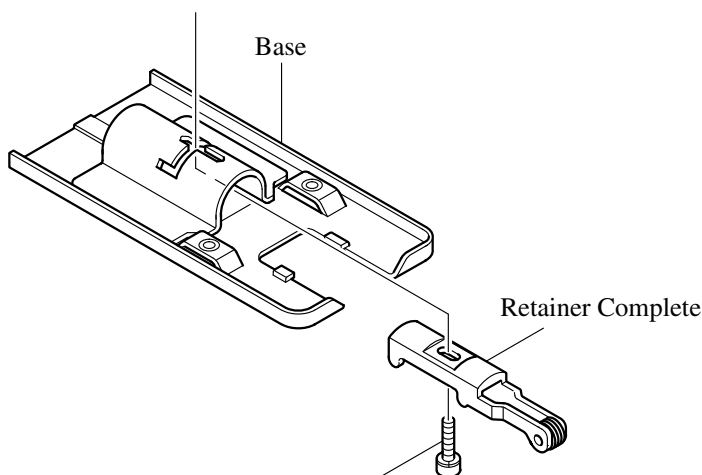

61994

- Subject** ▶ Change of Hex. Socket Head Bolt
- For Models** ▶ 4322, 4322M, 4323, 4323M, 4324
- Country** ▶ All countries
- Description** ▶ For standardization, Part No. of Hex. Socket Head Bolt M4x16 has been changed from 266178-1 to 922128-3. However, the Hex. Socket Head Bolt itself remains unchanged.



**Part No. of this Hex. Socket Head Bolt M4x16 has been changed from 266178-1 to 922128-3.**

## Interchangeability(I/C)

Item No.	Current part		Q'ty	I/C	New part		Q'ty	Note
See note below.	Hex. Socket Head Bolt M4x16 266178-1		1	Yes	Hex. Socket Head Bolt M4x16 922128-3		1	

## Note

Model	4322	4322M	4323	4323M	4324
Item No.	017	017	017	017	046

## Implementation

4322 : From serial No. 46603E (Sep., 2000)  
 4322M: From serial No. 1691E (Sep., 2000)  
 4323 : From serial No. 171122E (Sep., 2000)  
 4323M: From serial No. 6402E (Sep., 2000)  
 4324 : From serial No. 88803E (Sep., 2000)