

T ECHNICAL INFORMATION



New Tool

Models No. ▶ 5103R

Description ▶ 270 mm (10-5/8") Circular Saw

CONCEPTION AND MAIN APPLICATIONS

Model 5103R is a redesigned version of the existing Model SR2600.

It is equipped with a riving knife, larger base, more efficient chip/sawdust ejection port, soft-start feature, electric brake, etc.

Guide rail and guide rail adapter are available as optional accessories.

Model 5103R complies with CENELEC Standard.

It is offered to European countries and areas only.

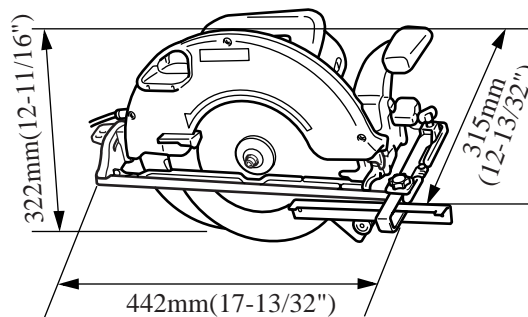

► Specifications

Voltage (V)	Current (A)	Cycle (Hz)	Continuous Rating (W)		Max. Output(W)
			Input	Output	
100	15.0	50/60	1,430	800	2,400
110 (for U.K.)	20.0	50/60	2,100	1,250	2,400
115	15.0	50/60	1,650	900	2,400
220	10.0	50/60	2,100	1,350	3,300
230	9.6	50/60	2,100	1,350	3,300
240	9.2	50/60	2,100	1,350	3,300

Blade diameter		270 mm (10-5/8")
Arbor diameter		30 mm (1-3/16")
Max. cutting capacities	At 90°	100 mm (3-15/16")
	At 45°	73 mm (2-7/8")
No load speed		3,800R/min
Net weight		9.4 kg (20.7 lbs)

► Standard equipment

Rip fence (guide rule), Hex wrench 6, Carbide-tipped saw blade 270

► Optional accessories

Carbide-tipped saw blade 270, Joint set, Guide rail, Guide rail adapter

► Features and benefits

1. Double insulated
2. For further information, see information sheet which we will send you later.

The standard equipment for the tools shown may differ from country to country

Electric brake and soft-start features for more efficient operation

Large ejection port for smooth chip/sawdust outflow; readily accepts joint for dust collection

Less noise than FESTO AP85E
5103R :85db
AP85E :85db

Sturdy aluminum base and angular guides for smooth cutting

Adjustable top guide for aligning the cutting line

▽ marking to indicate the front edge of saw blade

Rollers for smooth, scratch-free action over surface of material

Graduations for depth of cut

Hex wrench can be stored here

Handy carrying handle

Easy-to-operate lever for adjusting the depth of cut

Flat surface for easy replacement of blades

Peep window to check if blade edge is aligned with cutting line.
Motor cooling air passes through this peep window and blows away sawdust around cutting line

Guide rail adapter is available as an optional accessory. MAKITA or FESTO guide rail can be used with this guide rail adapter.

