

T ECHNICAL INFORMATION



63646
(Page 1 of 2)

Subject ▶ Change of Housing, Set Plate, etc.

For Models ▶ 6095D

Country ▶ European countries

Description ▶ See below.

1. Housing without rubber has been replaced by one with rubber.
2. Set Plate with cushion has been replaced by one without cushion.
3. Pin 3 has been added.
4. Rubber Pin 6 has been added.
5. Makita Label has been added.
6. Pan Head Screws M4x22 (Item No. 001) have been replaced by Tapping Screws 4x18.
Pan Head Screws M4x35 (Item No. 002) have been replaced by Tapping Screws 4x30.
7. Holder 6 has been eliminated.
8. Keyless Drill Chuck 10 has been changed.

Note: This Technical Information applies to machines manufactured in MME (Makita Manufacturing Europe Ltd.) only.

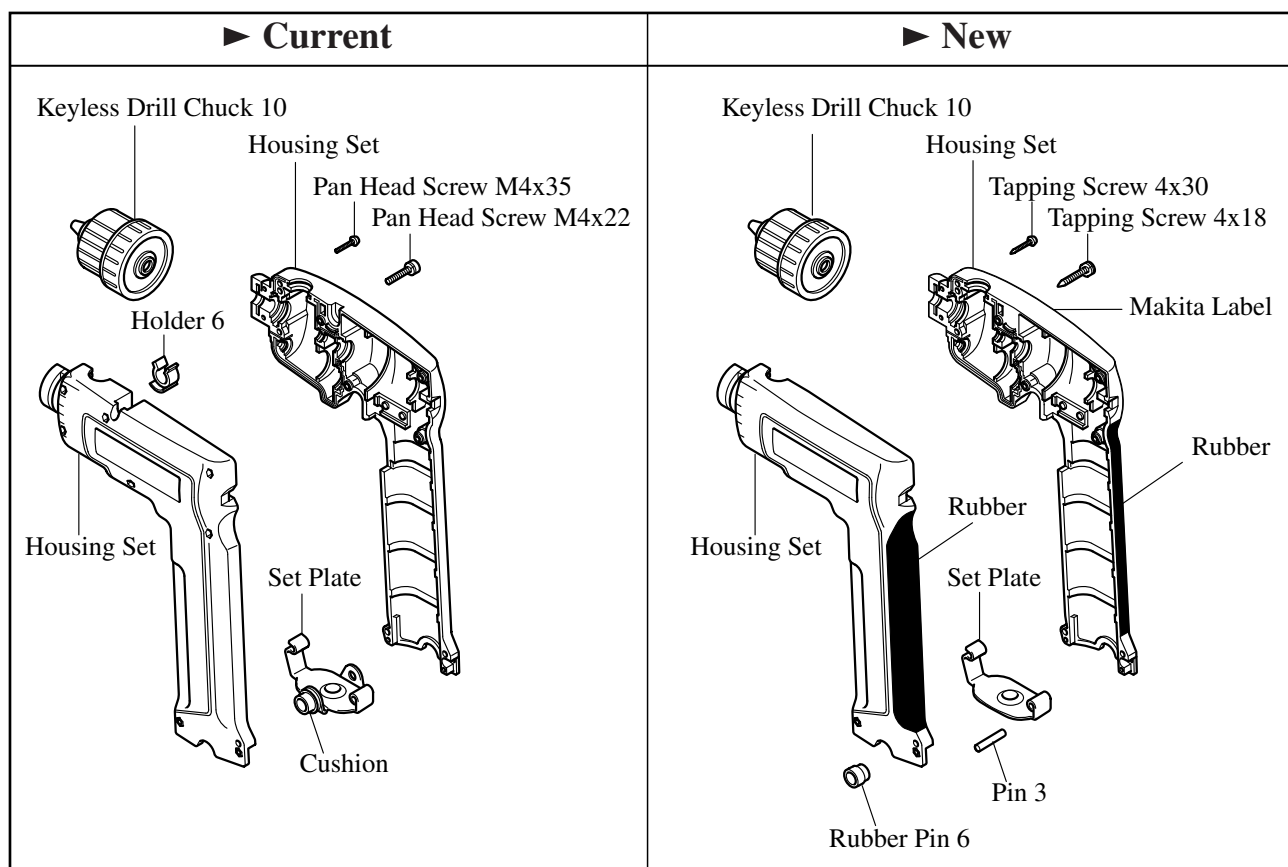

Interchangeability(I/C)

Item No.	Current part		Q'ty	I/C	New part		Q'ty	Note
003 044	Housing Set 182803-5		1	No	Housing Set 183196-3		1	<div style="text-align: center;"> ↑ Interchangeable as a set ↓ </div>
049					Pin 3 256158-5		1	
050					Rubber Pin 6 263022-3		2	
051					Makita Label 819063-3		1	
001	Pan Head Screw M4x22 911143-2		6	No	Tapping Screw 4x18 265995-6		6	
002	Pan Head Screw M4x35 911163-6		2	No	Tapping Screw 4x30 266050-7		2	
043	Holder 6 411640-3		1				—	
047	Set Plate 163157-9		1	No	Set Plate 344549-3		1	
008	Keyless Drill Chuck 10 192016-0		1	Yes	Keyless Drill Chuck 10 763154-1		1	

Note

Use the Pt. No. 182141-5 instead of Pt. No. 182803-5 when you place an order for the current Housing Set.

Implementation

From serial No. 543419G (Sep., 2000)