

Subject ▶ Change on spindle

For Models ▶ 6904VH, 6904H (Impact Wrench) and 6904V (Impact Driver)

Description ▶ The spindle will be changed as follows.

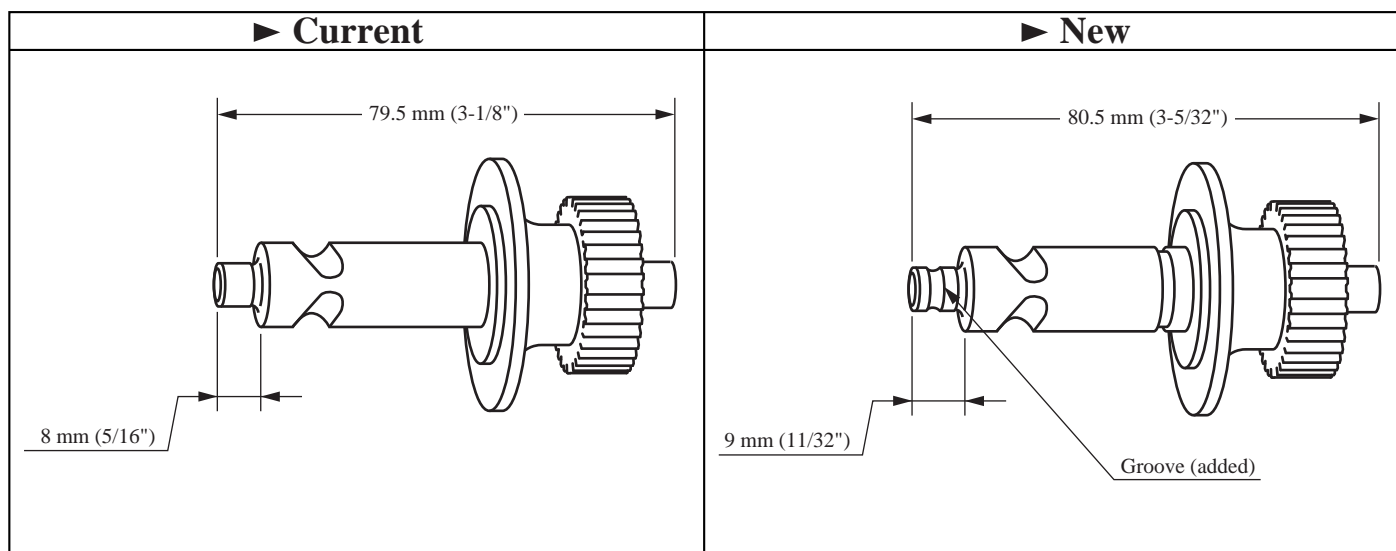

Interchangeability(I/C)

Item No.	Current part		Q'ty	I/C	New part		Q'ty	Note
	Spindle 153210-9		1	Yes	Spindle 153210-9		1	

Implementation

6904VH: From serial No. 7865E

6904H : From serial No. 1137E

6904V : From serial No. 1530E