

Subject ► Change on ball bearing, etc.

For Models ► 6904VH, 6904H (Impact Wrench) and 6904V (Impact Driver)

- Description** ►
1. The ball bearing 608VV with outer diameter 22 mm (7/8") will be re-placed by a ball bearing 609LLB with outer diameter 24 mm (15/16").
 2. The plane bearing 6 will be changed from 10 mm (13/32") to 12 mm(15/32") in outer diameter.
 3. The housing will be changed as follows.
 - i) Ribs will be added to the portions around the bearings.
 - ii) The dimensions of portions to accept the bearings will be changed.
 4. The portion of spindle to be inserted into the ball bearing will be changed from 8 mm (5/16") to 9 mm (11/32") in diameter.
 5. The flat washer 16 will be replaced by a flat washer 18.
 6. The O ring 17 will be replaced by an O ring 20.

The above Nos. corresponds to the item Nos. shown in the figure below.

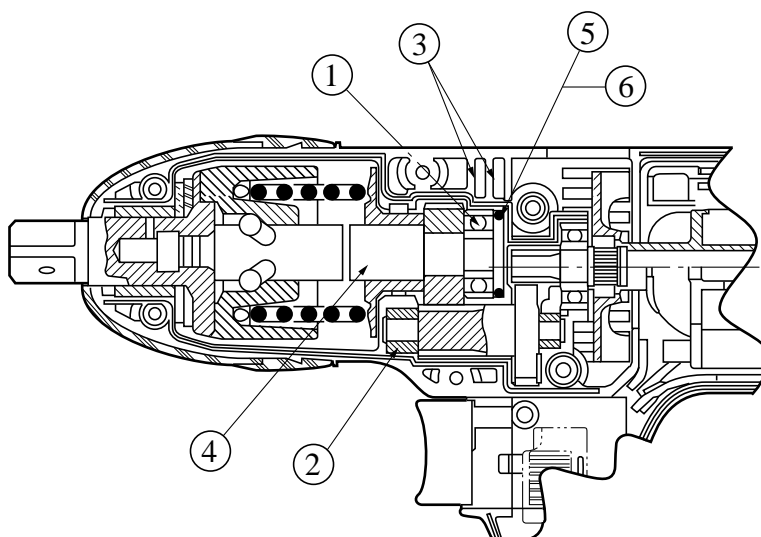

Interchangeability(I/C)

Item No.	Current part		Q'ty	I/C	New part		Q'ty	Note
8	Housing set 182444-7		1	No	Housing set 182729-1		1	For 6904VH and 6904V Interchangeable as a set
21	Ball bearing 608VV 210007-0		1	No	Ball bearing 609LLB 211051-0		1	
23	O ring 17 213261-5		1	No	Oring 20 213304-3		1	
31	Plane bearing 6 214012-9		1	No	Plane bearing 6 214033-1		1	
20	Spindle complete 153210-9		1	No	Spindle complete 153232-9		1	
22	Flat washer 16 253707-9		1	No	Flat washer 18 267106-9		1	

Interchangeability(I/C)

Item No.	Current part		Q'ty	I/C	New part		Q'ty	Note
8	Housing set 182451-0		1	No	Housing set 182728-3		1	For 6904H Interchangeable as a set
21	Ball bearing 608VV 210007-0		1	No	Ball bearing 609LLB 211051-0		1	
23	O ring 17 213261-5		1	No	Oring 20 213304-3		1	
31	Plane bearing 6 214012-9		1	No	Plane bearing 6 214033-1		1	
20	Spindle complete 153210-9		1	No	Spindle complete 153232-9		1	
22	Flat washer 16 253707-9		1	No	Flat washer 18 267106-9		1	

Implementation

6904VH : From serial No. 16733E
6904H : From serial No. 1258E
6904V : From serial No. 1933E