

Subject	Change of Flat Washer 8
For Models	8406C (Diamond Core Hammer Drill)
Description	Thickness of a Flat Washer 8(one of two) has been changed from 1mm to 0.5mm.

<NEW>

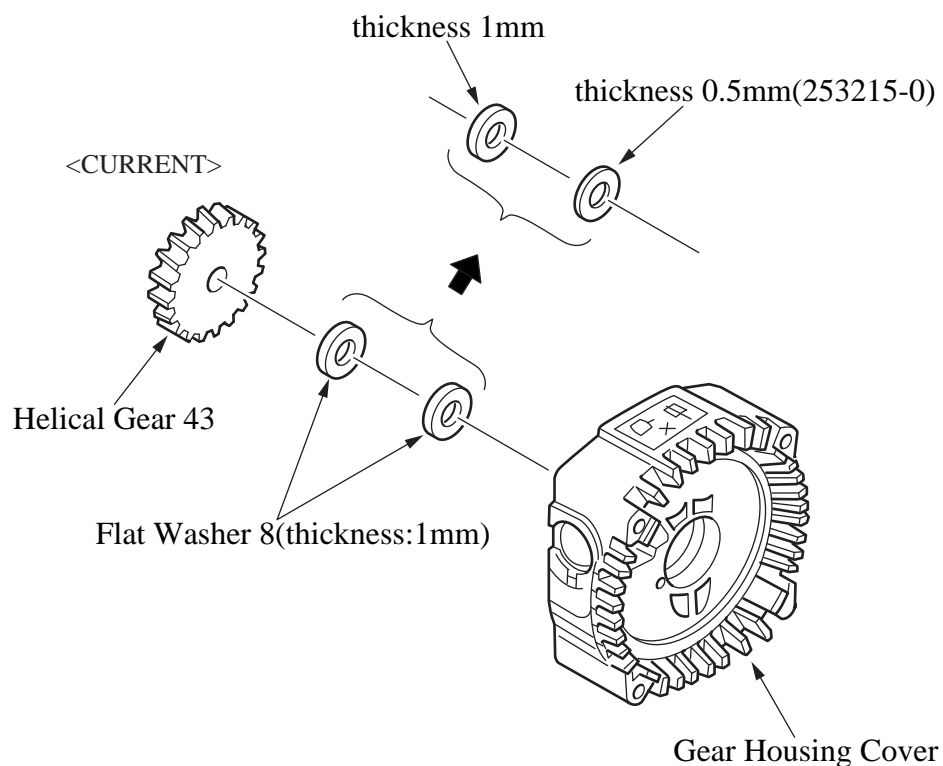

Note

Location of new Flat Washer 8 is not designated, at either side of Helical Gear or Gear Housing Cover.

Interchangeability(I/C)

Item No.	Current part		Q'ty	I/C	New part	Q'ty		Note
021	Flat washer 8 253835-0		2		Flat washer 8 253835-0	1		Please chang these parts as a set.
084					Flat washer 8 253215-0	1		

Implementation

8406C : From serial No.3754