

TECHNICAL INFORMATION



63755

- Subject** ➤ Addition of Dust Seal Washer Complete and Change of Knob Complete, Gear Housing Complete, Skirt Complete and Holder
- For Models** ➤ BO6040
- Country** ➤ All countries
- Description** ➤ Knob Complete, Gear Housing Complete, Skirt Complete and Holder have been changed so that forcible rotation/ free rotation mode can be shifted smoothly. Dust Seal Washer Complete has been added.

**Dust Seal Washer Complete
(152988-1)**



Dust Seal Washer Complete has been added here.

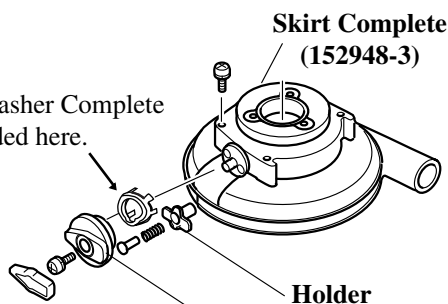

**Knob Complete
(152987-3)**

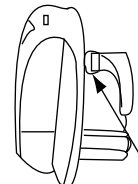

New Knob Complete has been changed in shape in this area.

► Current	► New
<p>Gear Housing Complete (152671-0)</p> <p>Space</p> <p>Skirt Complete (152948-3)</p>	<p>Gear Housing Complete (152671-0)</p> <p>No space</p> <p>Skirt Complete (152948-3)</p> <p>No space between Gear Housing Complete and Skirt Complete in this area</p>
<p>Holder (162219-0)</p> <p>Resin</p> <p>Iron sleeve</p>	<p>Holder (345209-0)</p> <p>All iron</p>

Interchangeability(I/C)

Item No.	Current part		Q'ty	I/C	New Part		Q'ty	Note
078					Dust Seal Washer Complete 152988-1		1	
016	Knob Complete 152672-8		1	←	Knob Complete 152987-3		1	
005	Gear Housing Complete 152671-0		1	←	Gear Housing Complete 152671-0		1	
020	Skirt Complete 152948-3		1	←	Skirt Complete 152948-3		1	
019	Holder 162219-0		1	←	Holder 345209-0		1	

Interchangeability mark ;

The arrow ← means that the new part can be substituted for the current.

Note

Part numbers of Gear Housing Complete and Skirt Complete remain unchanged.

Implementation

From serial No. 8646E (May, 2001)