

# T ECHNICAL INFORMATION



A5303  
August 2014

**Subject** ► Elimination of Oil pump set

**For Models** ► DOLMAR: ES-164 TLC, ES-174 TLC, ES-2131 TLC, ES-2136, ES-2136 TLC, ES-2141, ES-2141 TLC, ES-34 TLC, ES-39 TLC, ES-43 TLC, AS-3726, AS-3731  
Makita: DUC252, DUC302, UC3041A, UC3050A, UC3051A, UC3541A, UC3550A, UC3550AP, UC3551A, UC4041A, UC4050A, UC4051A, UC4550A, UC4551A, XCU02

**Country** ► All countries

**Description** ► Oil pump set has been eliminated.  
Oil pump complete and Worm gear are the alternatives as shown below.

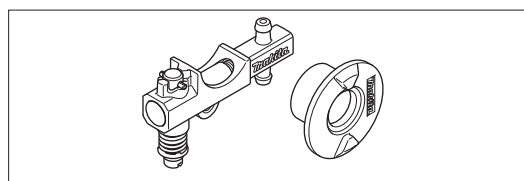

Oil pump set  
(196419-0)

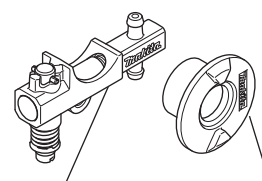

Oil pump complete  
(142156-4)



Worm gear  
(221427-3)

## Interchangeability(I/C)

Item No.	Current part		Q'ty	I/C	New part		Q'ty	Note
See Note.	Oil pump set 196419-0		1	←	Oil pump complete 142156-4		1	046: AS-3726, AS-3731, DUC252, DUC302, XCU02 049: ES-164 TLC, ES-174 TLC, ES-2131 TLC, ES-2136, ES-2136 TLC, ES-2141, ES-2141 TLC, UC3050A, UC3051A, UC3550A, UC3550AP, UC3551A, UC4050A, UC4051A, UC4550A, UC4551A 075: ES-34 TLC, ES-39 TLC, ES-43 TLC, UC3041A, UC3541A, UC4041A

### Interchangeability mark;

The arrow ← means that the new part can be substituted for the current.