

T ECHNICAL INFORMATION



New Tool

Models No. ▶ HR2510

Description ▶ 25mm Rotary hammers

CONCEPTION AND MAIN APPLICATIONS

We developed a new Rotary hammers, based on HR2210 and HR2220, which is small,, Light, easy to operate for making holes and highly effective for working., hoping to Expand the market.

HR 2500 Single speed switch
HR 2510 Variable speed switch

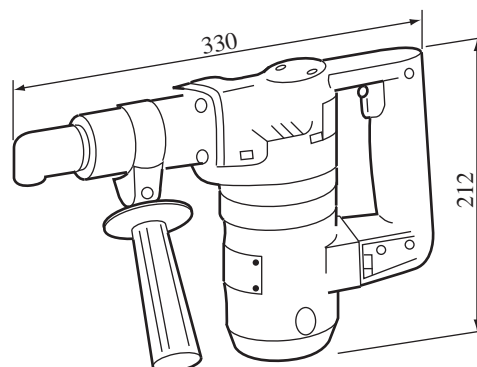

► Specifications

Voltage(V)	Current(A)	Cycle (Hz)	Continuousrating input		Max. output(W)
			Input(W)	Output(W)	
100	6.5	50/60	620	170	530

HR2500	No load speed(R.P.M.)	800
	Blows per minute(R.P.M.)	3000
HR2510	No load speed(R.P.M.)	0~800
	Blows per minute(R.P.M.)	0~3,000
Shank dia.		ø 10
Max. bit dia.(mm)		25
Net weight(kg)		4.2
Power supply cord(m)		5

► Standard equipment

T.C.T. drill bit 14.5-135
Hex. spanner 5
Grease for Bit(100g)
Stopper pawl
Spoid 64

► Optional accessories

Please reffer English general catalogue.

The standard equipment for the tools shown may differ form country to country.

► **Features and benefits**

1. Displays high capacity in upward operation.
2. As the complete grease pack system is applied, you can save time for refueling.
3. You can change by the change lever from [Rotation + Blow] to [only rotation].
4. T.C.T drill bit, Hilti type (for TEIZ and TEZZ, with a Red belt mark) Bosch SDS type (), are utilizable.
However, the bit cannot be attached to other maker's product.
5. Auto cut-off carbon brush is used on the machine and the motor will stop automatically when carbon worn-out.
6. If you change to [only rotation] and attach the special accessories, Chuck adaptor and Drill chuck 13, you can use it for steel (13mm) and wood (30mm) too.

► Repair

Disassembly

1. In replacement of armature, first remove Bearing Box, and take off Ballbearing 608LB on the end of Fan65 with two minus drivers as shown in the right illustration. Also remove Fan65 in the same way. You take off Pan-head small screws for handle and Hexagonal hole bolts, then you can take out Armature installed in Gear Housing. Finally, pull out Armature from Gear Housing by Hand Press.

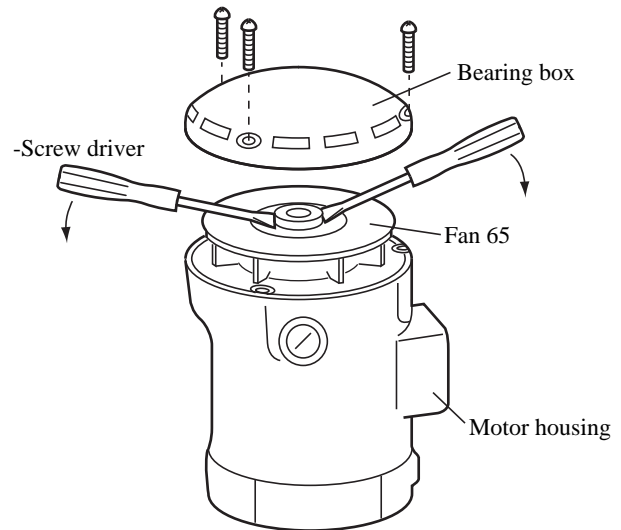

2. How to remove Helical Gear36 is the same way as the replacement of Armature; First, remove Ballbearing1507 by two minus drivers, and you will be able to pull out Helical Gear36 usually by hands. If it cannot be pulled out, You will be able to pull out in the same way as the above, by two minus drivers.

Assembly

1. Since the Grease sealed method is applied in the machine, assemble it after Applying very little grease on the Lips of O Ring and Oil Seal, etc. If the components in Housing are broken, be sure to clean up inside Housing .
2. Before assembly, impregnate Felt Ring20 with MAKITA Hammer Oil, and attach Felt Ring and Oil Seal after connecting Seal Holder with Chuck Assembly.

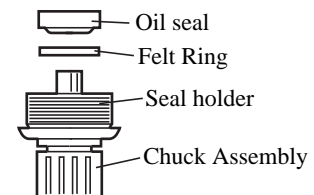

3. If you assemble after applying grease a little in Insert Hole , where Steel Ball is used, Steel Ball will not fall down.
4. Remove grease completely in the screw parts of Cylinder Liner and Round Nut M30.0-36, and apply adhesive to put in drying hearth or otherwise leave it as it is for natural dry.
5. Pour Adhesive(Super three bond No.50,No.0450079) into the groove for insereting O Ring on the end surface of Gear Housing without rifts, paying attention for overpouring.
6. As for the attachment of Ballbearing 6902 on the end surface of Helical Gear36, insert it into Clunk Shaft together with Housing, after inserting into Gear Housing.
7. In the fabrication of Barrel and Clunk Housing, attach the end part in advance of Barrel, and insert Rod, Pin6, Piston into Cylinder Liner about 15mm deep, being careful that Pin will not fall down. It is easy if you insert Rod into Clunk Shaft after that.



8. Standard fastening torque of Screw/Bolt

Seal holder-----	Barrel (left screw)	400-600 kgim
Cylinder liner24-----	Round nut M30.3-36	400-600
Clunk cap-----	Clunk housing	100-160
Barrel-----	Hexagon socket head bolt of Clunk housing(M6)	80-120
Motor housing-----	Hexagon socket head bolt of Clunk housing(M6)	40-60
Handle R/L-----	Pan-head small screw of Clunk housing(M6)	40-60
Handle R/L-----	Pan-head small screw of Clunk housing(M6)	40
Handle R -----	Pan-head small screw of Handle L(M5)	30
Bearing box-----	Pan-head small screw of Motor housing(M5)	30

Repairing Tools and Instruments

Hexagonal stick spanner 5	Lock nut wrench35
+ screw driver	Handpress
- screw driver 2pieces	Vice
Spanner 36	Measurer of torque
Spanner 30	