

T ECHNICAL INFORMATION



New Tool

Models No. ▶ HR3520

Description ▶ MAKITA Rotary hammer

CONCEPTION AND MAIN APPLICATIONS

HR3520 and HR3521 are remodeled from HR3510 and HR3511.

HR3520 and HR3521 operate as efficiently as HR3510 and HR3511.

The heat of outer drilling systems is restricted better than old models.

HR3520 is a double insulated machine,

and export HR3521 is a single insulated one.

HR3520 and HR3521 have the same structures, except that HR3521 has an earth wire.

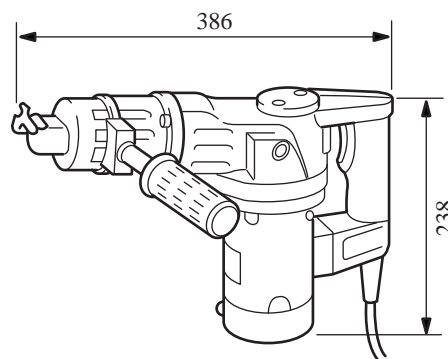

► Specifications

Voltage(V)	Current(A)	Cycle(Hz)	Continuous rating		Max. output(W)
			Input(W)	Output(W)	
100	11	50/60	1050	640	800
200	5.5	50/60	1050	640	800
115	7.7	50/60	840	500	800
200	4.4	50/60	840	500	800
220	4	50/60	840	500	800
240	5.7	50/60	840	500	800

the upper 2 lines : domestic specifications

the lower 4lines : export specifications

No load speed		440 /min
Blows per minute(/min)		3300 / min
Tool size		Hexagon shaft shank: 13mm
Maximum drilling capacity	T.C.T. bit	35mm
	Core bit	79mm
Net weight(kg)		6.4Kg
Power supply cord(m)		5m

► Standard equipment

Hexagon spanner 4, 5

Stopper pole

Syringe

► Optional accessories

Common to HR3511 and HR3510

But the core bits of export products are up to 79mm.

The standard equipment for the tools shown may differ form country to country

► **Features and benefits**

1. The cooling effects on the barrel and the crank housing have improved by changing the direction of the emission of cooling wind from downward to forward.
2. The side grip can be fit with the crank housing so that the operation may become easier when working downward
3. A switch for AC and DC use has been introduced. This switch will not make you feel that your hand gets tired even after using the drills for hours.
4. The other features are common to HR3511 and HR3510.

► Repair

1. Changing the armature

Remove the carbon brush first, then remove the motor housing. The armature can be removed from the gear housing with a hand press.

Confirm that no alien substances are adhered to the oil seal before fitting the armature with the gear housing.

2. Insert the oil seal about 0,5 mm deep from the end of the gear housing.

3. Thread fastening torque

Barrel	----- Tool holders	1400 to 1800kg.cm
Crank cap	----- Crank housing	100 to 160kg.cm
Crank housing	----- Hexagon socket head cap screw of the barrel (M6)	80 to 120kg.cm
Motor housing	----- Hexagon socket head cap screw of the crank housing (M6)	60 to 80kg.cm
Handle R,L	----- Hexagon socket head cap screw of the crank housing (M6)	60 to 80kg.cm
Handle R,L	----- Hexagon socket head cap screw of the motor housing (M6)	40kg.cm
Rear cover	----- Hexagon socket head cap screw of the motor housing (M5)	30kg.cm

4. The repair of the other parts follows that of HR3511 and HR3510.