

TECHNICAL INFORMATION



68117
(Page 1 of 2)

Subject ▶ Change of Blade Clamping System and Shoe

For Models ▶ JR140D, JR180D

Country ▶ All countries

Description ▶ See below.

1) The following changes have been implemented to make the tool-less blade change system more durable.

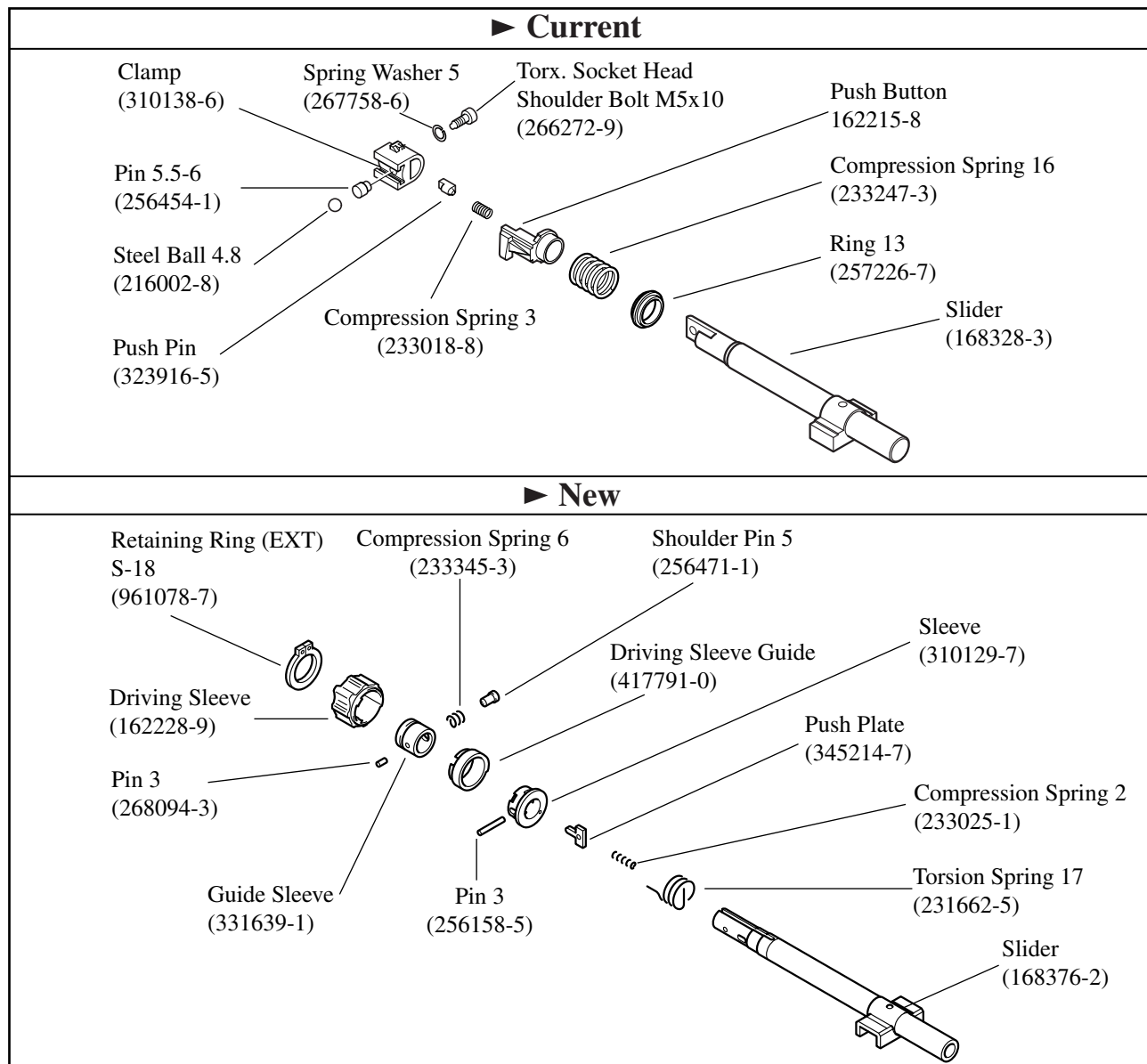

2) Shoe has been changed as shown below.

	▶ Current	▶ New
For European countries except U.K.	Shoe (168337-2)	Shoe (163441-2)
For the other countries	<div style="display: flex; flex-direction: column; align-items: center;"> </div>	<div style="display: flex; flex-direction: column; align-items: center;"> </div>

Item No.	Current part		Q'ty	I/C	New part		Q'ty	Note
014	Slider 168328-3		1	No	Slider 168376-2		1	Interchangeable as a set
011	Ring 13 257226-7		1					
010	Compression Spring 16 233247-3		1					
009	Compression Spring 3 233018-8		1					
008	Push Pin 323916-5		1					
007	Push Button 162215-8		1					
004	Pin 5.5-6 256454-1		1					
003	Steel Ball 4.8 216002-8		1					
006	Torx. S. H. Shoulder Bolt M5x10 266272-9		1					
082	Spring Washer 5 267758-6		1					
005	Clamp 310138-6		1					
088					Guide Sleeve 331639-1		1	
091					Sleeve 310129-7		1	
090					Pin 3 256158-5		1	
089					Driving Sleeve Guide 417791-0		1	
092					Push Plate 345214-7		1	
086					Driving Sleeve 162228-9		1	
087					Pin 3 268094-3		1	
083					Shoulder Pin 5 256471-1		1	
085					Retaining Ring (EXT) S-18 961078-7		1	
084					Compression Spring 6 233345-3		1	
093					Compression Spring 2 233025-1		1	
094					Torsion Spring 17 231662-5		1	
017	Shoe 168337-2		1	No	Shoe 163441-2		1	For Europe except U. K.
017	Shoe Plate 344801-9		1	No	Shoe 163442-0		1	For the other countries.
022	Shoe Supporter 344925-1		1					
021	Hex. Socket Head Bolt M5x50 266241-0		1					
019	Hex. Lock Nut M5-8 252103-8		1					
078	Spring Washer 5 942101-7		1					

Implementation

To be implemented from May,2003 production.