

T ECHNICAL INFORMATION

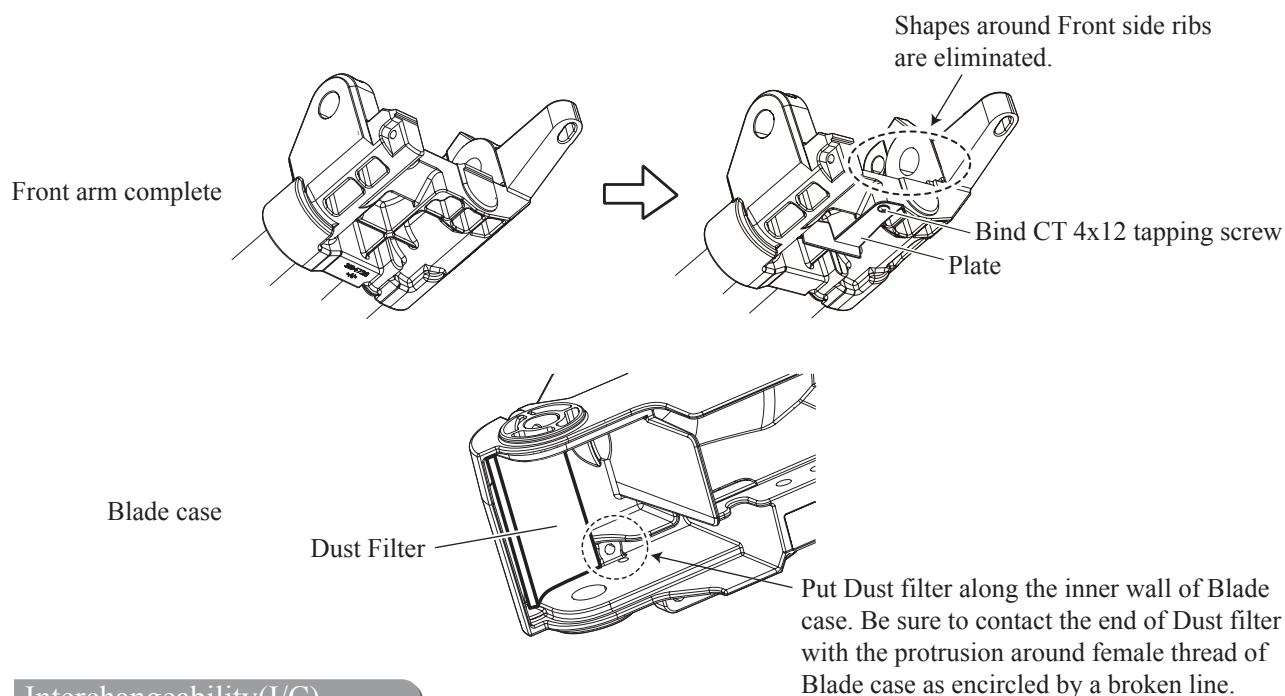

90111
August 2010

- Subject** ▶ Change of Front Arm Complete
Addition of Plate, Bind CT4x12 Tapping Screw and Dust Filter
- For Models** ▶ LS1216, LS1216F, LS1216FL, LS1216L
- Country** ▶ All countries
- Description** ▶ Front arm complete has been modified.
Plate, Bind CT4x12 tapping screw and Dust Filter have been added.
See shown below for the detail.



Interchangeability(I/C)

Item No.	Current part		Q'ty	I/C	New part		Q'ty	Note
157	Front Arm Complete 140711-6		1	←	Front Arm Complete 140976-0		1	Interchangeable as a set
LS1216, LS1216F: 278 LS1216FL, LS1216L: 280					Plate 346474-4		1	
LS1216, LS1216F: 279 LS1216FL, LS1216L: 281					Tapping Screw Bind CT 4x12 266026-4		1	
LS1216, LS1216F: 280 LS1216FL, LS1216L: 282					Dust Filter 424438-9		1	

Interchangeability mark;

The arrow ← means that the new part can be substituted for the current.

Implementation

MJ products (all models): From August 2010 production
MCA products (LS1216, LS1216L): From September 2010 production
MKC products (LS1216, LS1216L): Immediately upon completion of preparation
MME products (LS1216, LS1216L): From initial production