

T ECHNICAL INFORMATION



New Tool

Models No. ▶ UM 1270 DW

Description ▶ MAKITA Cordless grass trimmer

CONCEPT AND MAIN APPLICATIONS

Lawn mowing and weeds cutting becomes easy and the cross section of the cut weed is neat. This is a multi-purpose cordless lawn mower with nylon blade which offers an effective mowing near the fence and around the trees.

UM 1200D

For the time being, we treat UM1200D only. The charger(DC 7000)and the battery(battery7000) are to be sold separately.

UM1270DW

with built-in battery and battery charger

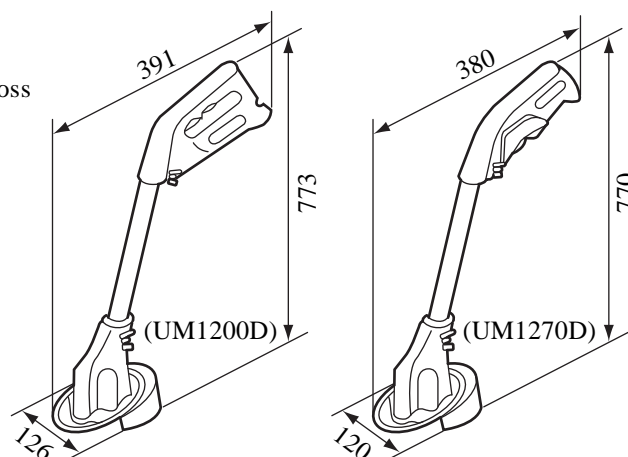

► Specifications

Motor		DC magnet motor
No Load Speed	Rotation per minute(/min.)	13,000/min.
Tool size(mm)		120 in lengthx18 in widthx2 in thickness
Function	Cutting width(mm)	120 mm
	UM1200D	1 hour's charging allows about 20minutes' continuous operation(35minutes'continuous operation with no load)
	UM1270D	3 hours' charging allows about 15minutes'continuous operation(25minutes'continuous operation with no load)
Net Weight(kg)	UM1200D	1.0 kg
	UM1270D	0.8 kg

► Standard equipment

Blade---10 sheets

► Optional accessories

Blade---20 sheets

Battery 7000(for UM 1200D)

► Features and benefits

1. Cutting near the fence is easy thanks to the nylon blade.
2. This tool cuts better than with nylon threads and safer than with metallic blade.
3. Replacement of the blade can be made easily without using any tool.
4. Light weight allows single hand operation and the compact size of the body makes it possible to cut in a narrow place.
5. Unintentional activation of the switch can be prevented thanks to lock off lever.
6. The battery is of cartridge type(UM1200D only)

The standard equipment for the tools shown may differ form country to country

► Capacity

Cutting capacity by one charging

UM1200D

Cutting of about 16m² of grass of about 50mm of length

UM1270D

Cutting of about 12m² of grass of about 50mm of length

► Repair

1. How to take off the safety cover

Insert a flat driver in the slit at the rear part of the motor housing and depress the nail of the safety cover and pull out the safety cover(see fig.1)

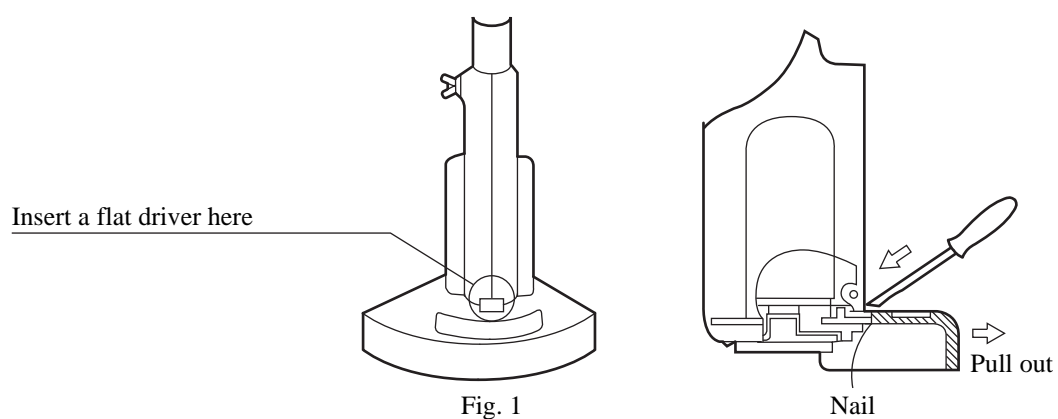

2. Replacement of the blade holder

For fitting of the blade holder, press the motor shaft until the clearance between the end face of the blade holder and the frontal face of the motor is 1.5mm-2.0mm.(see the Fig.2)

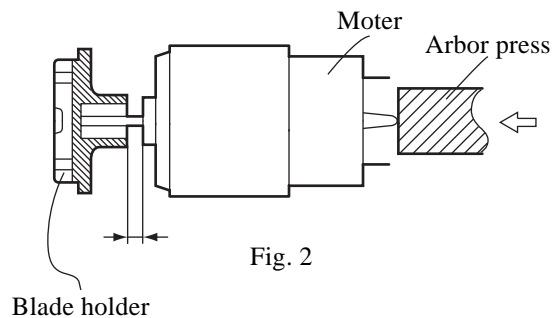

3. Fixation of the screw

The screw is a tapping screw. Excessive tightening should be avoided.

4. Precaution in wiring(UM1270D)

Attention should be paid to a possible danger of short circuit of battery when there is a contact between the battery and the inlet or the switch.

5. Necessary tools for repair

Flat driver — for removal of the safety cover

Cross driver — for disassembly and assembly of the housing

Soldering iron — for wiring

Arbor press-for replacement of the blade holder